

ROUTE NO.	SECTION	COUNTY	TOTAL SHEETS	SHEET NO.
2732	09-00124-00-RS	COOK	22	1

ILLINOIS PROJECT ARA-9003 (302)  
CONTRACT NO. 63296



LOCATION OF SECTION INDICATED THIS: [Symbol]

**STATE OF ILLINOIS**  
**DEPARTMENT OF TRANSPORTATION**  
**DIVISION OF HIGHWAYS**  
**PLANS FOR PROPOSED**  
**FEDERAL AID HIGHWAY**  
**LOCAL AGENCY PAVEMENT PRESERVATION (LAPP)**  
**FAU ROUTE 2732 (PRAIRIE AVENUE)**  
**47th STREET TO BURLINGTON AVENUE**  
**SECTION NO. 09-00124-00-RS**  
**PROJECT ARA-9003 (302)**  
**VILLAGE OF BROOKFIELD**  
**COOK COUNTY**  
**JOB NO. C-91-578-09**

INDEX OF SHEETS ON SHEET NO. 2

**TRAFFIC DATA**

2030 ADT = 8,500  
 POSTED SPEED LIMIT: 25 MPH  
 DESIGN SPEED: 30 MPH

**DESIGN DESIGNATION**

COLLECTOR

PROJECT LOCATED IN THE VILLAGE OF BROOKFIELD

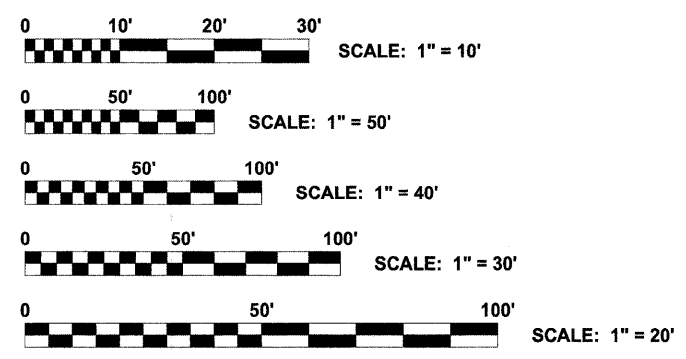

FULL SIZE PLANS HAVE BEEN PREPARED USING STANDARD ENGINEERING SCALES. REDUCED SIZED PLANS WILL NOT CONFORM TO STANDARD SCALES. IN MAKING MEASUREMENTS ON REDUCED PLANS, THE ABOVE SCALES MAY BE USED.

**LOCATION MAP**

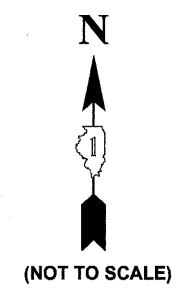
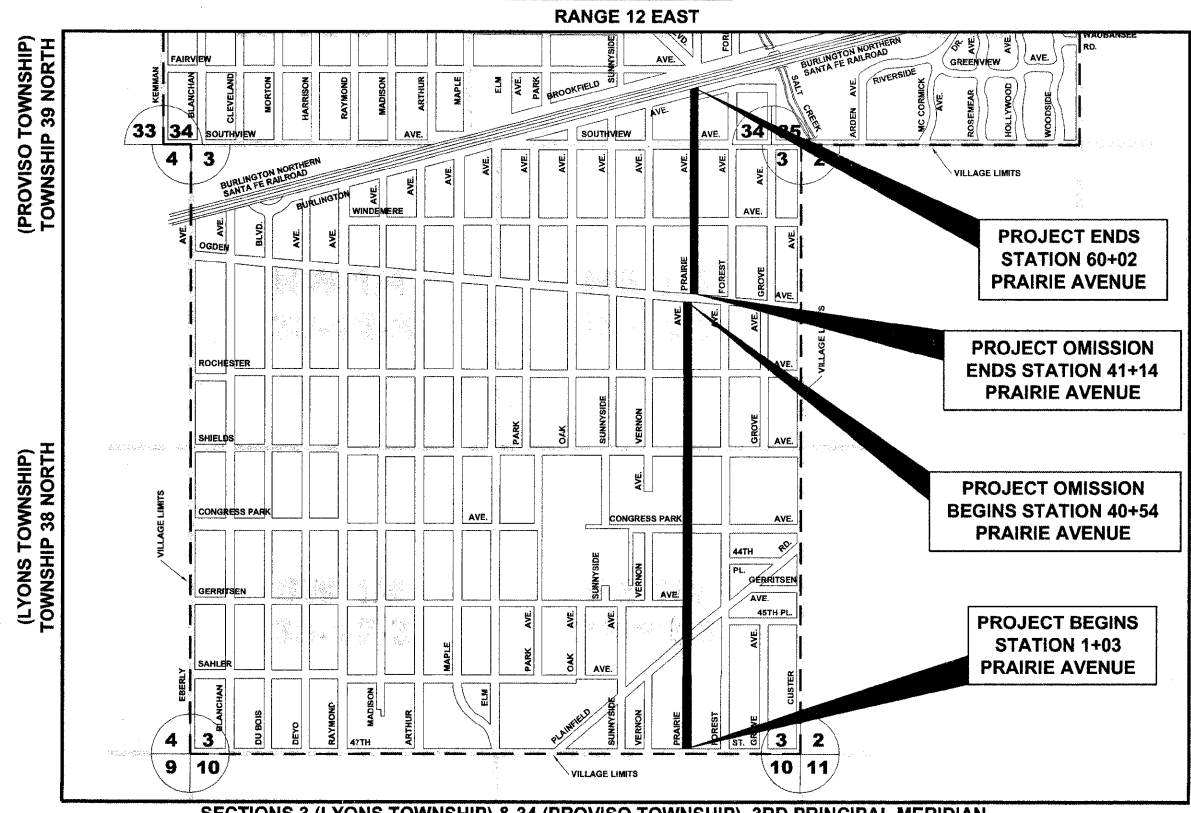

SECTIONS 3 (LYONS TOWNSHIP) & 34 (PROVISO TOWNSHIP), 3RD PRINCIPAL MERIDIAN

■ - AREA OF IMPROVEMENT

GROSS LENGTH OF IMPROVEMENT = 5,899 FT = 1.117 MI  
 NET LENGTH OF IMPROVEMENT = 5,839 FT = 1.106 MI

**STATE OF ILLINOIS**  
**ILLINOIS DEPARTMENT OF TRANSPORTATION**  
**DIVISION OF HIGHWAYS**

APPROVED August 17 2009  
*Michael Hayes*  
 VILLAGE OF BROOKFIELD, PRESIDENT

PASSED August 31 2009  
*Cheryl C. Heston*  
 DISTRICT 1 ENGINEER OF LOCAL ROADS & STREETS

RELEASED FOR BID BASED ON LIMITED REVIEW SEPTEMBER 1 2009  
*Diana M. O'Keefe*  
 DEPUTY DIRECTOR OF HIGHWAYS,  
 REGION 1 ENGINEER

(PRINTED BY AUTHORITY OF THE STATE OF ILLINOIS)



DATE SIGNED: 08-17-09  
 LICENSE EXPIRES: 11-30-09

EDWIN HANCOCK ENGINEERING COMPANY  
 9933 ROOSEVELT ROAD PHONE: (708) 865-0300  
 WESTCHESTER, ILLINOIS 60154



**Know what's below.**  
**Call before you dig.**

CONTRACT NO. 63296

FIELD ENGINEER: MARILYN SOLOMON, (847)705-4407  
 Drawing file: W:\Projects\12509095 - Prairie Ave LAPP\COVER.dwg Aug 17, 2009 - 1:32pm