

DATE	BY
REVISIONS	PLANNED
NOTES	CHECKED
NO.	NO.
FILE NAME	FILE NAME

DATE	BY
REVISIONS	PLANNED
NOTES	CHECKED
NO.	NO.
FILE NAME	FILE NAME

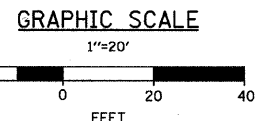
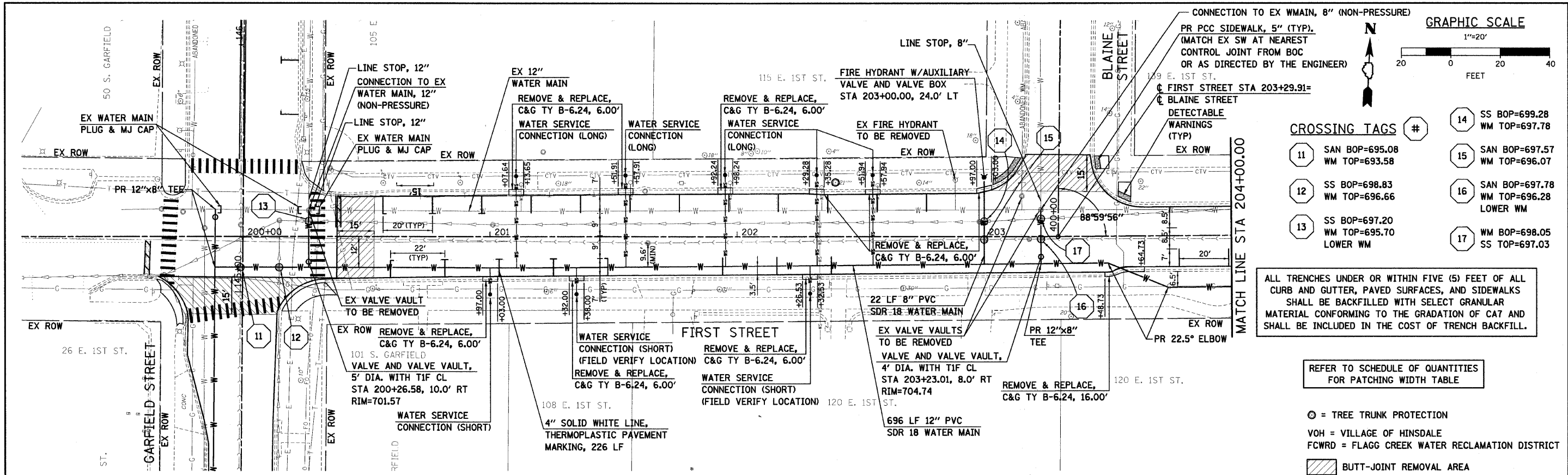

CROSSING TAGS

11	SAN BOP=695.08 WM TOP=693.58	14	SS BOP=699.28 WM TOP=697.78
12	SS BOP=698.83 WM TOP=696.66	15	SAN BOP=697.57 WM TOP=696.07
13	SS BOP=697.20 WM TOP=695.70 LOWER WM	16	SAN BOP=697.78 WM TOP=696.28 LOWER WM
		17	WM BOP=698.05 SS TOP=697.03

ALL TRENCHES UNDER OR WITHIN FIVE (5) FEET OF ALL CURB AND GUTTER, PAVED SURFACES, AND SIDEWALKS SHALL BE BACKFILLED WITH SELECT GRANULAR MATERIAL CONFORMING TO THE GRADATION OF CA7 AND SHALL BE INCLUDED IN THE COST OF TRENCH BACKFILL.

REFER TO SCHEDULE OF QUANTITIES FOR PATCHING WIDTH TABLE

- ⊙ = TREE TRUNK PROTECTION
- VOH = VILLAGE OF HINSDALE
- FCWRD = FLAGG CREEK WATER RECLAMATION DISTRICT
- ▨ BUTT-JOINT REMOVAL AREA

