

# STAGING TYPICAL SECTIONS

STAGING TYPICALS FOR  
I-74 SN 037-0015 & 0016

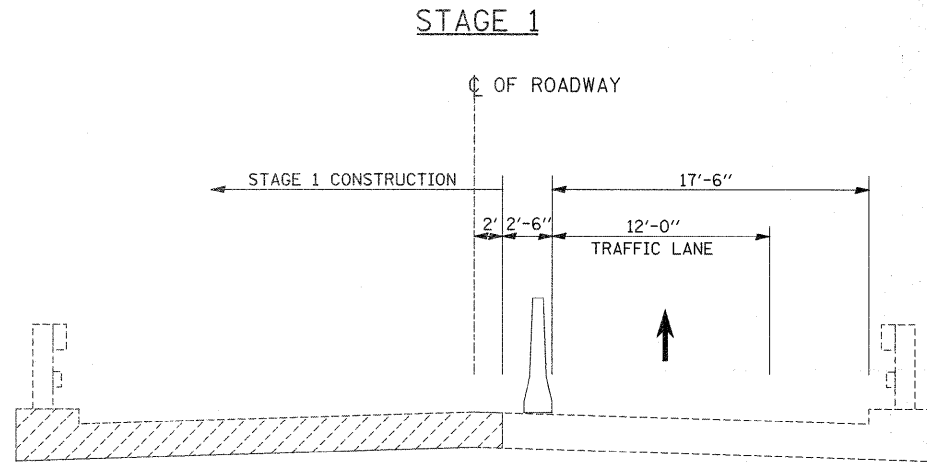

STAGING TYPICALS FOR  
I-74 SN 037-0017

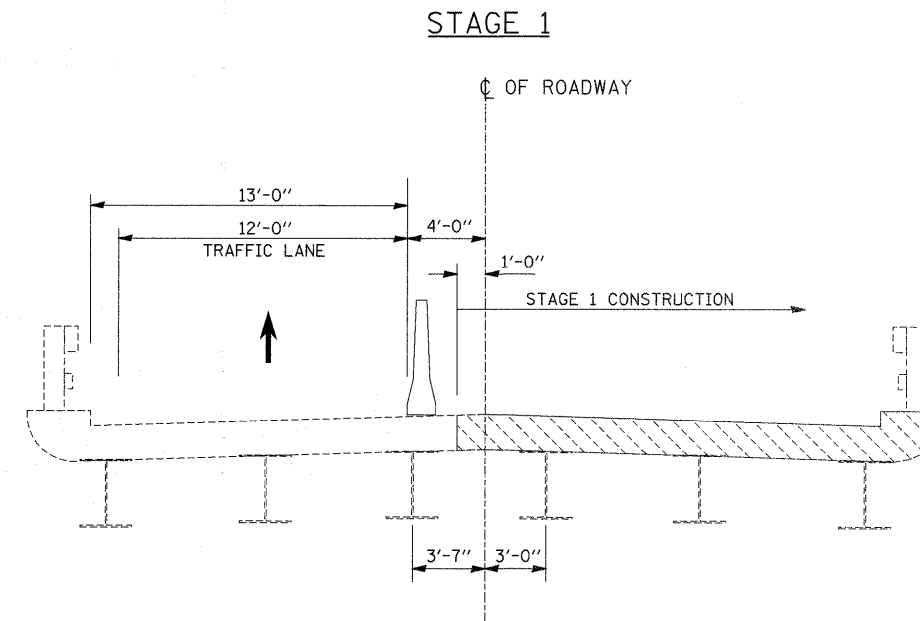

STAGE 2

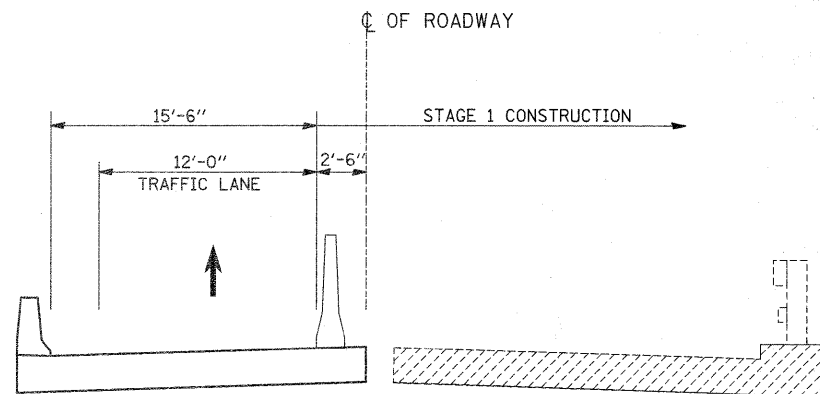

STAGE 2

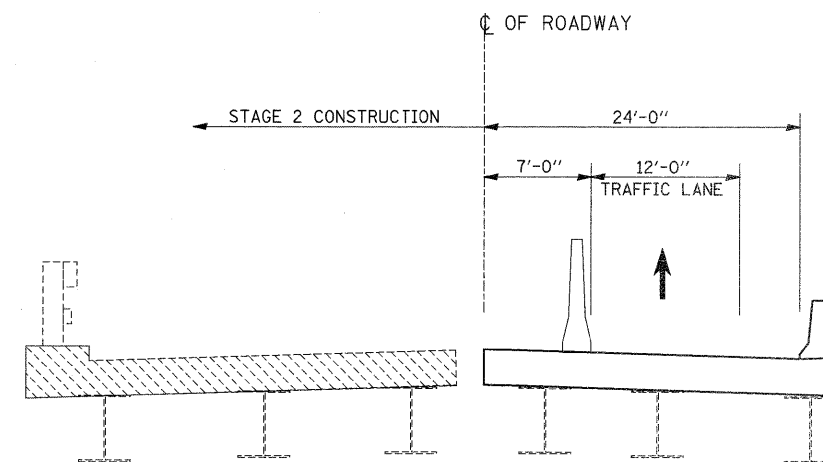

NOTES: (FOR SN 037-0015 & 0016)

HATCH AREAS INDICATE REMOVAL OF EXISTING CONCRETE DECK.  
FOR QUANTITY OF TEMPORARY CONCRETE BARRIER, SEE ROADWAY  
PLANS. ALL TYPICAL SECTIONS ARE LOOKING SOUTH FOR  
SOUTH BOUND STRUCTURE AND LOOKING NORTH FOR NORTH BOUND STRUCTURE.

NOTES: (FOR STRUCTURE 037-0017)

ALL STAGING TYPICALS ARE LOOKING SOUTH.

FOR QUANTITY OF TEMPORARY CONCRETE BARRIER, SEE ROADWAY  
PLANS.

HATCH AREA INDICATES REMOVAL OF EXISTING STRUCTURES.  
COST OF REMOVAL OF EXISTING STEEL RAILING AND BITUMINOUS  
OVERLAY IS INCLUDED IN REMOVAL OF EXISTING CONCRETE DECK.

FILE NAME =	USER NAME = cushmanbw	DESIGNED -	REVISED -	<b>STATE OF ILLINOIS DEPARTMENT OF TRANSPORTATION</b>	<b>STAGING TYPICAL SECTIONS</b>				F.A.T. RTE.	SECTION	COUNTY	TOTAL SHEETS	SHEET NO.
cs:\pw_work\pki\dos\cushmanbw\dna35777\08298.tpd.dgn	PLOT SCALE = 1/8" = 1' IN.	DRAWN -	REVISED -						74	37-(4HB,4HB-1,4HB-2)D	HENRY	148	8
	PLOT DATE = Wed Aug 05 13:16:09 2009	CHECKED -	REVISED -		SCALE: SHEET NO. OF SHEETS STA. TO STA.				CONTRACT NO. 64264				
		DATE -	REVISED -		FED. ROAD DIST. NO. ILLINOIS FED. AID PROJECT								