

NOTES:
 1. VERIZON FIBEROPTIC AND 150 PAIR COPPER LINES ARE BURIED WITHIN THE SOUTH R.O.W. OF US RTE. 20.
 2. HMA SHOULDER FROM STA. 554+00 TO 576+50 RT SHALL BE CONSTRUCTED WITH 2" OF EXTRA ASPHALT THICKNESS TO ACCOMODATE STAGE TRAFFIC.

EXIST. CURVE A05700200
 PI STA. = 581+68.16
 $\Delta = 10^\circ 29' 01''$ (RT)
 $D = 0^\circ 52' 34''$
 $R = 6,540.11'$
 $T = 600.00'$
 $L = 1,196.65'$
 $E = 27.46'$
 $e = 2.4\%$
 $T.R. = 45'$ (PC), $55'$ (PT)
 $S.E. RUN = 65'$ (PC), $80'$ (PT)
 $F.S. = STA. 575+90$ TO $STA. 587+39$
 $P.C. STA. = 575+68.16$
 $P.T. STA. = 587+64.91$

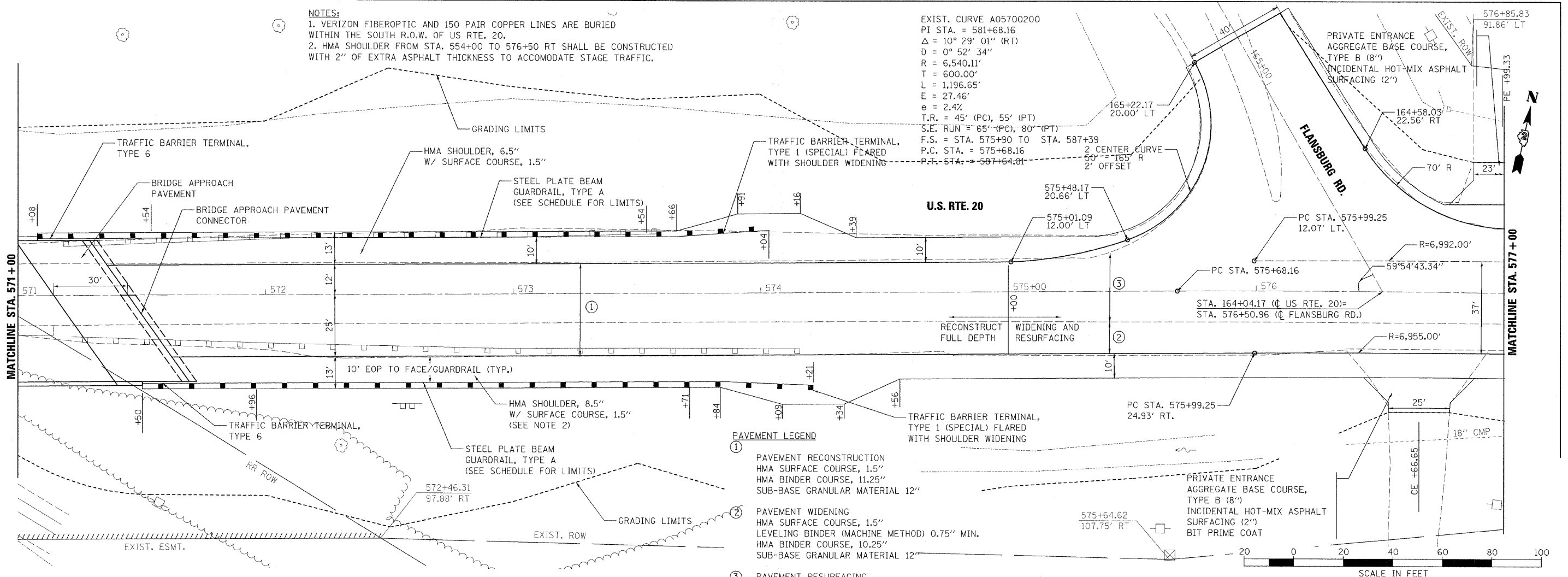

- PAVEMENT LEGEND**
- ① PAVEMENT RECONSTRUCTION
 HMA SURFACE COURSE, 1.5"
 HMA BINDER COURSE, 11.25"
 SUB-BASE GRANULAR MATERIAL 12"
 - ② PAVEMENT WIDENING
 HMA SURFACE COURSE, 1.5"
 LEVELING BINDER (MACHINE METHOD) 0.75" MIN.
 HMA BINDER COURSE, 10.25"
 SUB-BASE GRANULAR MATERIAL 12"
 - ③ PAVEMENT RESURFACING
 HMA SURFACE COURSE, 1.5"
 LEVELING BINDER (MACHINE METHOD) 0.75" MIN.

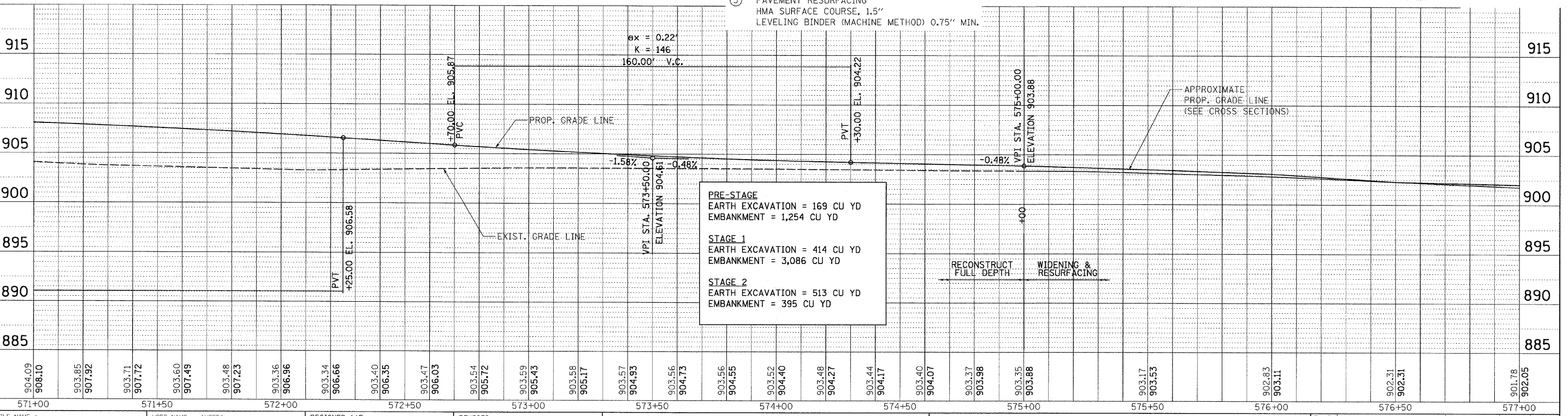

**STATE OF ILLINOIS
 DEPARTMENT OF TRANSPORTATION**

**US ROUTE 20
 PROPOSED ROADWAY PLAN & PROFILE**

F.A.P. RTE. 301	SECTION 21 VBR	COUNTY STEPHENSON	TOTAL SHEETS 112	SHEET NO. 28
CONTRACT NO. 64D15			FED. ROAD DIST. NO. [ILLINOIS] FED. AID PROJECT	

PLAN

DATE	BY
REVISION	BY
APPROVED	DATE
NOTE BOOK	NO.
CADD FILE NAME	

PROFILE

DATE	BY
REVISION	BY
APPROVED	DATE
NOTE BOOK	NO.
CADD FILE NAME	

HOE
 MARY B. HOFFMAN-ASSOCIATES, INC.
 CIVIL ENGINEERING
 2945
 815 East Jackson Blvd.
 Chicago, IL 60604
 312-353-4311

FILE NAME = H:\PROJECTS\2545\DCNS\205507\205507PLN4.dgn	USER NAME = #USER#	DESIGNED AAF	REVISED -
PLOT SCALE = 20,000 / IN.	CHECKED BAP	DRAWN AAF	REVISED -
PLOT DATE = 8/7/2009	DATE = 8/7/2009	REVISIONS	REVISED -