

EXIST. CURVE A05700200
 PI STA. = 581+68.16
 $\Delta = 10^\circ 29' 01''$ (RT)
 $D = 0^\circ 52' 34''$
 $R = 6,540.11'$
 $T = 600.00'$
 $L = 1,196.65'$
 $e = 27.46'$
 $T.R. = 45'$ (PC), $55'$ (PT)
 $S.E. RUN = 65'$ (PC), $80'$ (PT)
 $F.S. = STA. 575+90$ TO $STA. 587+39$
 $P.C. STA. = 575+68.16$
 $P.T. STA. = 587+64.81$

NOTES:
 1. VERIZON FIBEROPTIC AND 150 PAIR COPPER LINES ARE BURIED WITHIN THE SOUTH R.O.W. OF US RTE. 20.
 2. FOR EOP ELEVATIONS IN SE SECTION, SEE CROSS SECTIONS.

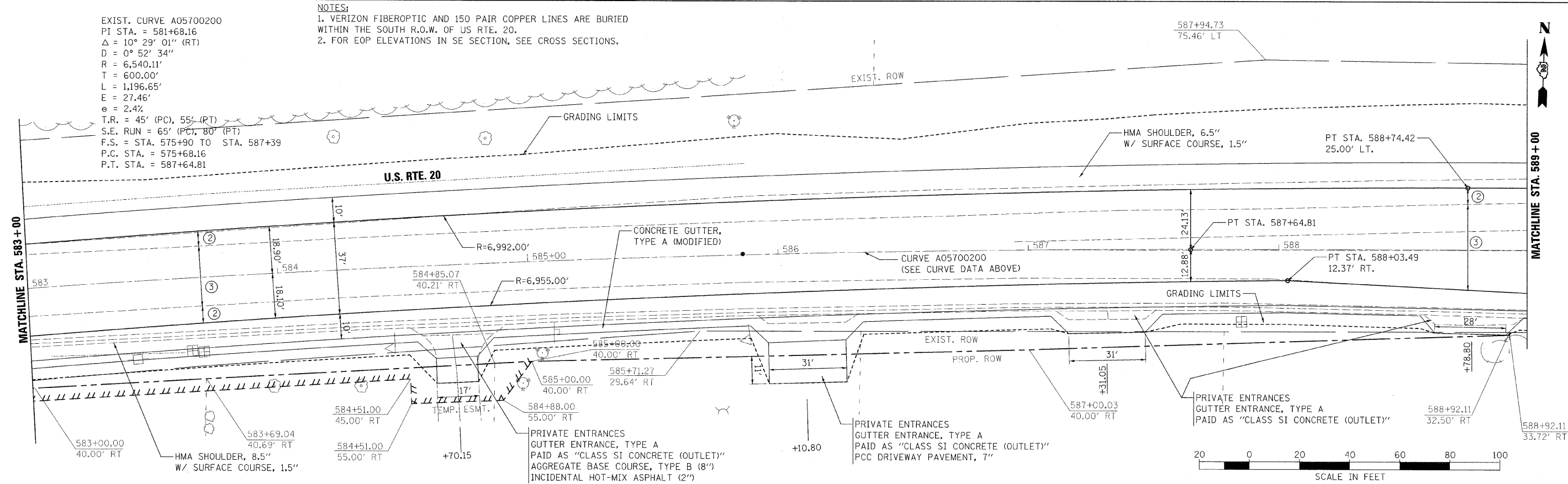

DATE	
BY	
REVISIONS	
NO.	
DATE	
BY	
REVISIONS	
NO.	

DATE	
BY	
REVISIONS	
NO.	
DATE	
BY	
REVISIONS	
NO.	

PROJECT NUMBER: 2945
 DATE: 8/7/2009
 DRAWN BY: AAF
 CHECKED BY: BAP
 DATE: 8/7/2009

PRE-STAGE
 EARTH EXCAVATION = 280 CU YD
 EMBANKMENT = 61 CU YD

STAGE 1
 EARTH EXCAVATION = 425 CU YD
 EMBANKMENT = 0 CU YD

STAGE 2
 EARTH EXCAVATION = 264 CU YD
 EMBANKMENT = 324 CU YD

PAVEMENT LEGEND

② PAVEMENT WIDENING
 HMA SURFACE COURSE, 1.5"
 LEVELING BINDER (MACHINE METHOD) 0.75" MIN.
 HMA BINDER COURSE, 10.25"
 SUB-BASE GRANULAR MATERIAL 12"

③ PAVEMENT RESURFACING
 HMA SURFACE COURSE, 1.5"
 LEVELING BINDER (MACHINE METHOD) 0.75" MIN.

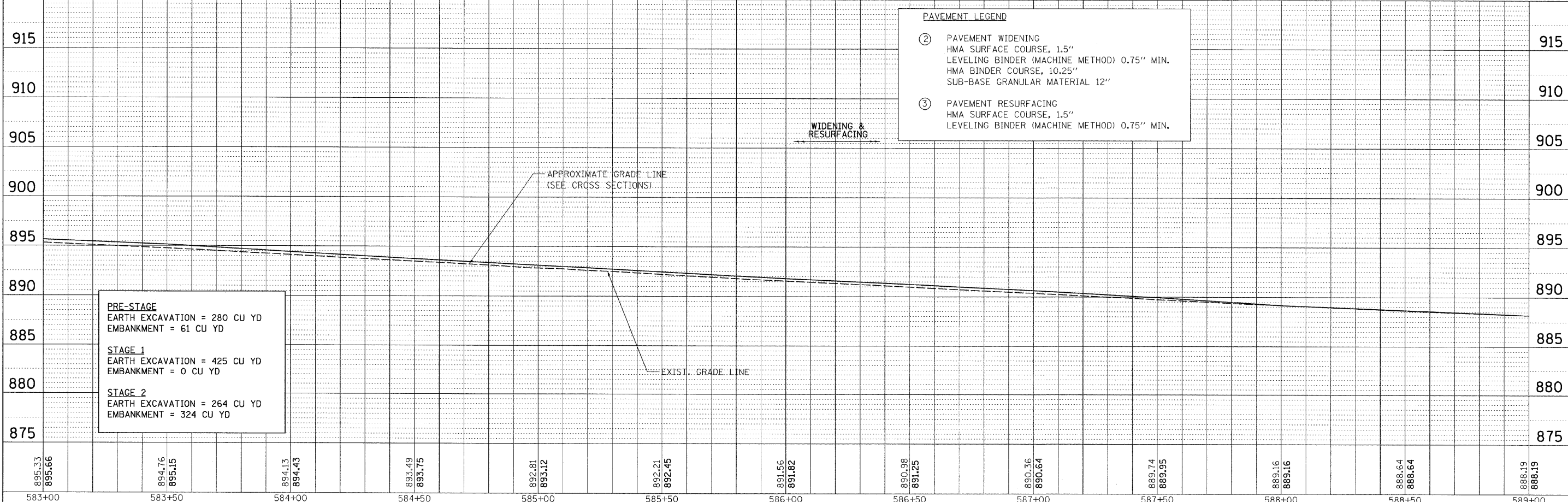

FILE NAME = H:\PROJECTS\2945\DDNS\09205587\205587P16.dgn	USER NAME = #USER9	DESIGNED AAF	REVISED -
PLOT SCALE = 20.0000' / IN.	CHECKED BAP	DRAWN AAF	REVISED -
PLOT DATE = 8/7/2009	DATE = 8/7/2009	REVISIONS	REVISED -

STATE OF ILLINOIS
 DEPARTMENT OF TRANSPORTATION

US ROUTE 20
 PROPOSED ROADWAY PLAN & PROFILE

F.A.P. RTE. 301	SECTION 21 VBR	COUNTY STEPHENSON	TOTAL SHEETS 112	SHEET NO. 30
FED. ROAD DIST. NO. [ILLINOIS] FED. AID PROJECT			CONTRACT NO. 64D15	