

DATE	
BY	
SURVEYED	
ALIGNED	
CHECKED	
PAID	
FILE NAME	
NO.	
PLAN	
NOTE BOOK	
NO.	

DATE	
BY	
SURVEYED	
GRADES CHECKED	
NOTE BOOK	
NO.	
PROFILE	
STRUCTURE NOTATIONS CHECKED	

HOH
 HARRY & HERRL-ASSOCIATES, INC.
 18 East Jackson Blvd.
 Suite 1000
 Chicago, IL 60604
 312-367-8771

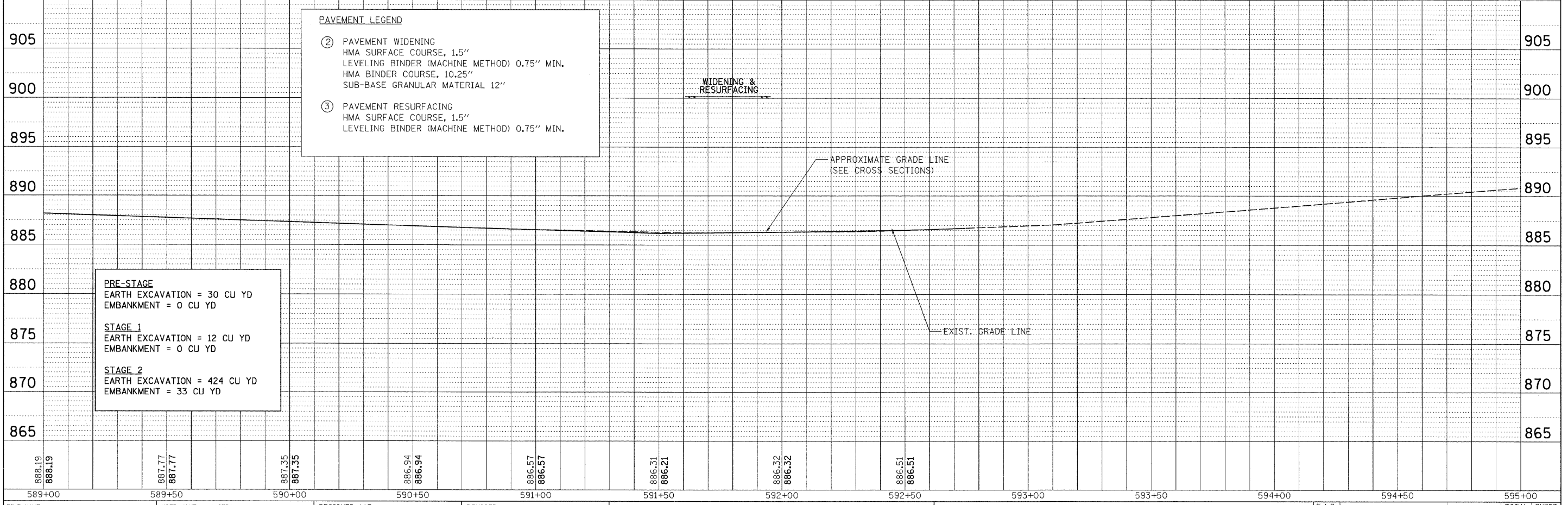
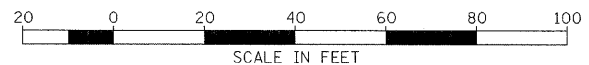
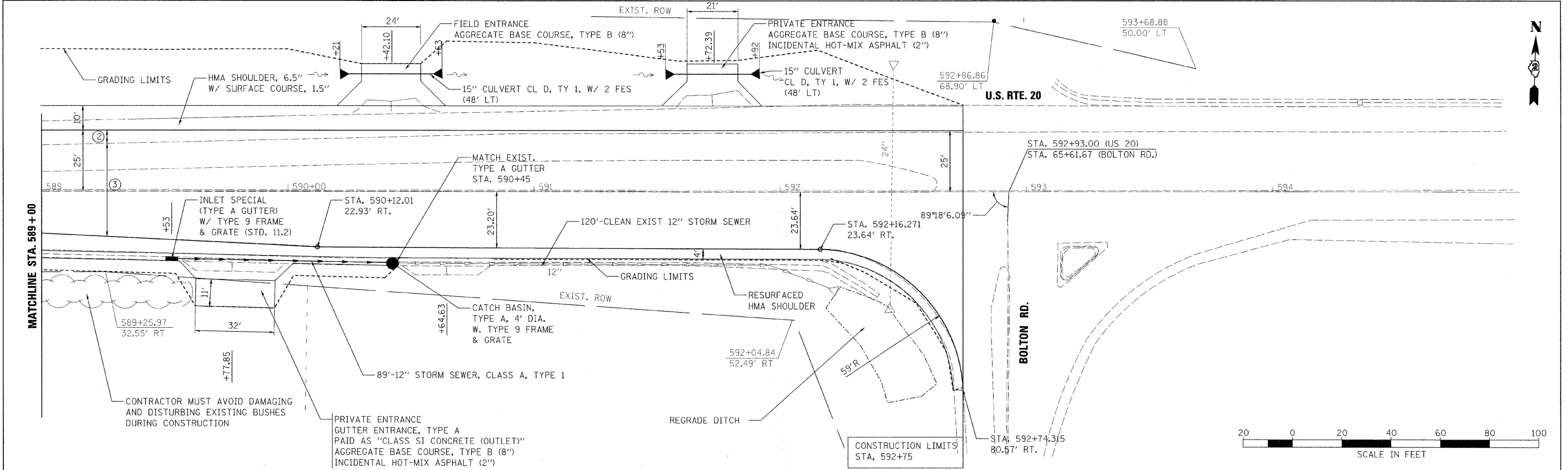

FILE NAME = H:\PROJECTS\2945\DGNS\09205507\205507PLN7.dgn	USER NAME = #USER#	DESIGNED AAF	REVISED -	STATE OF ILLINOIS DEPARTMENT OF TRANSPORTATION	US ROUTE 20 PROPOSED ROADWAY PLAN & PROFILE	F.A.P. RTE. 301	SECTION 21 VBR	COUNTY STEPHENSON	TOTAL SHEETS 112	SHEET NO. 31
PLOT SCALE = 28.0000' / IN.	CHECKED BAP	REVISED -	SCALE: 1"=40' (H), 1"=4' (V)			SHEET NO. 7 OF 9 SHEETS	STA. 589+00 TO STA. 595+00	FED. ROAD DIST. NO.	ILLINOIS FED. AID PROJECT	CONTRACT NO. 64D15
PLOT DATE = 8/7/2009	DATE - 8/7/2009	REVISED -								