

STAGE I

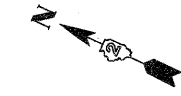

(COST TO BE INCLUDED IN TRAFFIC CONTROL & PROTECTION STD. 701401)

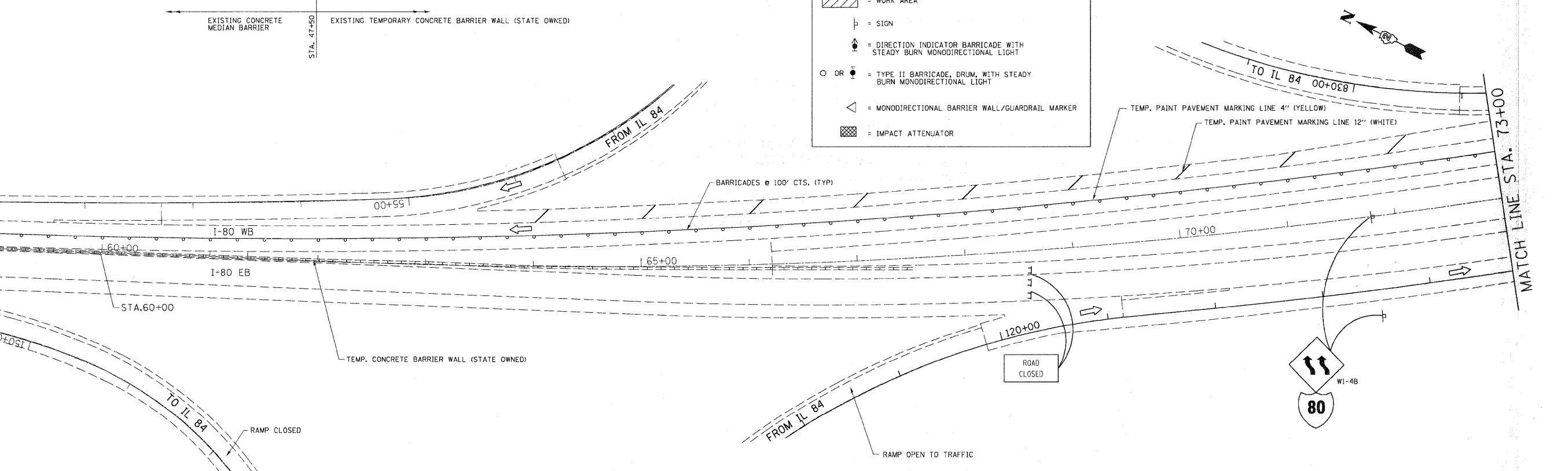
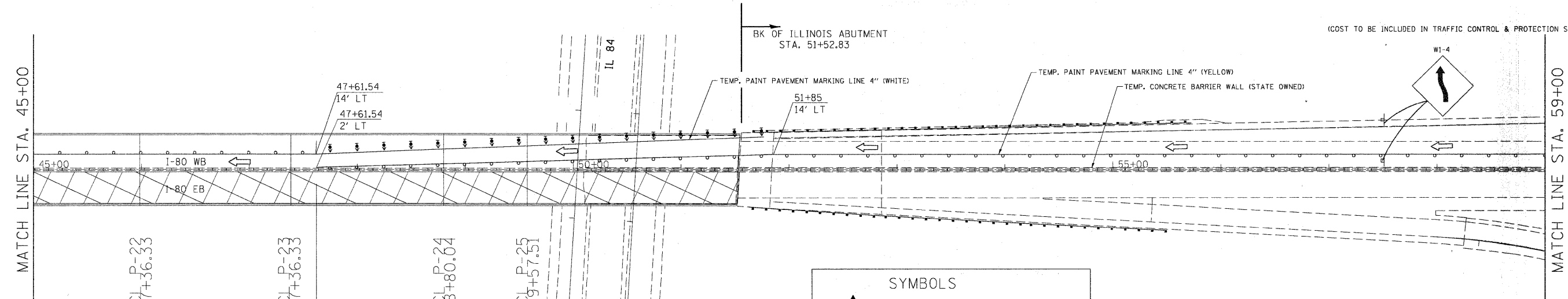

SYMBOLS

- = ARROW BOARD
- = WORK AREA
- = SIGN
- = DIRECTION INDICATOR BARRICADE WITH STEADY BURN MONODIRECTIONAL LIGHT
- = TYPE II BARRICADE, DRUM, WITH STEADY BURN MONODIRECTIONAL LIGHT
- = MONODIRECTIONAL BARRIER WALL/GUARDRAIL MARKER
- = IMPACT ATTENUATOR

STAGE I NOTE:

TRAFFIC CONTROL SHOWN SHALL BE PAID FOR AS HIGHWAY STD. 701401 UNLESS NOTED OTHERWISE.
 WESTBOUND TRAFFIC SHALL BE IN PASSING LANE ONLY BETWEEN STA. 21+00 TO STA. 47+50

REVISIED SHEET 10/28/09

| | | | | | | | | | | | | | | | |
|---|--------------------------------------|------------|-----------|---|----------------|-----------|----|-------------|---------|---------|--------------|-------------|---|----|----|
| FILE NAME = | USER NAME = cushmanbw | DESIGNED - | REVISED - | STATE OF ILLINOIS DEPARTMENT OF TRANSPORTATION | STAGE I | | | F.A.I. RTE. | SECTION | COUNTY | TOTAL SHEETS | SHEET NO. | | | |
| of:\pwork\pwork\cushmanbw\d0149186\d0149186.dwg | 409atg-A.dgn | DRAWN - | REVISED - | | SCALE: | SHEET NO. | OF | SHEETS | STA. | TO STA. | 80 | (81-1B) M-4 | ROCK ISLAND | 75 | 17 |
| | PLOT SCALE = 50,000' / IN. | CHECKED - | REVISED - | | | | | | | | | | CONTRACT NO. 64F31 | | |
| | PLOT DATE = Tue Oct 20 18:50:00 2009 | DATE - | REVISED - | | | | | | | | | | FED. ROAD DIST. NO. ILLINOIS FED. AID PROJECT | | |