

TRAFFIC CONTROL TYPICAL WEAVE

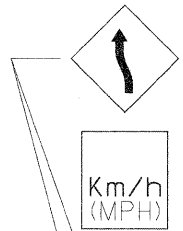

W1-4L(0)-48

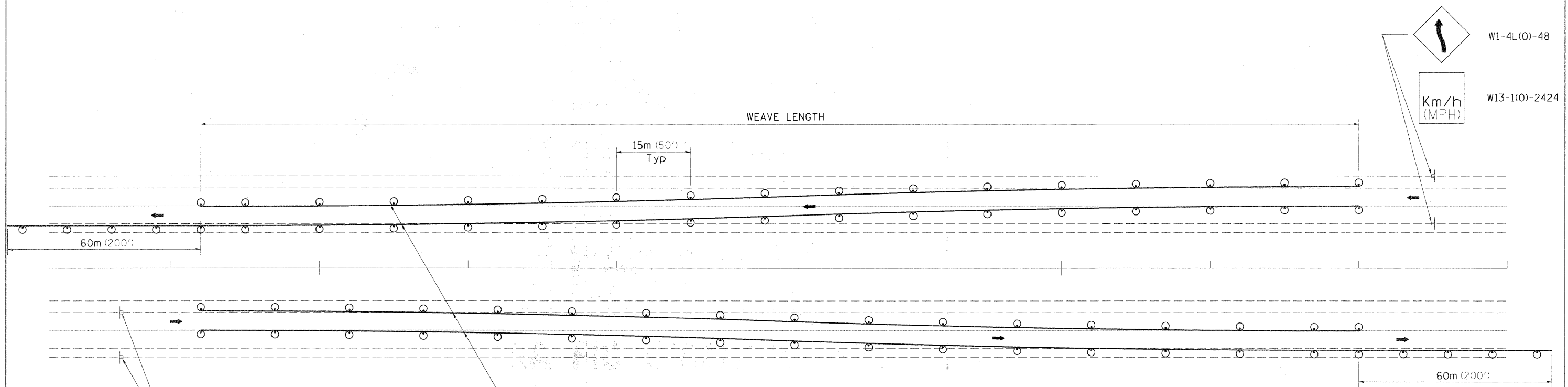

W13-1(0)-2424



W1-4R(0)-48

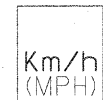

W13-1(0)-2424

Temporary Pavement Marking required if Typical Weave is used for 14 days or more.

LEGEND

- ⊙ DRUM WITH STEADY BURN MONO-DIRECTIONAL LIGHTS
- ⊞ SIGN ON PERMANENT MOUNT

DESIGNER NOTE:

1. USE ON LONG 4-LANE PROJECTS WHERE THE CONTRACTOR MAY CHANGE A PORTION OF THE WORK TO THE OPPOSITE LANE.
2. USE WHERE THE PROJECT IS ADJACENT TO ANOTHER AND THE CONTRACTOR COULD BE WORKING ON DIFFERENT LANES.
3. TEMPORARY PAVEMENT MARKING SHALL BE USED WHEN TYPICAL WEAVE IS USED FOR 14 DAYS OR MORE.
4. TRAFFIC CONTROL TYPICAL WEAVE SHALL BE INCLUDED IN THE COST OF THE SPECIFIC TRAFFIC CONTROL STANDARDS OF ITEMS.

STANDARD WEAVE CONDITIONS FOR DIFFERENT SPEED LIMITS

POSTED SPEED LIMIT	ADVISORY SPEED LIMIT	WEAVE LENGTH
110 Km/h (65 MPH)	80 Km/h (45 MPH)	240m (780 FT.)
90 Km/h (55 MPH)	60 Km/h (35 MPH)	200m (660 FT.)
80 Km/h (45 MPH)	40 Km/h (25 MPH)	165m (540 FT.)

ALL DIMENSIONS ARE IN MILLIMETERS (INCHES) UNLESS OTHERWISE NOTED.

FILE NAME =	USER NAME = cushmanbw	DESIGNED -	REVISED - 5-30-91	STATE OF ILLINOIS DEPARTMENT OF TRANSPORTATION	REGION 2 / DISTRICT 2 STANDARD				F.A.I. RTE.	SECTION	COUNTY	TOTAL SHEETS	SHEET NO.	
ca:\pw\work\pwsdot\cushmanbw\d0149192\d0149192.dgn		DRAWN -	REVISED -		SCALE:	SHEET NO.	OF	SHEETS	STA.	TO STA.	80	(81-1B) M-4	ROCK ISLAND	75 71
		CHECKED -	REVISED -						CONTRACT NO. 64F31					
		DATE -	REVISED -						ILLINOIS FED. AID PROJECT					