

STATE OF ILLINOIS
DEPARTMENT OF TRANSPORTATION

ROUTE NO.	SECTION	COUNTY	SHEET NO.	SHEET NO.
F.A.P. 311	*	LaSalle	66	36
FED. ROAD DIST. NO. 7		ILLINOIS	FED. AID PROJECT	

*(3)BR-1,2,3 & (4)BR Contract #66741

NOTES

- ① 13-#6 a_{31} bars @ 6 $\frac{1}{2}$ " cts.
(Bottom of Top Slab & Top of Bottom Slab)
4-#4 a_{32} bars @ 2'-0" cts.
(Bottom of Bottom Slab)
- ② **8-#6 a_{31} bars @ 6 $\frac{1}{2}$ " cts.
(Bottom of Top Slab & Top of Bottom Slab)
**3-#4 a_{32} bars @ 2'-0" cts.
(Bottom of Bottom Slab)
- ③ *8-#5 h_{32} bars @ 12" cts.
(Bottom of Top Slab)
*7-#4 h_{33} bars @ 14" cts.
(Top of Bottom Slab & Bottom of Bottom Slab)
- ④ 6-#5 h_{34} bars @ 12" cts.
(Short Wall)
6-#5 h_{35} bars @ 12" cts.
(Long Wall)

* Cut bar, see Cut Diagrams on Sheet 3

** a bars in skew portion of slab shall be ordered full length & cut to fit. Balance of bar to be used in opposite end of culvert.

Bars indicated thus 1x2-#4 etc. indicates 1 line of bars with 2 lengths per line.

For Section A-A, see Sheet 3.

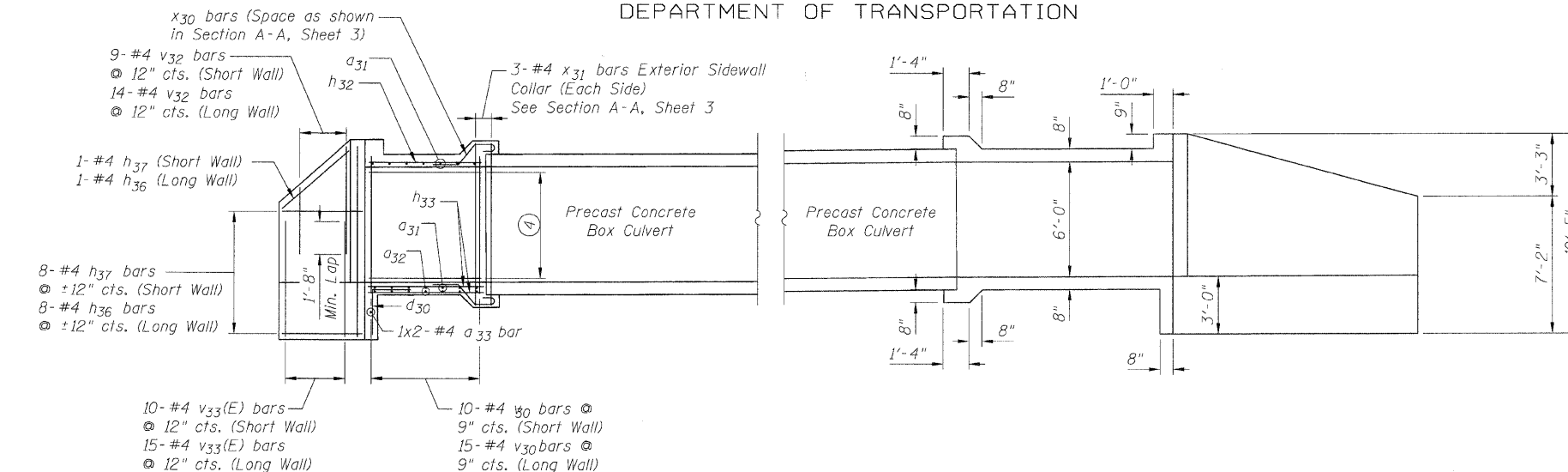

ELEVATION

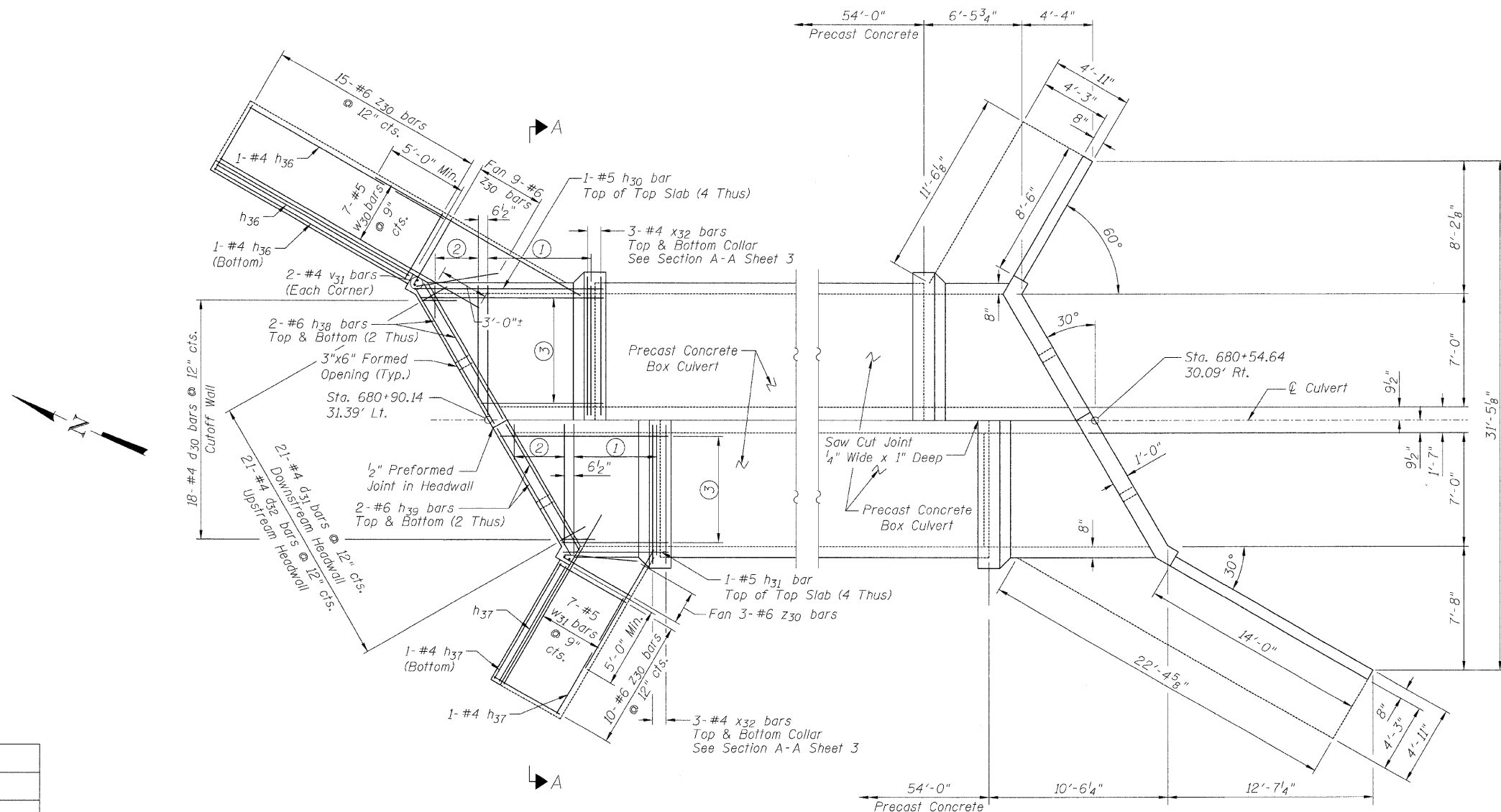

PLAN

DESIGNED	LAS
CHECKED	JLA
DRAWN	SAW
CHECKED	LAS

BOX CULVERT END SECTIONS
IL 71 OVER BRANCH OF MISSION CREEK
FAP ROUTE 311
SECTION (3)BR-1,2,3 & (4)BR
LASALLE COUNTY
STA. 680+72.01
S.N. 050-2049