

DEPARTMENT OF TRANSPORTATION

ROUTE NO.	SECTION	COUNTY	TOTAL SHEETS	SHEET NO.
F.A.P. 311	#	LaSalle	66	43
FED. ROAD DIST. NO. 7		ILLINOIS	FED. AID PROJECT-	

*(3)BR-1,2,3 & (4)BR Contract #66741

NOTES

- ① 11- #8 a₄₁ bars @ 7½" cts.
(Bottom of Top Slab & Top of Bottom Slab)
4- #4 a₄₂ bars @ 2'-0" cts.
(Bottom of Bottom Slab)
- ② **6- #8 a₄₁ bars @ 7½" cts.
(Bottom of Top Slab & Top of Bottom Slab)
**2- #4 a₄₂ bars @ 2'-0" cts.
(Bottom of Bottom Slab)
- ③ *12- #6 h₄₂ bars @ 12" cts.
(Bottom of Top Slab)
*10- #5 h₄₃ bars @ 14" cts.
(Top of Bottom Slab & Bottom of Bottom Slab)

* Cut bar, see Cut Diagrams on Sheet 4

** a bars in skew portion of slab shall be ordered full length & cut to fit. Balance of bar to be used in opposite end of culvert.

For Section A-A, see Sheet 3.

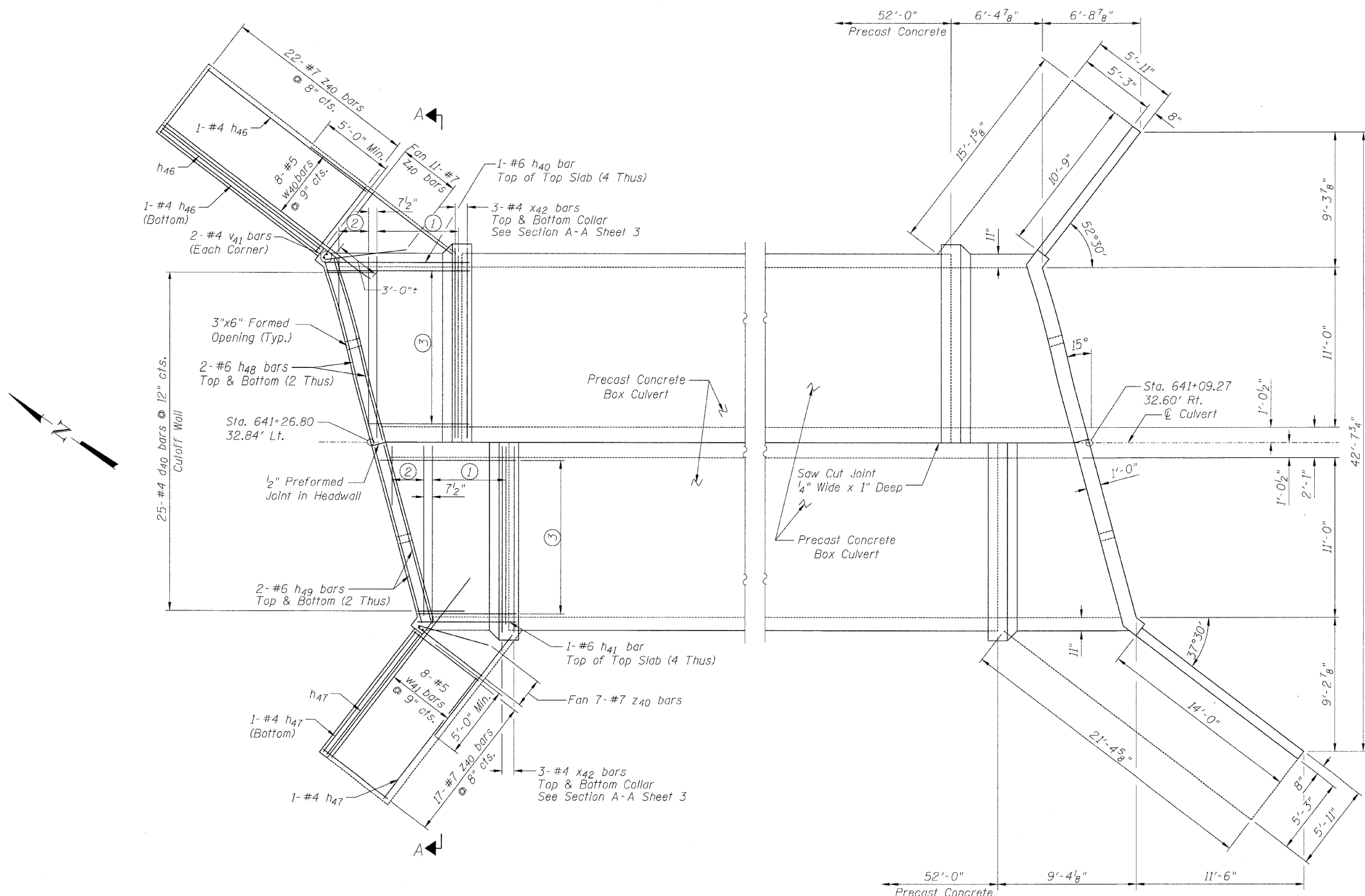

PLAN

DESIGNED	LAS
CHECKED	JLA
DRAWN	SAW
CHECKED	LAS

BOX CULVERT PLAN
IL 71 MISSION CREEK
FAP ROUTE 311
SECTION (3)BR-1,2,3 & (4)BR
LASALLE COUNTY
STA. 641+18.00
S.N. 050-2050