

Sta. 289+00 on South side of Norfolk & Western RR
 Elev. 789.00

STATE OF ILLINOIS
 DEPARTMENT OF PUBLIC WORKS & BUILDINGS
 DIVISION OF HIGHWAYS

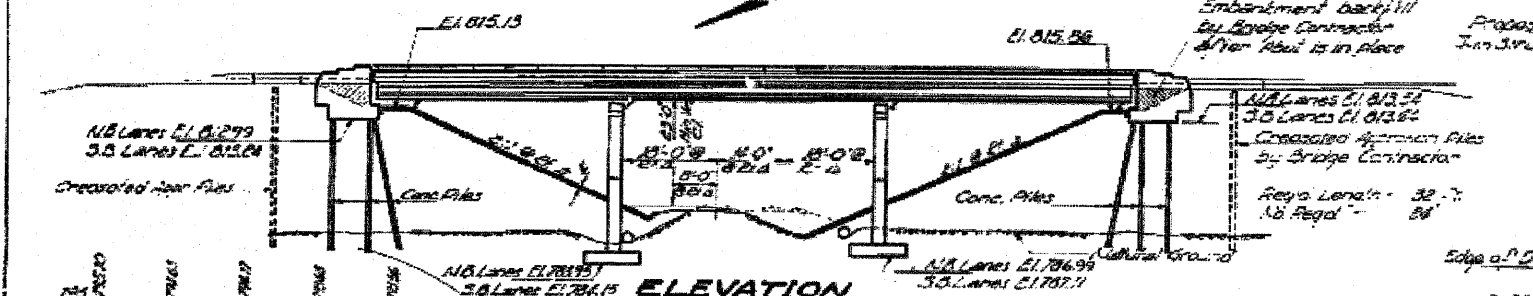

ELEVATION

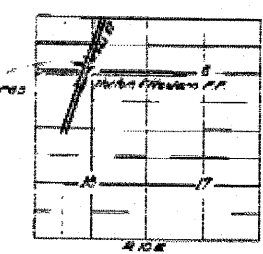

LOCATION PLAN

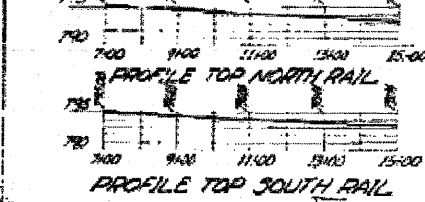

PROFILE TOP NORTH RAIL

PROFILE TOP SOUTH RAIL

NORFOLK & WESTERN RY.
 BUILT 1908 BY
 STATE OF ILLINOIS
 P.A. 1757 SEC. 27-1VB
 P.A. PROJ. 1-16-57-4.58
 STA. 289+70.58
 LOADING 1050 & ALT.

NAME PLATE
 See Sta. 2113-1

SEC. A-A

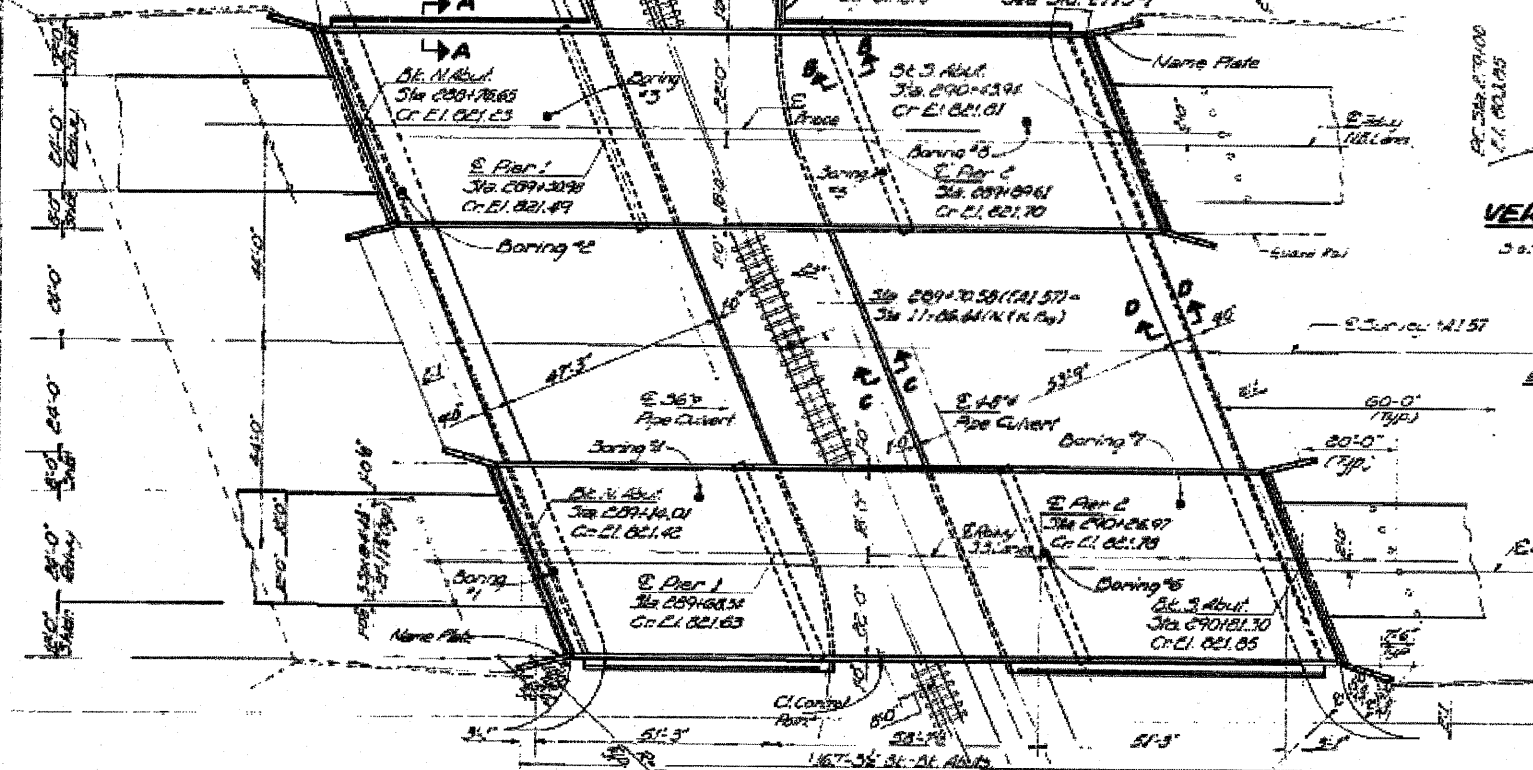

PLAN

VERTICAL CURVE DATA

See Sta. 2113-1



SEC. D-D



SEC. C-C



SEC. B-B

DESIGN STRESSES

$f_c = 1400$ psi (Concrete)
 $f_s = 20000$ psi (Steel)
 $v_e = 75$ psi (Figs.)
 $n = 10$

PRECAST PRESTRESSED UNITS

$f_c = 5000$ psi
 $f_s = 4000$ psi
 $f_s = 80000$ psi (Tension)
 $f_{st} = 170,000$ psi

GENERAL NOTES

Concrete shall be used throughout. Concrete aggregate to be used in accordance with paragraph 10.2 of the Specifications. All concrete shall be placed in place. The concrete shall be finished and cured in accordance with paragraph 10.3 of the Specifications. Expansion joints shall be provided at the ends of the bridge and at the abutments. Expansion joints shall be provided at the ends of the bridge and at the abutments. Expansion joints shall be provided at the ends of the bridge and at the abutments.

TOTAL BILL OF MATERIAL

ITEM	QUANTITY	UNIT	PRICE	TOTAL
Class 4 Exc. - 2" - 4" - 6" - 8" - 10"	1.97	cu yd	1.97	3.89
Structural Steel	1.00	lb	0.60	0.60
Class 1 Concrete	10.00	cu yd	3.25	32.50
Reinforcing Steel	10.00	lb	0.50	5.00
Expansion Joints	1.00	sq ft	55.00	55.00
Cast-in-place Concrete	10.00	cu yd	3.25	32.50
Concrete Piles	1.00	sq ft	2.00	2.00
Cast-in-place Concrete	1.00	cu yd	3.25	3.25
Name Plate	1.00	sq ft	0.50	0.50
Slope Wall	1.00	sq ft	2.00	2.00
Furnishing & Erecting	1.00	sq ft	2.00	2.00
Concrete Slab	1.00	sq ft	2.00	2.00
Protective Coat	1.00	sq ft	0.50	0.50
Slope Steel Sheet	1.00	sq ft	0.50	0.50

GENERAL PLAN ELEVATION

**EAL 57 OVER NORFOLK & WESTERN RY.
 EAL 57 SEC. 27-1VB
 FORD COUNTY
 ILLINOIS**

DESIGNED: *Bobby Farkis*
 CHECKED: *[Signature]*
 DRAWN: *[Signature]*
 CHECKED: *[Signature]*

EXAMINED: *[Signature]*
 PASSED: _____
 APPROVED: _____