

SEC. 3, T. 16 N., R. 9 E., 3rd P.M.

F.A.P. RTE.	SECTION	COUNTY	TOTAL SHEETS	SHEET NO.
808	.	..	715	67
STA. 808		TO STA. 307+00.00		
FED. ROAD DIST. NO.		ILLINOIS FED. AID PROJECT		

- (205,57,105)RS-2
- CHAMPAIGN & DOUGLAS

- INCIDENTAL HOT-MIX ASPHALT SURFACING
- AGGREGATE SURFACE COURSE, TYPE B
- HOT-MIX ASPHALT SURFACE REMOVAL - BUTT JOINT
- DRIVEWAY PAVEMENT REMOVAL

PIPE CULVERT, CLASS D, TYPE 1, 24"x48.0'  
WITH END SECTIONS, 24" - 2.0 EACH  
30.5' LT., STA. 306+33.00, D.S.F.L. = 647.81  
30.5' LT., STA. 306+81.00, U.S.F.L. = 647.85

PIPE CULVERT REMOVAL - 40.5'  
24"x40.5" RCCP

PIPE CULVERT REMOVAL - 25.0'  
24"x25.0" CMP

PIPE CULVERT, CLASS D, TYPE 1, 24"x52.0'  
WITH END SECTIONS, 24" - 2.0 EACH  
30.0' RT., STA. 306+39.00, D.S.F.L. = 647.92  
30.0' RT., STA. 306+91.00, U.S.F.L. = 647.95

BETTY J. CRAWFORD TRUST

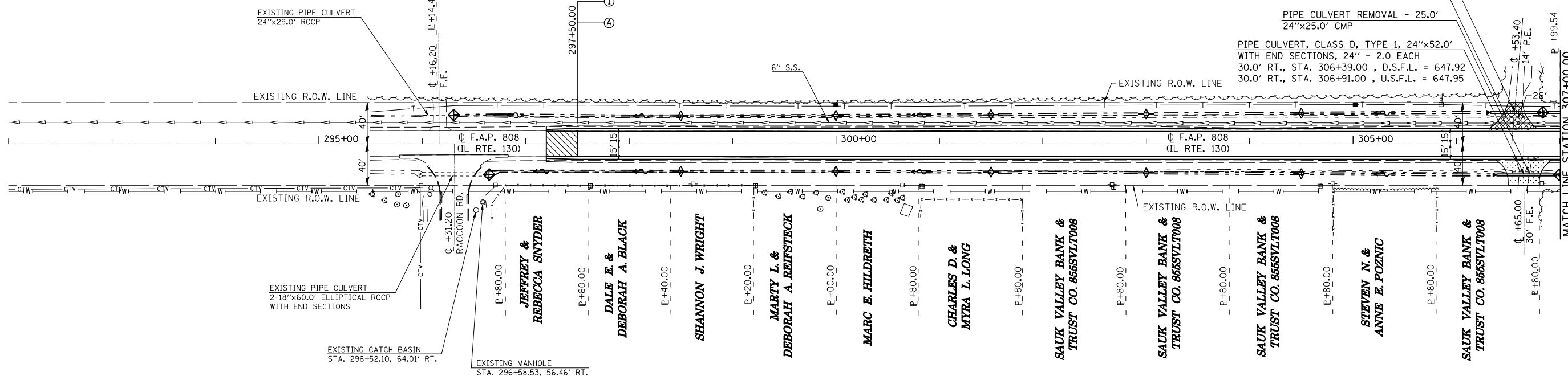

SEC. 2, T. 16 N., R. 9 E., 3rd P.M.

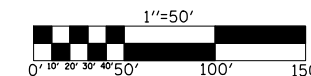

PLAN	SURVEYED	BY	DATE
NO. _____	PLOTTED		
	CHECKED		
	BY		
	DATE		

PROFILE	SURVEYED	BY	DATE
NO. _____	PLOTTED		
	CHECKED		
	BY		
	DATE		

PLOT DATE = 8/13/2009  
FILE NAME = c:\pwworking\pmdot\gearlock\j\001445\70623\111111.dwg  
PLOT SCALE = 1/8" = 10' / IN.  
USER NAME = gearlockj

