

SEC. 3, T. 17 N., R. 9 E., 3rd P.M.

DECKER FARMS, INC.,  
A NEVADA CORPORATION  
5527033

F.A.P. RTE.	SECTION	COUNTY	TOTAL SHEETS	SHEET NO.
808	.	..	715	87
STA. 2118+25.00		TO STA. 2133+50.00		
FED. ROAD DIST. NO.		ILLINOIS FED. AID PROJECT		
		(205,57,105)RS-2 CHAMPAIGN & DOUGLAS		

NORMA J. ELKINS  
5527028



PIPE CULVERT, CLASS D, TYPE 1, 18"x50.0'  
WITH END SECTIONS, 18" - 2.0 EACH  
29.0' LT., STA. 2128+69.02, D.S.F.L. = 665.45  
29.0' RT., STA. 2129+19.02, U.S.F.L. = 665.49

PIPE CULVERT, CLASS D, TYPE 1, 18"x42.0'  
WITH END SECTION, 18" - 1.0 EACH  
29.5' RT., STA. 2132+86.25, D.S.F.L. = 665.95  
30.0' RT., STA. 2133+28.25, U.S.F.L. = 665.99

PLAN	SURVEYED	BY	DATE

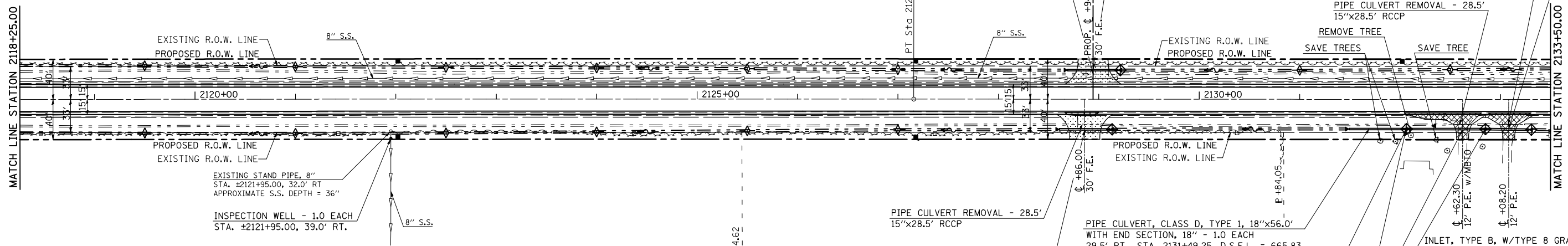

- INCIDENTAL HOT-MIX ASPHALT SURFACING
- AGGREGATE SURFACE COURSE, TYPE B
- HOT-MIX ASPHALT SURFACE REMOVAL - BUTT JOINT
- DRIVEWAY PAVEMENT REMOVAL

FRANK WILHELM FAMILY  
LIMITED PARTNERSHIP  
5527029

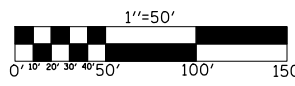

PIPE CULVERT, CLASS D, TYPE 1, 18"x50.0'  
WITH END SECTIONS, 18" - 2.0 EACH  
30.0' RT., STA. 2128+60.80, D.S.F.L. = 665.26  
30.0' RT., STA. 2129+10.80, U.S.F.L. = 665.38

PIPE CULVERT, CLASS D, TYPE 1, 18"x56.0'  
WITH END SECTION, 18" - 1.0 EACH  
29.5' RT., STA. 2131+49.25, D.S.F.L. = 665.83  
29.5' RT., STA. 2132+05.25, U.S.F.L. = 665.87

GENEVIEVE T. CLARK  
5527030

PETER E. MANRIQUE AND  
LAURA A. MANRIQUE  
5527031

EXISTING 4" DRAIN TO OUTLET  
INTO TYPE B INLET  
INVERT: ±667.00

PIPE CULVERT, CLASS D, TYPE 1, 18"x76.0'  
29.5' RT., STA. 2132+07.50, D.S.F.L. = 665.88  
29.5' RT., STA. 2132+83.75, U.S.F.L. = 665.94

SEC. 2, T. 17 N., R. 9 E., 3rd P.M.

PROFILE	SURVEYED	BY	DATE

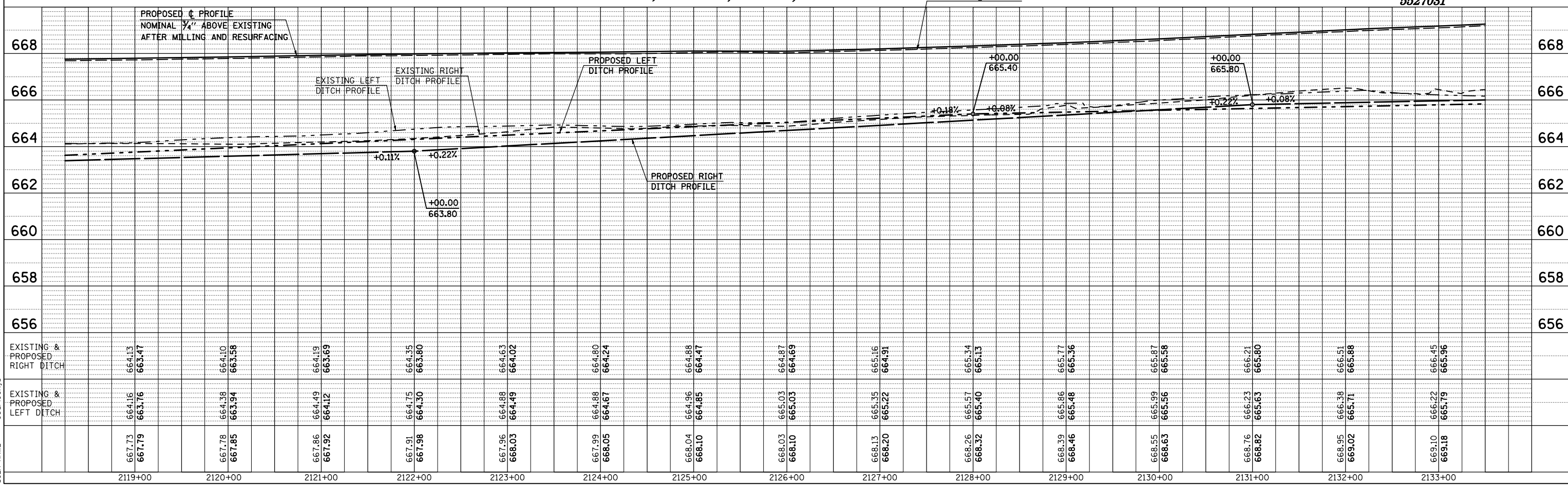

PLOT DATE = 8/13/2009  
FILE NAME = c:\pwwork\p\m\dot\gearlock\j\001445\70623-87.dwg  
PLOT SCALE = 1/8" = 1'-0"  
USER NAME = gearlockj