

F.A.P. RTE.	SECTION	COUNTY	TOTAL SHEETS	SHEET NO.
808	*	**	715	130

STA. TO STA.
FED. ROAD DIST. NO. ILLINOIS FED. AID PROJECT

- (205,57,105)RS-2
- ** CHAMPAIGN & DOUGLAS

JOSEPH E. LAWLESS
5527002

LYLE W. AND MARYANNE JOHNS, ET. AL.
5527003

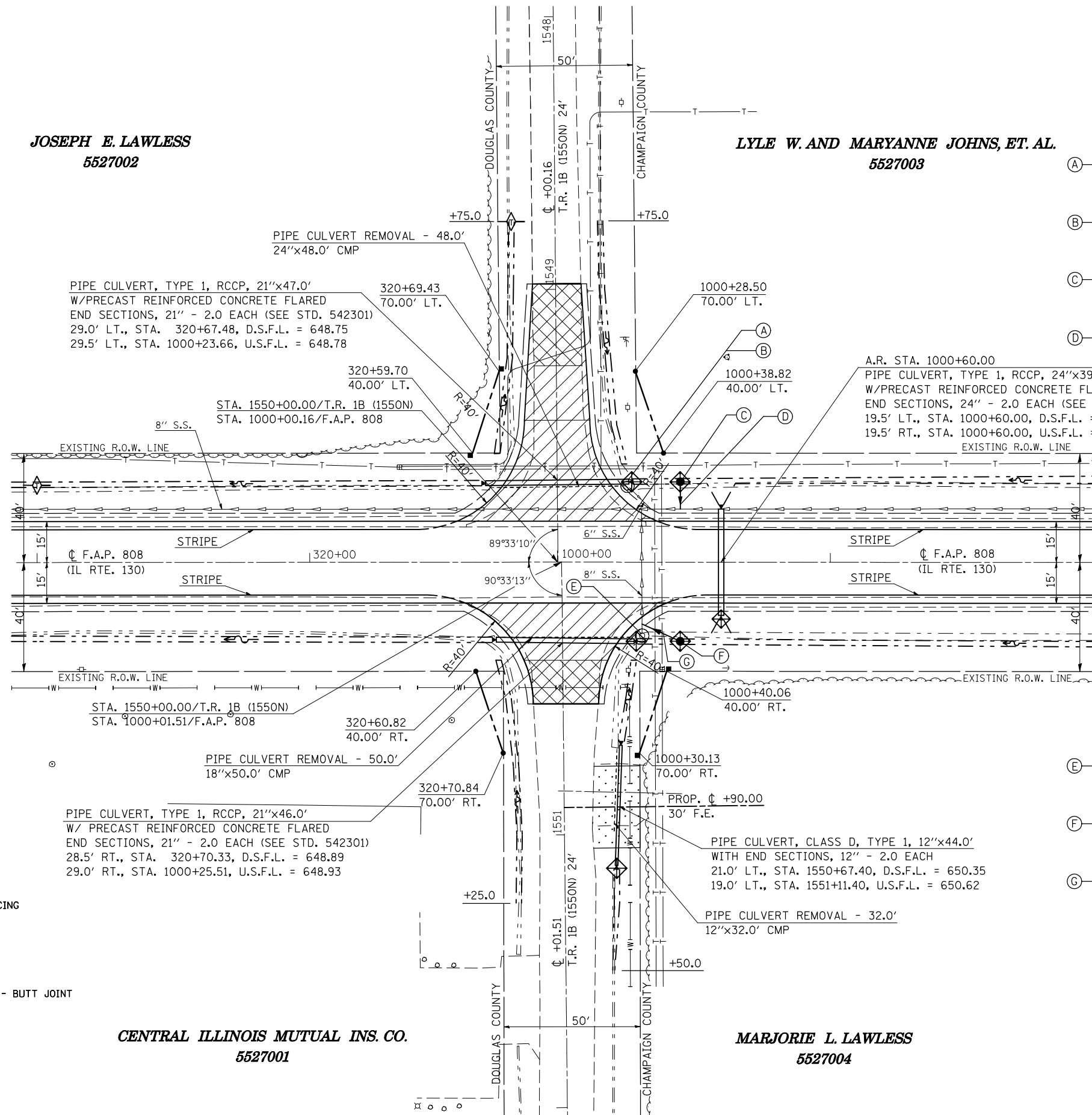

- (A) REMOVING CATCH BASINS - 1.0 EACH
TYPE C W/TYPE 8 GRATE
STA. 1000+25.64, 28.0' LT.
- (B) PLUG EXISTING STORM SEWER - 1.0 EACH
STA. 1000+25.64, 28.0' LT.
- (C) CATCH BASIN, TYPE C
W/TYPE 8 GRATE - 1.0 EACH
STA. 1000+45.00, 29.5' LT.
- (D) STORM SEWER PROTECTED
CLASS A, 8" - 12.0'

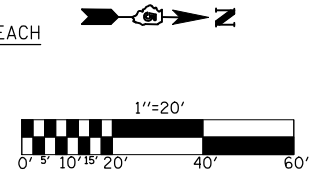

STATION EQUATION:
STATION 320+90.82 BK. =
STATION 1000+00.00 AH.

- INCIDENTAL HOT-MIX ASPHALT SURFACING
- AGGREGATE SURFACE COURSE, TYPE B
- HOT-MIX ASPHALT SURFACE REMOVAL - BUTT JOINT
- DRIVEWAY PAVEMENT REMOVAL

CENTRAL ILLINOIS MUTUAL INS. CO.
5527001

MARJORIE L. LAWLESS
5527004

ILLINOIS DEPARTMENT OF TRANSPORTATION
INTERSECTION PLAN SHEET
T.R. 1B/1550N & F.A.P. 808 (IL. RTE. 130)
F.A.P. 808 (IL. RTE. 130)
SECTION (205,57,105)RS-2
CHAMPAIGN & DOUGLAS COUNTIES
SCALE: 1" = 20'
DATE: 07/10/09
DRAWN BY: B.B.P.
CHECKED BY: G.A.E.

PLOT DATE = 8/12/2009
FILE NAME = G:\dwg\work\K\PIWIDOT\CEARLOCK\DWG\010445\70623-sht-inter.sec.dgn
USER NAME = ceartock\j