

F.A.P. RTE.	SECTION	COUNTY	TOTAL SHEETS	SHEET NO.
808	*	**	715	257
STA.		TO STA.		
FED. ROAD DIST. NO.	ILLINOIS	FED. AID PROJECT		

- (205,57,105)RS-2
- ** CHAMPAIGN & DOUGLAS

DETAIL OF POROUS GRANULAR EMBANKMENT PAY LIMITS

CULVERT NO. 7, STATION 2116 + 20.00

S.N. 010-8142

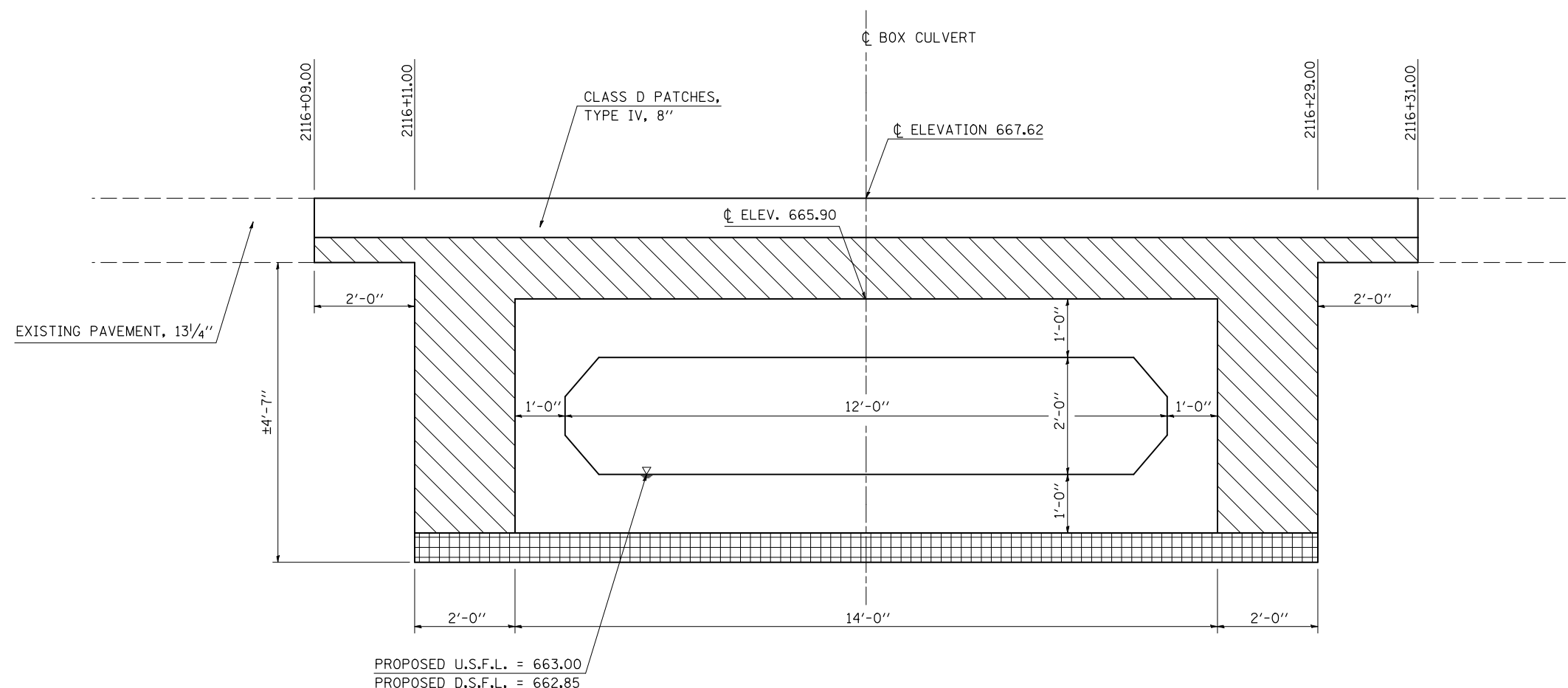

LEGEND

- PAY LIMITS OF POROUS GRANULAR EMBANKMENT - CA-6
- POROUS GRANULAR MATERIAL - CA-7 (6") INCLUDED IN PAY ITEM FOR BOX CULVERT

DRAWING NOT TO SCALE

GENERAL NOTES

- 1) WORK SHOWN IN THE DETAIL SHALL BE PERFORMED IN ACCORDANCE WITH APPLICABLE PORTIONS OF SECTION 207 AND SECTION 540 OF THE STANDARD SPECIFICATIONS.
- 2) POROUS GRANULAR EMBANKMENT SHALL EXTEND 2 FT. BEYOND THE AGGREGATE SHOULDER.
- 3) THIS WORK SHALL BE PAID FOR AT THE CONTRACT UNIT PRICE PER CUBIC YARD FOR POROUS GRANULAR EMBANKMENT.
- 4) THE AREA TO BE EXCAVATED FOR THE PROPOSED BOX CULVERT SHALL BE MEASURED AND PAID FOR AT THE CONTRACT UNIT PRICE PER CUBIC YARD FOR STRUCTURE EXCAVATION.

SHEET 4 OF 4

ILLINOIS DEPARTMENT OF TRANSPORTATION
DETAIL OF POROUS GRANULAR EMBANKMENT
PAY LIMITS, STA. 2116+20.00
CULVERT NO. 7

SCALE: N/A
 DATE: 07/14/09

DRAWN BY: B.B.P.
 CHECKED BY: G.A.E.

PLOT DATE = 8/19/2009
 FILE NAME = G:\DWG\WORK\K\PIWIDOT\CEARLOCK\DWG\0101445\70623-sht-detailed.dgn
 USER NAME = cearlock\j