

F.A.I. RTE.	SECTION	COUNTY	TOTAL SHEETS	SHEET NO.
55		McLEAN	310	44
STA. 37+610		TO STA. 37+955		
FED. ROAD DIST. NO.	ILLINOIS FED. AID PROJECT			
* (57-4)R, HBY, HBR, (57-4)B/D/M				
CONTRACT #70757 GUARDRAIL REMOVAL				

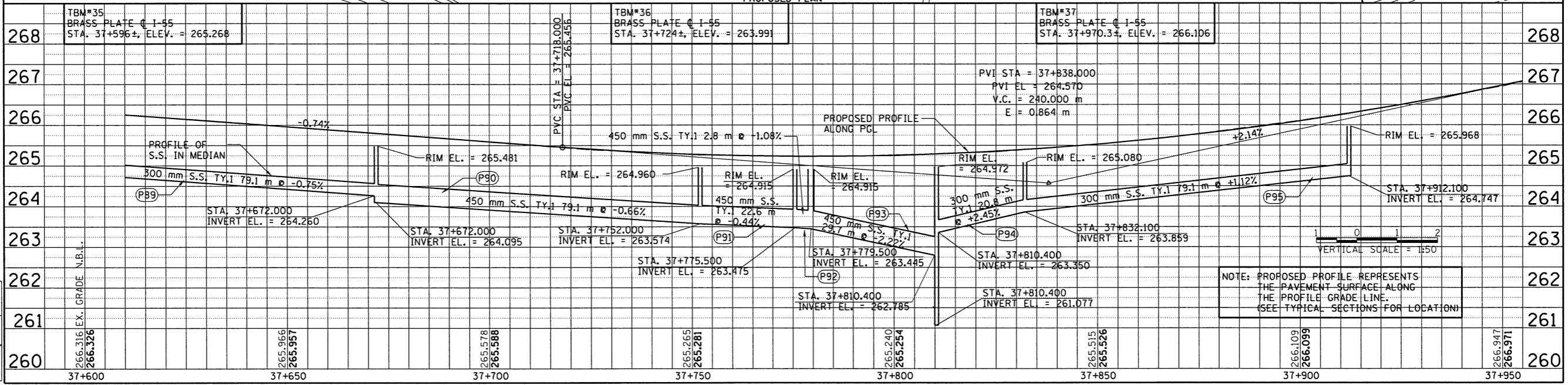
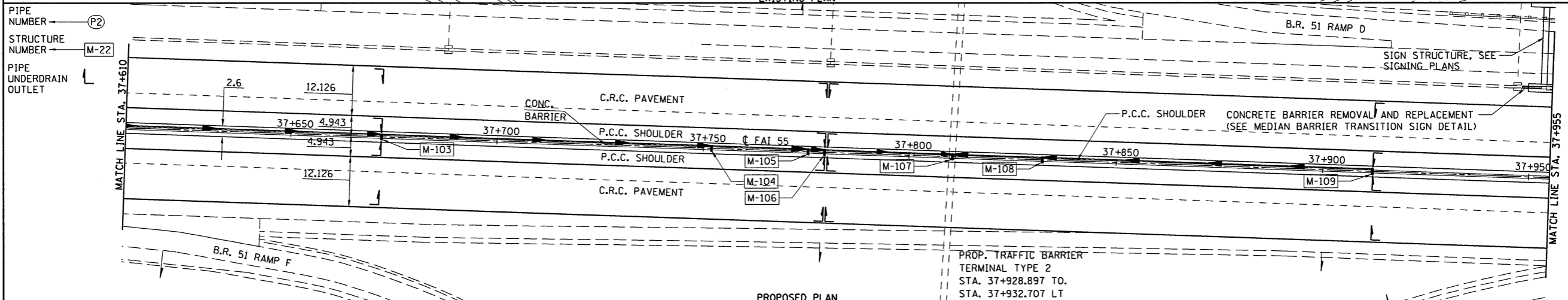
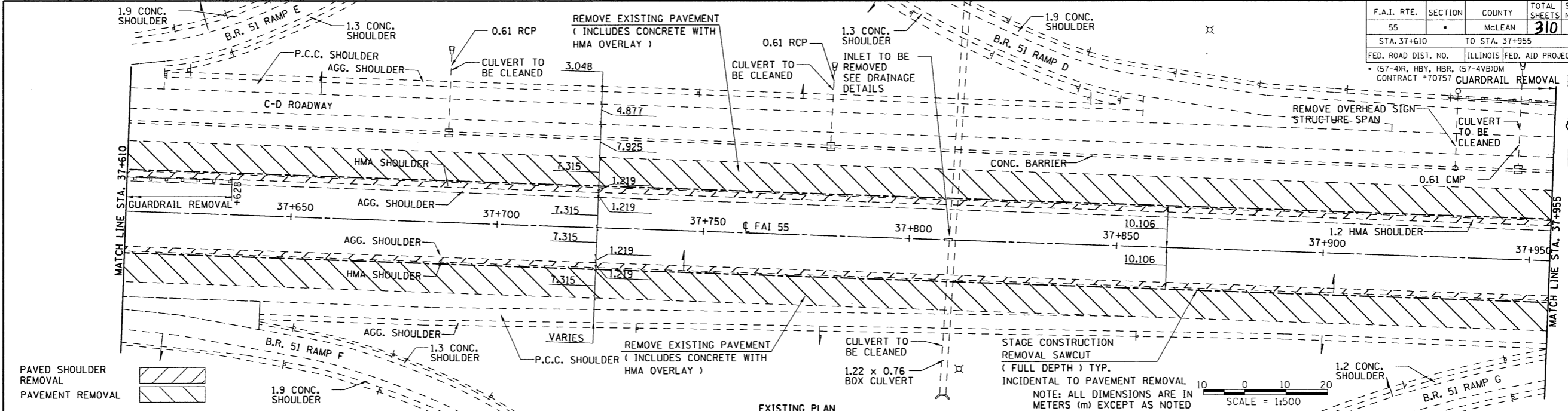

LAYOUT	04/05/03
DRAWN	07/05/04
REVIEWED	02/20/04
DATE	04/05/03

NOTE: PROPOSED PROFILE REPRESENTS THE PAVEMENT SURFACE ALONG THE PROFILE GRADE LINE. (SEE TYPICAL SECTIONS FOR LOCATION)