

F.A.I. RYE.	SECTION	COUNTY	TOTAL SHEETS	SHEET NO.
55	*	MCLEAN	310	59
FED. ROAD DIST. NO. ILLINOIS		FED. AID PROJECT		
* (57-4)R, HBY, HBR, (57-4)BIDM CONTRACT #70757				

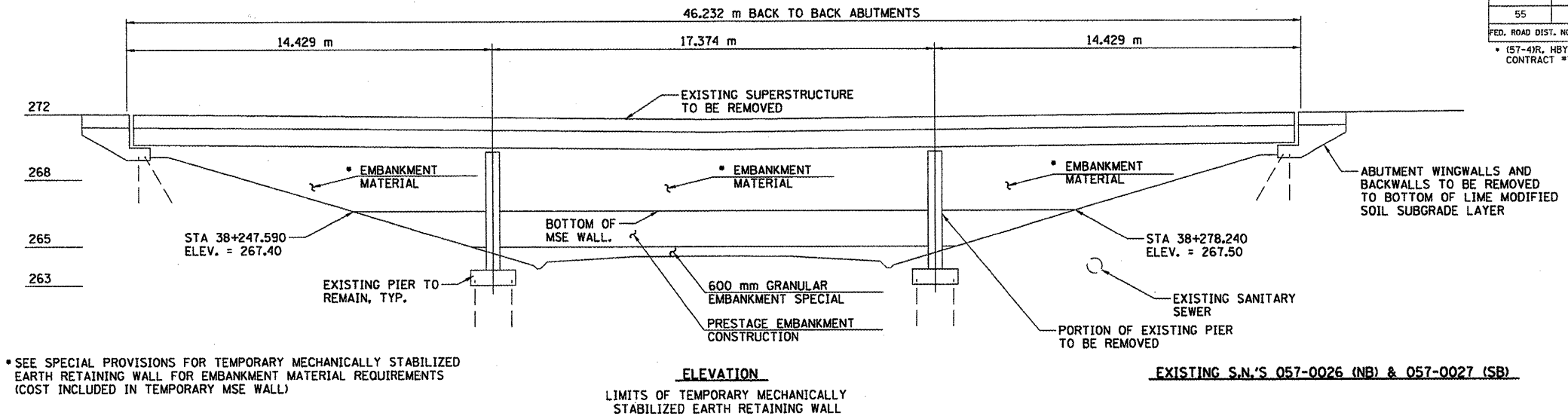

NOTES:

THE EARTH EMBANKMENT MUST BE PLACED AND COMPACTED TO PROVIDE A COHESION OF AT LEAST 1.0 KSF TOGETHER WITH A FRICTION ANGLE OF LESS THAN 7 DEGREES TO RESIST THE WALLS MAXIMUM APPLIED BEARING PRESSURE OF 3.2 KSF.

IT IS ESTIMATED THE EXISTING FOUNDATION SOILS WILL EXPERIENCE SETTLEMENT IN EXCESS OF 162.5 mm. SETTLEMENT PLATES SHALL BE UTILIZED TO DETERMINE WHEN THE SETTLEMENT IS COMPLETE. IT IS ESTIMATED THE SETTLEMENT MAY BE COMPLETE AFTER 4 MONTHS. WORK ON THE PROPOSED PAVEMENT STRUCTURE CANNOT BEGIN UNTIL THE SETTLEMENT IS COMPLETE.

THE STATIONS FOR THE PROPOSED MSE WALL ARE ESTIMATED FROM THE ORIGINAL BRIDGE PLANS AND SHOULD BE VERIFIED IN THE FIELD.

AREA OF EMBANKMENT MATERIAL BEHIND THE SELECT FILL AS REQUIRED PER SPECIAL PROVISION FOR TEMPORARY MECHANICALLY STABILIZED EARTH RETAINING WALL (COST INCLUDED IN TMSE WALLS)

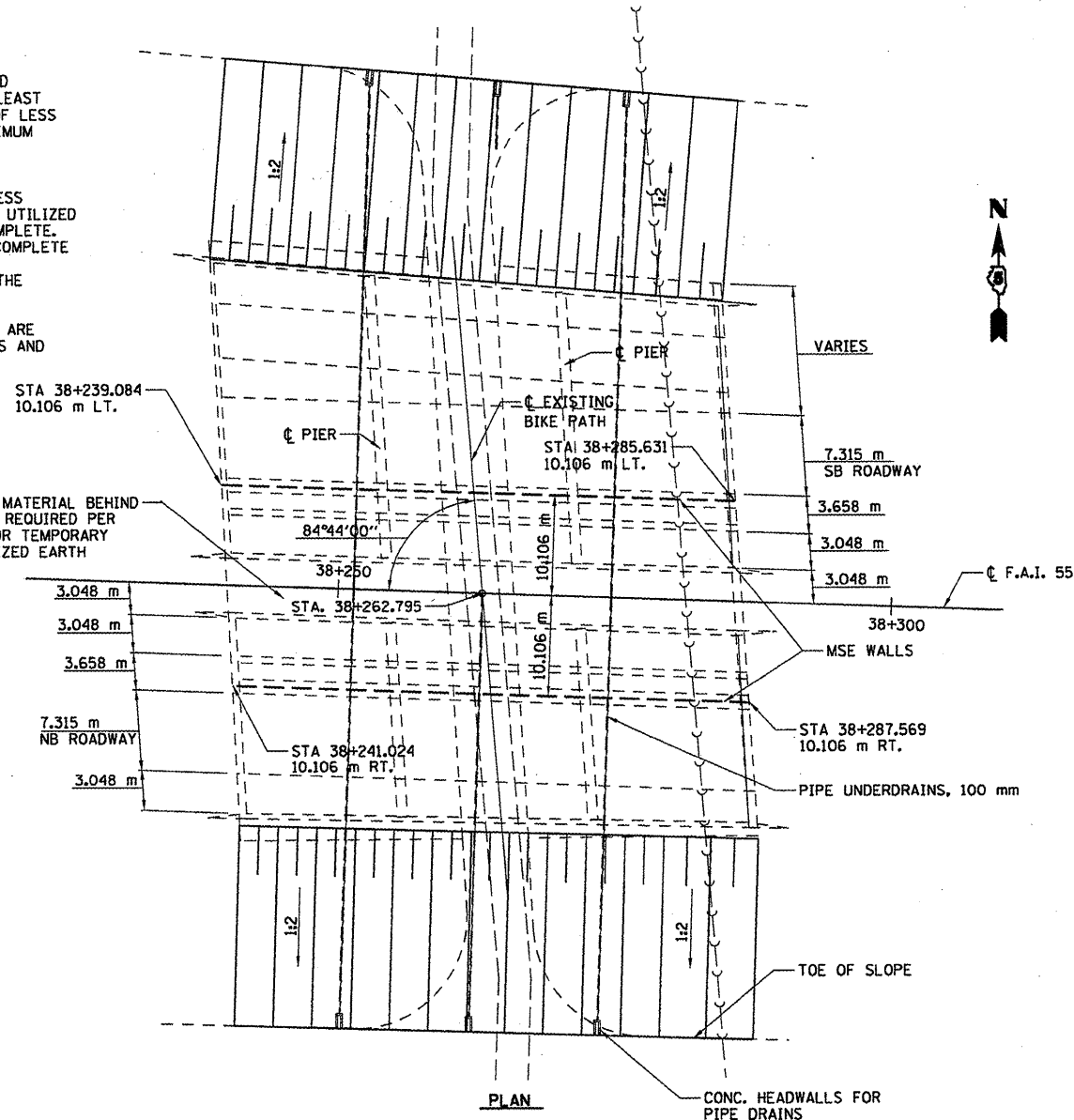

PAY ITEM SUMMARY

ITEM	UNIT	QUANTITY
REMOVAL OF EXISTING SUPERSTRUCTURES	EACH	2
BRIDGE MONITORING	EACH	2
CONCRETE REMOVAL	CU. M.	483.0
GRANULAR EMBANKMENT SPECIAL	CU. M.	832.0
BORROW EXCAVATION	CU. M.	4,800
TEMPORARY MECHANICALLY STABILIZED EARTH RETAINING WALLS	SO. M.	551.0
PIPE UNDERDRAINS, 100mm	METER	249.0
SLOPEWALL REMOVAL	SO. M.	1661
CONCRETE HEADWALLS FOR PIPE DRAINS	EACH	6

\* SEE SPECIAL PROVISIONS



9/29/09  
Lic. Exp. 11/30/10

ILLINOIS DEPARTMENT OF TRANSPORTATION  
F.A.I. 55  
SECTION (57-4)R, HBY, HBR, (57-4)BIDM  
MCLEAN COUNTY  
**EMBANKMENT CONSTRUCTION  
I-55 OVER EXISTING BIKE PATH**

REVISIONS	
NAME	DATE

JOB NO. 94S2063  
DATE 8/19/2009  
**HANSON**

DESIGNED	04/10/03
CHECKED	03/05/04
APPROVED	03/08/04
DATE	03/08/04