

F.A.I. RTE.	SECTION	COUNTY	TOTAL SHEETS	SHEET NO.
55		MCLEAN	310	77
FED. ROAD DIST. NO. ILLINOIS		FED. AID PROJECT		
• (57-4)R, HBY, HBR, (57-4)BIDM CONTRACT #70757				

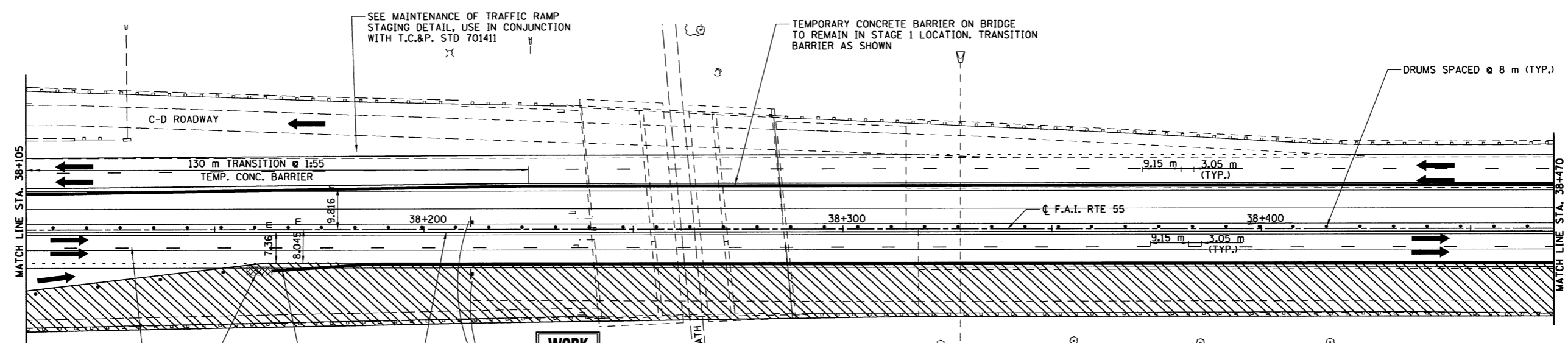
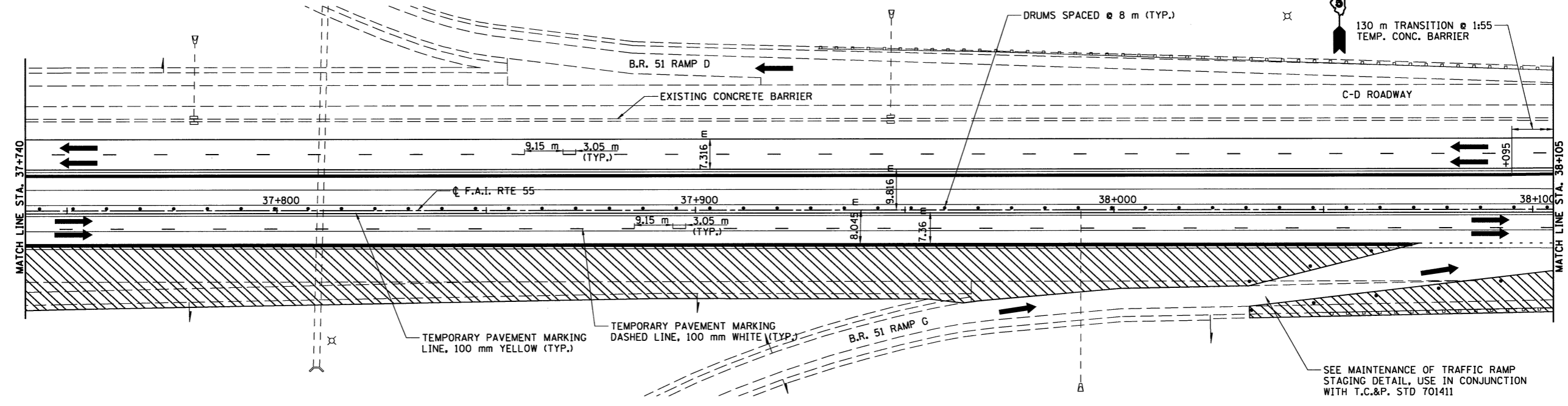

NOTE: STAGE 3 MAINTENANCE OF TRAFFIC LAYOUT SHALL BE THE SAME AS THE STAGE 2 MAINTENANCE OF TRAFFIC LAYOUT. CONTRACTOR MAY CONSTRUCT STAGE 3 PRIOR TO STAGE 2.

PROVIDE 1:15 TAPER FOR 22.8 m, SEE BARRIER DETAILS

IMPACT ATTENUATOR, TEMPORARY (FULLY REDIRECTIVE) TEST LEVEL 3

TEMPORARY PAVEMENT MARKING DASHED LINE, 100 mm WHITE (TYP.)

TEMPORARY PAVEMENT MARKING LINE, 100 mm YELLOW (TYP.)

WORK ZONE

SPEED LIMIT 55

XXXX FINE MINIMUM

- LEGEND
- WORK ZONE
 - TRAFFIC MOVEMENT
 - TEMPORARY CONCRETE BARRIER
 - DRUM W/STEADY BURNING LIGHT
 - TYPE III BARRICADE

SCALE: 1:500

10 0 10 20

ILLINOIS DEPARTMENT OF TRANSPORTATION
F.A.I. 55
SECTION (57-4)R, HBY, HBR, (57-4)BIDM
MCLEAN COUNTY
MAINTENANCE OF TRAFFIC I-55 STAGE 2

REVISIONS	
NAME	DATE

HANSON

JOB NO. 9452063
DATE 8/11/2009

LAYOUT	DLH	03/02/04
DRAWN	DLH	03/02/04
REVIEWED	DLH	03/18/04

8/11/2009
6P/LES