

F.A.I. RTE.	SECTION	COUNTY	TOTAL SHEETS	SHEET NO.
55		McLEAN	310	177

FED. ROAD DIST. NO. 7 ILLINOIS FAP
 *(57-4)R, HBY, HBR, (57-4VB)DM
 Contract No. 70757

BENCH MARK:
 Disk on C of F.A.I. 55
 at Sta. 37+535.321
 Elev. 265.767

Note:
 The existing B.M. will be removed during median construction. A new permanent B.M. will be established during construction.

EXISTING STRUCTURES:
 No. 057-0024 (N.B.) & No. 057-0025 (S.B.) built as F.A.I. Rte. 55, Sec. 57-4HB-4, 4HF4 in 1962. Widening & deck replacement occurred in 1990. The superstructures consist of 4 span, steel stringer, reinforced concrete slabs with bk. to bk. abutment length of 63.576 m. Span lengths are 13.868 m, 17.374 m, 17.374 m and 13.868 m. The substructures consist of concrete pile bent abutments and multi-column concrete piers.

PROPOSED IMPROVEMENTS:
 Existing structures to be widened on the median side. Each structure shall have existing replaced and widened with four span continuous non-median side parapets and deck portions removed, composite steel stringers. Existing substructures to be widened along with special approach pavements. The structures shall be separated by a 25 mm sealed joint. The existing structural steel shall be cleaned and painted. Traffic shall be controlled by the typical 3 Stage Wide Work Zone Template. No salvage.

MISCELLANEOUS ELEVATIONS

Designation	S.B.L.	N.B.L.
Elev. 'A'	263.800	263.800
Elev. 'B'	259.171	258.665
Elev. 'C'	259.171	258.665
Elev. 'D'	259.171	258.665
Elev. 'E'	263.853	263.853
Elev. 'F'	265.033	265.033
Elev. 'G'	265.118	265.118

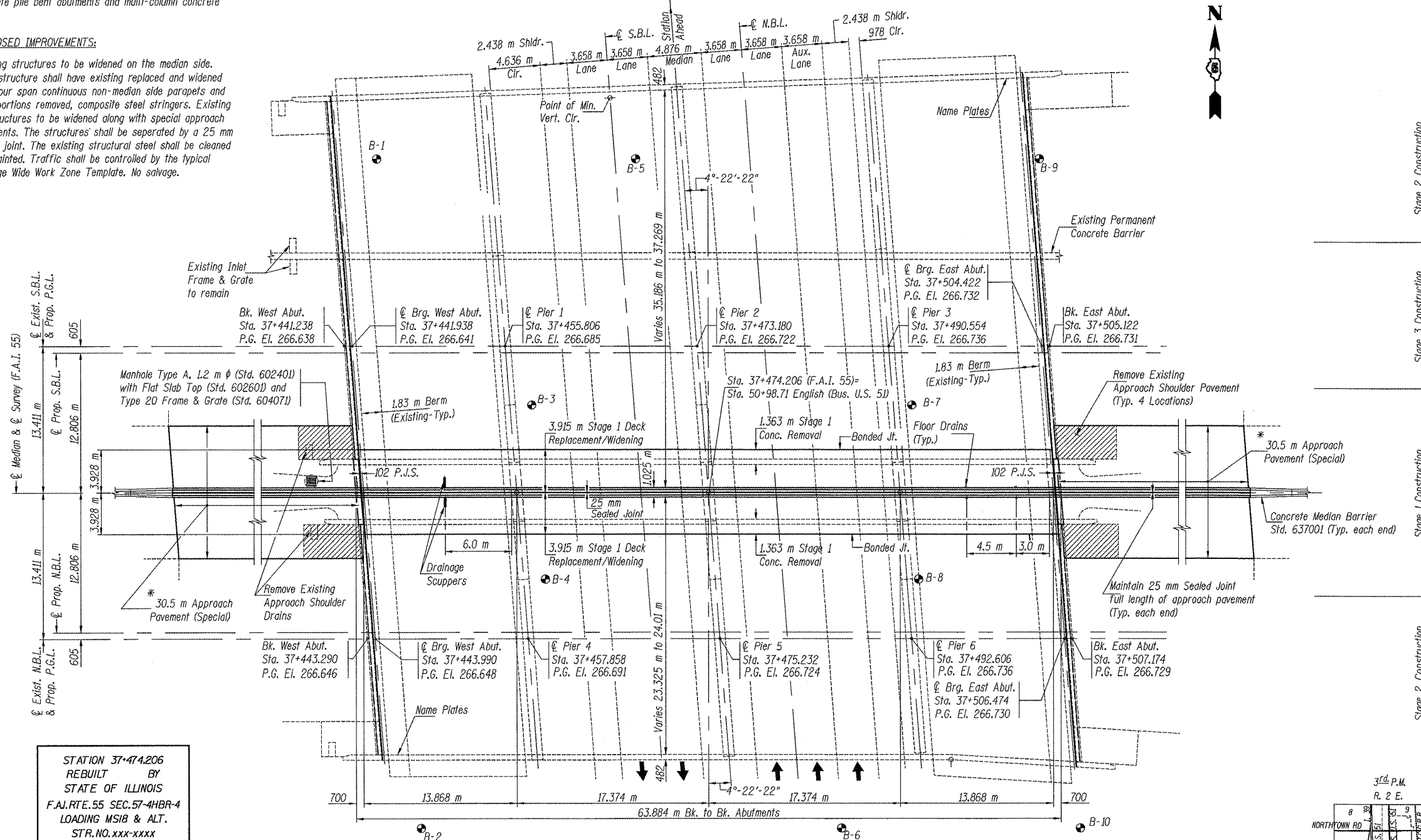
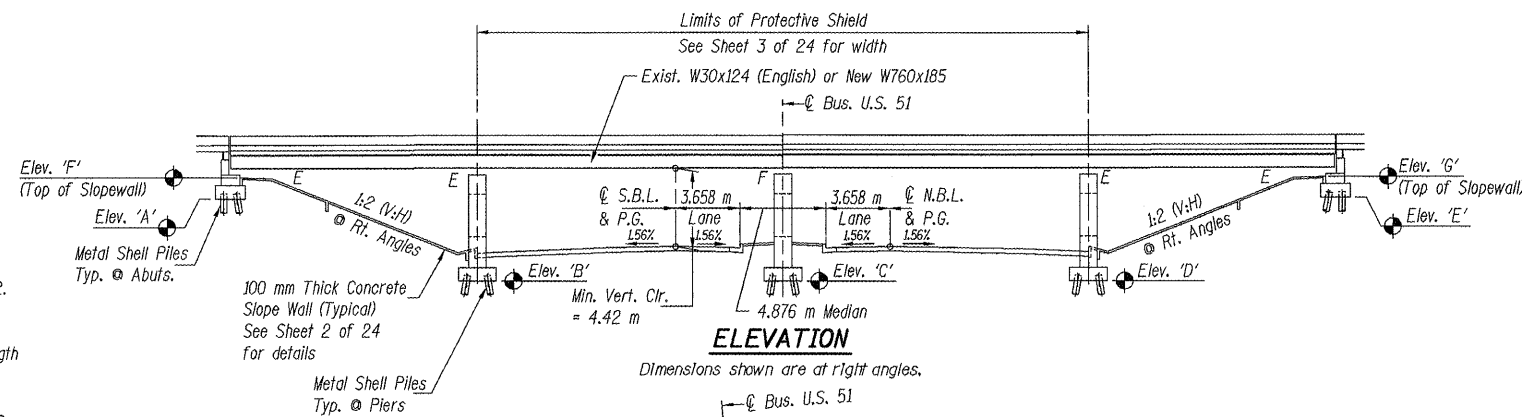

STATION 37+474.206
 REBUILT BY
 STATE OF ILLINOIS
 F.A.I. RTE. 55 SEC. 57-4HBR-4
 LOADING MS18 & ALT.
 STR. NO. xxx-xxxx

NAME PLATE

See Std. 515001
 Existing name plate shall be cleaned and relocated. Cost included in "Name Plates."
 New Name Plates shall be located adjacent to Existing Name Plates.
 xxx-xxxx = 057-0024 for NB Lanes
 xxx-xxxx = 057-0025 for SB Lanes

* Proposed approach pavement (special) shall be designed and constructed to match existing, adjacent approach pavement. See Roadway Plans.

Indicates Boring Location
 See Exist. Structure Plans (1962) for boring data

PLAN APPROVED
 For Structural Adequacy Only

Ralph E. Anderson
 Engineer of Bridges & Structures

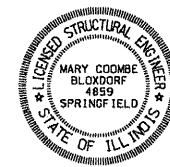

Mary Coombe Bloxdorf
 Structural Engineer License No. 081-004859
 Expiration Date: 11/30/2010
 Date: 8/19/09

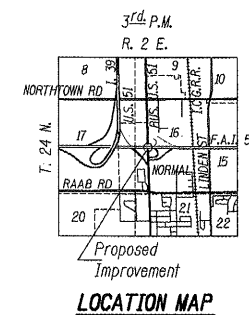

DESIGN SPECIFICATIONS

1996 AASHTO Specifications with 1997 Interim.

LOADING MS18 & ALT.

Allow 1.2 kN/m²
 Future Wearing Surface

SEISMIC DATA

S.P.C. = A
 A = .044 g
 S = 1.0

DESIGN STRESSES

EXISTING CONSTRUCTION

f'c = 24.1 MPa
 fy = 413.7 MPa (Reinf. Bars)
 fs (1990) = 136.5 (Structural Steel, AASHTO M183)
 fs (1962) = 125.1 (Structural Steel, AASHTO M183)

DESIGN STRESSES

NEW CONSTRUCTION

f'c = 24 MPa
 fy = 400 MPa (Reinf. Bars)
 fs = 138 MPa (Structural Steel, M270M, Grade 250)

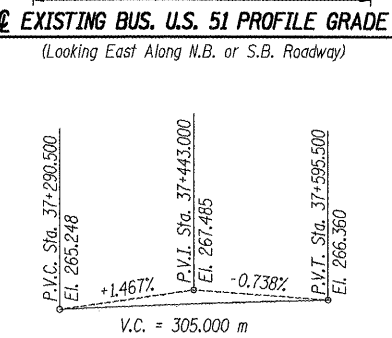
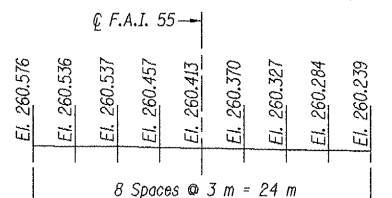

Note: All dimensions are in millimeters (mm) except as noted.

ILLINOIS DEPARTMENT OF TRANSPORTATION

SHEET TITLE		PROJECT	
GENERAL PLAN		F.A.I. 55 OVER BUSINESS U.S. 51	
PROJECT NO. 08049-5		SECTION 57-4HBR-4 STATION 37+474.206	
SCALE		McLEAN COUNTY	
DATE 07/15/2009		STRUCTURE NO. 057-0024 (N.B.) & STRUCTURE NO. 057-0025 (S.B.)	
DRAWN BY TFG/CFD		PROJECT NO.	
CHECKED BY CME/MCB		DRAWING NO. 1	
DRAWING NO.		COOMBE-BLOXDORF P.C.	
1		Engineers / Land Surveyors	
OF 24 SHTS		Springfield, Illinois	
		Design Firm License No. 184-002703	