

EXIST. CURVE 7  
 PI STA. = 510+70.30  
 $\Delta = 2^\circ 07' 29''$  (LT)  
 $D = 0^\circ 11' 29''$   
 $R = 29,947.30'$   
 $T = 555.36'$   
 $L = 1,110.59'$   
 $E = 5.15'$   
 $e = \text{---}$   
 T.R. =  $\text{---}$   
 S.E. RUN =  $\text{---}$   
 P.C. STA. = 505+14.94  
 P.T. STA. = 516+25.53

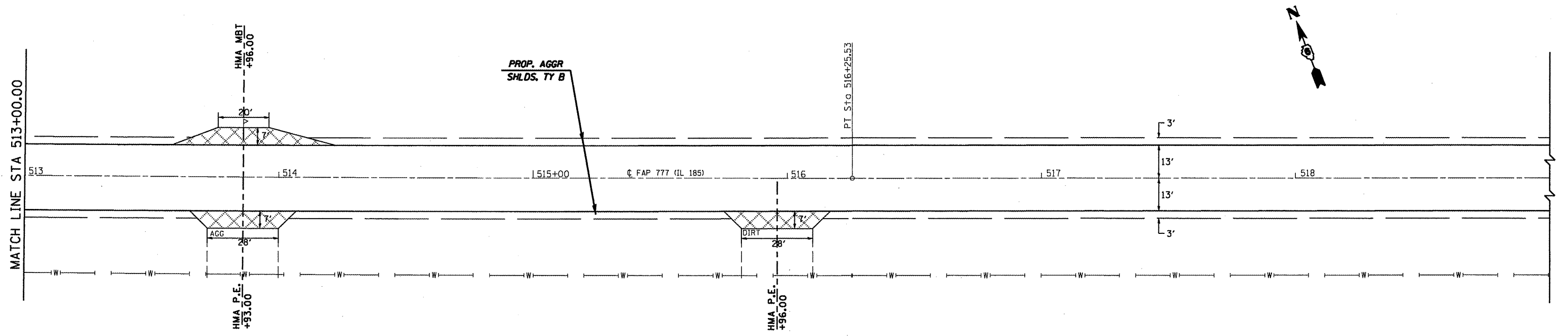
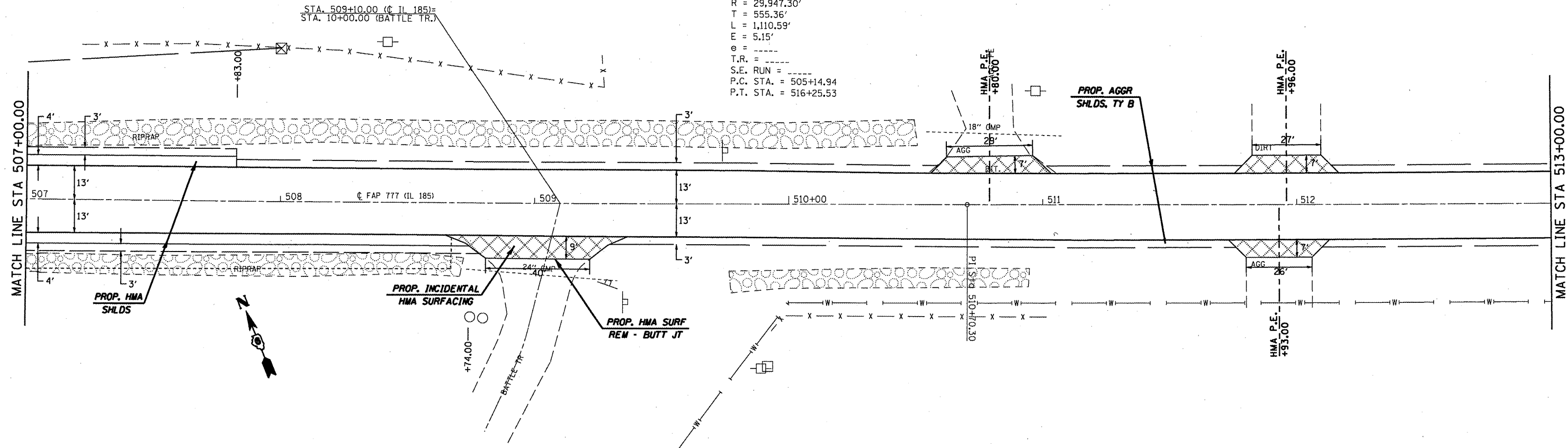

FILE NAME =	USER NAME = coxjw	DESIGNED - JWC	REVISED -
at:\pw\work\p1001\COXJW\dms22861\0672469-sht-plan21.dgn		DRAWN - JWC	REVISED -
	PLOT SCALE = 40.0000' / IN.	CHECKED - RSC	REVISED -
	PLOT DATE = Aug-13-2009 10:31:21AM	DATE - 7/10/09	REVISED -

**STATE OF ILLINOIS  
 DEPARTMENT OF TRANSPORTATION**

**PLAN SHEETS**

SCALE: 20 SHEET NO. 10 OF 27 SHEETS STA. 507+00.00 TO STA. 519+00.00

F.A.P. RTE.	SECTION	COUNTY	TOTAL SHEETS	SHEET NO.
777	10RS-5	Montgomery	54	29
CONTRACT NO. 72A68				
ILLINOIS FED. AID PROJECT				