

PAVEMENT MARKING REMOVAL

STATION TO	STATION	FOOT
670+10.00	678+10.00	808
670+10.00	678+10.00	800
670+10.00	678+10.00	200
674+71.00	677+19.00	496
TOTAL		2,304

WORK ZONE PAVEMENT MARKING REMOVAL FOR INFORMATION ONLY

STATION TO	STATION	FOOT
670+10.00	678+10.00	200
670+10.00	678+10.00	800
670+10.00	678+10.00	800
TOTAL		1800

TEMPORARY RAISED REFLECTIVE MARKER

STATION TO	STATION	EACH
672+10.00	677+60.00	12

TEMPORARY CONCRETE BARRIER

STATION TO	STATION	FOOT
675+10.00	676+89.00	175.00

IMPACT ATTENUATORS, TEMPORARY (FULLY REDIRECTIVE, NARROW), TEST LEVEL 3

STATION	EACH
676+89.00	1

TEMPORARY PAVEMENT MARKING TAPE, TYPE 3 FOR INFORMATION ONLY

STATION TO	STATION	FOOT
670+10.00	678+10.00	200
670+10.00	678+10.00	800
670+10.00	678+10.00	800
TOTAL		1800

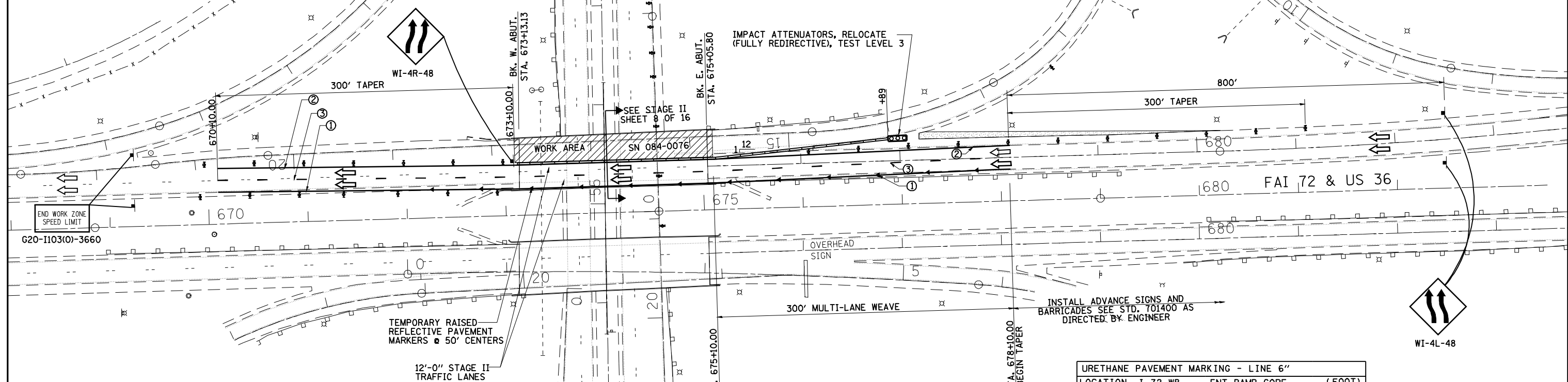

- NOTES**
- BRIDGE REHABILITATION WORK TO BE COMPLETED UTILIZING STAGE CONSTRUCTION WITH TWO LANES OF WB I-72 REMAINING OPEN TO TRAFFIC ON BRIDGE. SEE SPECIAL PROVISIONS FOR DETAILS.
 - THIS SHEET TO BE USED IN CONJUNCTION WITH TRAFFIC CONTROL & PROTECTION STANDARD 701400, 701402, AND 701451.
 - UPON COMPLETION, REMOVE ALL TRAFFIC CONTROL ITEMS IN ACCORDANCE WITH THE STANDARD SPECIFICATIONS.
 - THE USE OF METAL SIGNS ON TYPE III BARRICADES SHALL NOT BE ALLOWED, AS IT IS NOT COMPLIANT WITH NCHRP 350.

- LEGEND**
- WORK AREA
 - DIRECTION OF TRAFFIC
 - TEMPORARY PAVEMENT MARKING TAPE, TYPE 3
 - TEMPORARY CONCRETE BARRIER WITH BARRIER WALL REFLECTORS AND VERTICAL PANELS PER STD. 701402
 - TYPE I BARRICADE DRUM W/ STEADY BURN MONO DIRECTIONAL LIGHT @ 50' CENTERS U.N.O.
 - TYPE III BARRICADE

- ① TEMP. PAVT. MARKING TAPE, TYPE 3, YELLOW
- ② TEMP. PAVT. MARKING TAPE, TYPE 3, WHITE
- ③ TEMP. PAVT. MARKING TAPE, TYPE 3, WHITE (10' DASH, 30' SKIP)

URETHANE PAVEMENT MARKING - LINE 6"

LOCATION	I-72 WB	ENT RAMP GORE	(FOOT)
STA 676+71 TO STA 677+19			496
TOTAL			496

URETHANE PAVEMENT MARKING - LINE 5"

LOCATION	YELLOW SOLID (FOOT)	WHITE SOLID (FOOT)	WHITE SKIP-DASH (FOOT)
I-72 WB			
STA 670+10 TO STA 678+10	800	808	200
TOTAL			1,808

NOTE: THERE IS NOT A STAGE II FOR THIS STRUCTURE. ALL WORK CAN BE PERFORMED UNDER ONE TRAFFIC CONTROL SET UP FOR SN 084-0076.

STANDARD 701402 (SPECIAL)