

NOTE: REFERENCES TO YELLOW AND WHITE PAINT MEAN REFLECTORIZED STAGING PAVEMENT MARKING PAINT.

TEMPORARY RAISED REFLECTIVE PAVEMENT MARKERS AT 25' CENTERS SHALL BE USED IN CONJUNCTION WITH ALL REFLECTORIZED STAGING PAVEMENT MARKING PAINT AT LANE LINES AND NON-TEMPORARY CONCRETE BARRIER EDGE LINES.

REMOVE ALL EXISTING PAVEMENT MARKINGS AND TEMPORARY RAISED REFLECTIVE PAVEMENT MARKER LENSES IN CONFLICT WITH PROPOSED STAGING PAVEMENT MARKINGS PER ENGINEER.

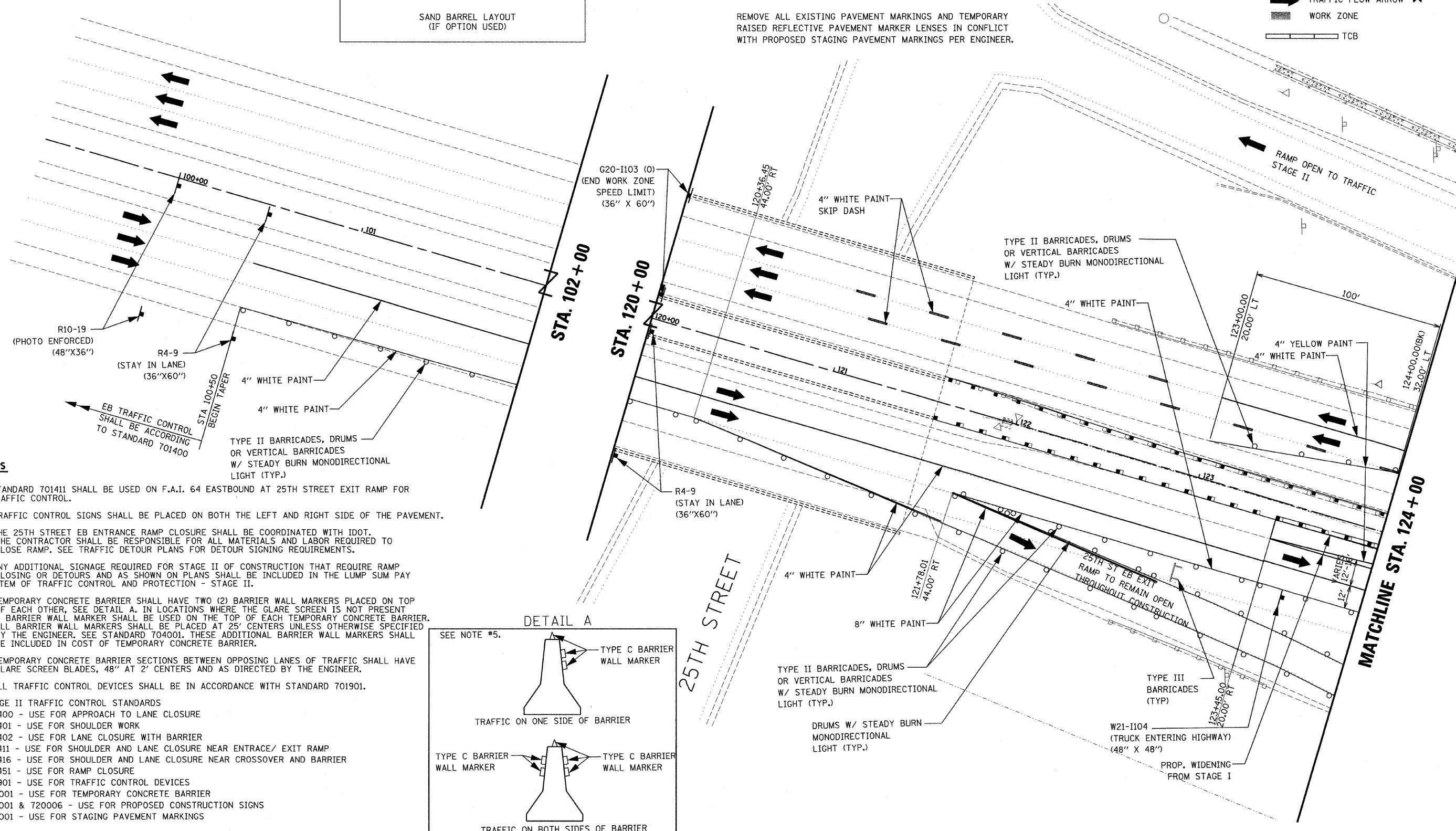
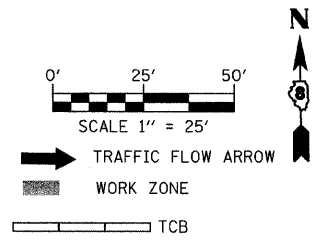

NOTES

- STANDARD 701411 SHALL BE USED ON F.A.I. 64 EASTBOUND AT 25TH STREET EXIT RAMP FOR TRAFFIC CONTROL.
- TRAFFIC CONTROL SIGNS SHALL BE PLACED ON BOTH THE LEFT AND RIGHT SIDE OF THE PAVEMENT.
- THE 25TH STREET EB ENTRANCE RAMP CLOSURE SHALL BE COORDINATED WITH IDOT. THE CONTRACTOR SHALL BE RESPONSIBLE FOR ALL MATERIALS AND LABOR REQUIRED TO CLOSE RAMP. SEE TRAFFIC DETOUR PLANS FOR DETOUR SIGNING REQUIREMENTS.
- ANY ADDITIONAL SIGNAGE REQUIRED FOR STAGE II OF CONSTRUCTION THAT REQUIRE RAMP CLOSING OR DETOURS AND AS SHOWN ON PLANS SHALL BE INCLUDED IN THE LUMP SUM PAY ITEM OF TRAFFIC CONTROL AND PROTECTION - STAGE II.
- TEMPORARY CONCRETE BARRIER SHALL HAVE TWO (2) BARRIER WALL MARKERS PLACED ON TOP OF EACH OTHER, SEE DETAIL A. IN LOCATIONS WHERE THE GLARE SCREEN IS NOT PRESENT A BARRIER WALL MARKER SHALL BE USED ON THE TOP OF EACH TEMPORARY CONCRETE BARRIER. ALL BARRIER WALL MARKERS SHALL BE PLACED AT 25' CENTERS UNLESS OTHERWISE SPECIFIED BY THE ENGINEER. SEE STANDARD 704001. THESE ADDITIONAL BARRIER WALL MARKERS SHALL BE INCLUDED IN COST OF TEMPORARY CONCRETE BARRIER.
- TEMPORARY CONCRETE BARRIER SECTIONS BETWEEN OPPOSING LANES OF TRAFFIC SHALL HAVE GLARE SCREEN BLADES, 48" AT 2' CENTERS AND AS DIRECTED BY THE ENGINEER.
- ALL TRAFFIC CONTROL DEVICES SHALL BE IN ACCORDANCE WITH STANDARD 701901.

- STAGE II TRAFFIC CONTROL STANDARDS
- 701400 - USE FOR APPROACH TO LANE CLOSURE
 - 701401 - USE FOR SHOULDER WORK
 - 701402 - USE FOR LANE CLOSURE WITH BARRIER
 - 701411 - USE FOR SHOULDER AND LANE CLOSURE NEAR ENTRANCE/ EXIT RAMP
 - 701416 - USE FOR SHOULDER AND LANE CLOSURE NEAR CROSSOVER AND BARRIER
 - 701451 - USE FOR RAMP CLOSURE
 - 701901 - USE FOR TRAFFIC CONTROL DEVICES
 - 704001 - USE FOR TEMPORARY CONCRETE BARRIER
 - 720001 & 720006 - USE FOR PROPOSED CONSTRUCTION SIGNS
 - 780001 - USE FOR STAGING PAVEMENT MARKINGS

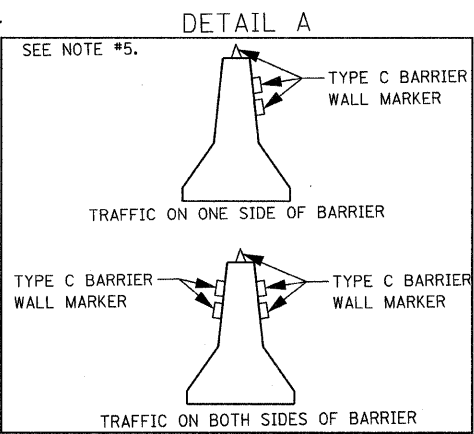

FILE NAME =	USER NAME = jheger	DESIGNED - DRB	REVISED -	STATE OF ILLINOIS DEPARTMENT OF TRANSPORTATION	TRAFFIC CONTROL PLAN - STAGE II	F.A.I. RTE. =	SECTION	COUNTY	TOTAL SHEETS	SHEET NO.
P:\0606015\den\CADD Sheets\0876876-sh-taging-008.dgn	DRAWN - MLS	REVISED -	64			82-2VB-2	ST. CLAIR	153	27	
PLOT SCALE = 25.0000' / IN.	CHECKED - SJK	REVISED -	CONTRACT NO. 76867							
PLOT DATE = 8/7/2009	DATE -	REVISED -	FED. ROAD DIST. NO. 8 ILLINOIS FED. AID PROJECT							
SCALE: 1/25		SHEET NO. 8 OF 22 SHEETS				STA. 99+25 TO STA. 124+00				