

NOTES:

SUB-BASE SHALL BE PLACED WITHIN 24 HOURS OF SHOULDER REMOVAL TO PREVENT EROSION. IF SUB-BASE IS UNABLE TO BE PLACED PRIOR TO RAINFALL, THE CONTRACTOR SHALL PERFORM EROSION CONTROL MEASURES AND NEEDED CLEAN UP AT HIS/HER EXPENSE.

CONTRACTOR SHALL PLACE EROSION CONTROL AS REQUIRED. SEE STAGING PLANS FOR SEQUENCE OF CONSTRUCTION EVENTS.



ALL INLET & PIPE PROTECTION AND TEMPORARY DITCH CHECKS SHALL BE INSTALLED WITHIN STAGE I. ALL EROSION BARRIER SHALL BE INSTALLED WITHIN STAGES II & III.

ALL DITCH CHECKS SHALL CONSIST OF ROLLED EXCELSIOR OR URETHANE FOAM/GEOTEXTILE AND SHALL BE REMOVED UPON COMPLETION OF THE PROJECT.

DIMENSIONS ARE GIVEN FOR APPROXIMATE WIDTHS OF EROSION CONTROL BLANKET. ACTUAL DIMENSIONS AND QUANTITIES TO BE DETERMINED IN THE FIELD.

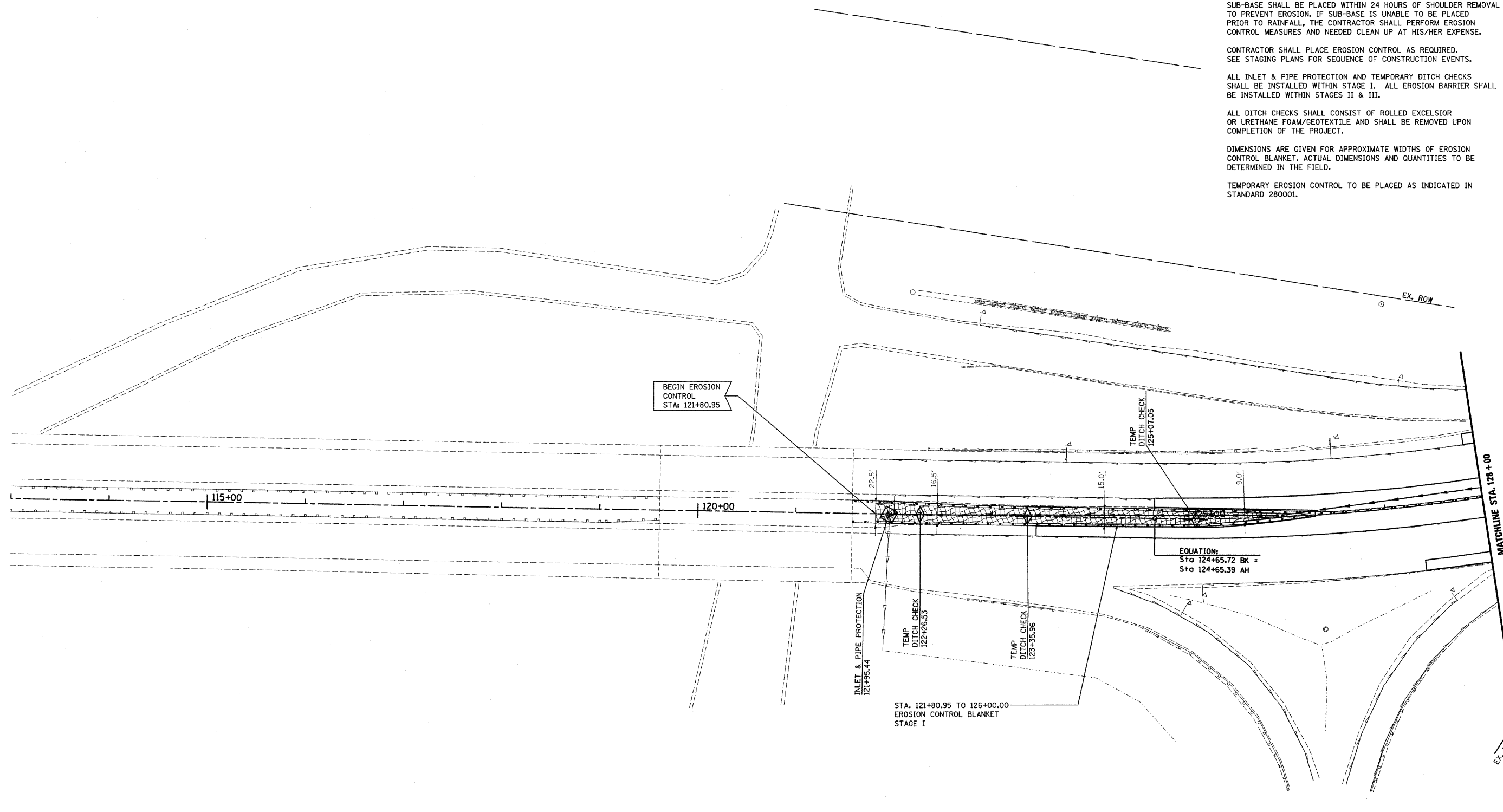
TEMPORARY EROSION CONTROL TO BE PLACED AS INDICATED IN STANDARD 280001.

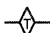

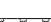
-  TEMPORARY DITCH CHECK
-  INLET & PIPE PROTECTION
-  EROSION CONTROL BLANKET
-  PERIMETER EROSION BARRIER

FILE NAME =	USER NAME = mschwier.john	DESIGNED - DRB	REVISED -	<b>STATE OF ILLINOIS DEPARTMENT OF TRANSPORTATION</b>	<b>EROSION AND SEDIMENT CONTROL</b>			F.A.I. RTE.	SECTION	COUNTY	TOTAL SHEETS	SHEET NO.
P:\0606019\dgn\CADD Sheets\0876876-sh1	eros-201.dgn	DRAWN - MLS	REVISED -		64	82-2VB-2	ST. CLAIR	153	42			
PLOT SCALE = 50.0000' / IN.	CHECKED - SJK	REVISIED -	REVISED -		CONTRACT NO. 76867							
PLOT DATE = 8/7/2009	DATE -	REVISED -	REVISED -		SCALE: 1:50	SHEET NO. 1 OF 3 SHEETS	STA. 121+80.95 TO STA. 128+00.00	FED. ROAD DIST. NO. 8 ILLINOIS FED. AID PROJECT				