

EAST SIDE:  
 E.B. TRANSITION PAVEMENT PLAN

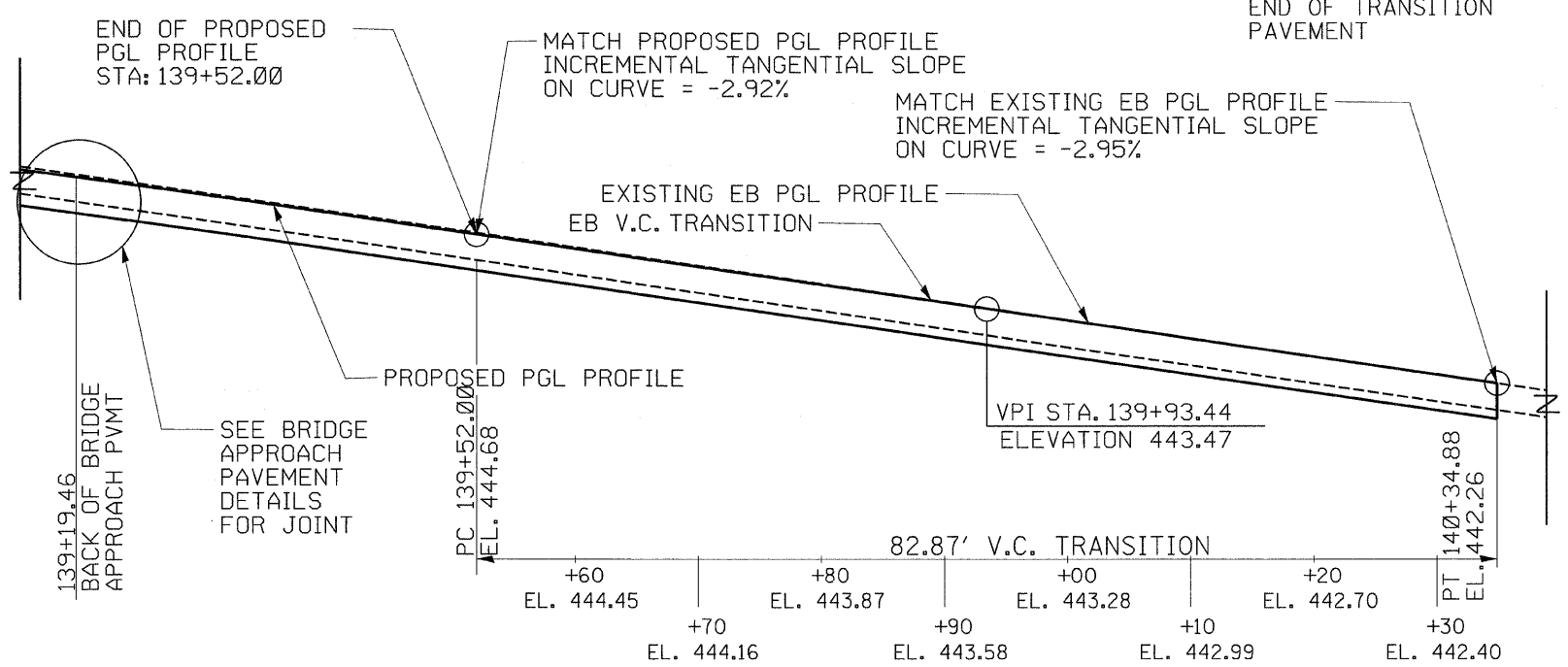

EAST SIDE:  
 E.B. TRANSITION PAVEMENT PROFILE

PROFILE: NOT TO SCALE

\*BACK OF BRIDGE APPROACH PAVEMENT

EAST SIDE: EB TRANSITION PAVT EOS LINE (A)			
POINT #	STATION (I-64)	OFFSET FT. (LT/RT)	ELEV.
*	138+79.78	14.33' RT	446.35
1	138+90.00	13.95' RT	446.17
2	139+00.00	13.58' RT	445.90
3	139+10.00	13.21' RT	445.61
4	139+20.00	12.84' RT	445.33
5	139+30.00	12.47' RT	445.03
6	139+40.00	12.10' RT	444.70
7	139+50.00	12.00' RT	444.43
8	139+60.00	12.00' RT	444.16
9	139+70.00	12.00' RT	443.88
10	139+80.00	12.00' RT	443.63
11	139+90.00	12.00' RT	443.38
12	140+00.00	12.00' RT	443.15
13	140+10.00	12.00' RT	442.90
14	140+20.00	12.00' RT	442.61
15	140+30.00	12.00' RT	442.34
16	140+34.88	12.00' RT	442.21

EAST SIDE: EB TRANSITION PAVT EOP LINE (B)			
POINT #	STATION (I-64)	OFFSET FT. (LT/RT)	ELEV.
*	138+92.51	20.00' RT	446.15
2	139+00.00	20.00' RT	445.95
3	139+10.00	20.00' RT	445.69
4	139+20.00	20.00' RT	445.42
5	139+30.00	20.00' RT	445.14
6	139+40.00	20.00' RT	444.86
7	139+50.00	20.00' RT	444.56
8	139+60.00	20.00' RT	444.30
9	139+70.00	20.00' RT	444.05
10	139+80.00	20.00' RT	443.81
11	139+90.00	20.00' RT	443.56
12	140+00.00	20.00' RT	443.31
13	140+10.00	20.00' RT	443.06
14	140+20.00	20.00' RT	442.81
15	140+30.00	20.00' RT	442.56
16	140+34.88	20.00' RT	442.44

EAST SIDE: EB TRANSITION PAVT PGL LINE (C)			
POINT #	STATION (I-64)	OFFSET FT. (LT/RT)	ELEV.
*	139+19.46	32.00' RT	445.61
4	139+20.00	32.00' RT	445.60
5	139+30.00	32.00' RT	445.32
6	139+40.00	32.00' RT	445.04
7	139+50.00	32.00' RT	444.74
8	139+60.00	32.00' RT	444.45
9	139+70.00	32.00' RT	444.16
10	139+80.00	32.00' RT	443.87
11	139+90.00	32.00' RT	443.58
12	140+00.00	32.00' RT	443.29
13	140+10.00	32.00' RT	442.99
14	140+20.00	32.00' RT	442.70
15	140+30.00	32.00' RT	442.41
16	140+34.88	32.00' RT	442.27

EAST SIDE: EB TRANSITION PAVT LANE LINE (D)			
POINT #	STATION (I-64)	OFFSET FT. (LT/RT)	ELEV.
*	139+46.50	44.00' RT	444.66
7	139+50.00	44.00' RT	444.56
8	139+60.00	44.00' RT	444.27
9	139+70.00	44.00' RT	443.97
10	139+80.00	44.00' RT	443.67
11	139+90.00	44.00' RT	443.37
12	140+00.00	44.00' RT	443.07
13	140+10.00	44.00' RT	442.77
14	140+20.00	44.00' RT	442.47
15	140+30.00	44.00' RT	442.17
16	140+34.88	44.00' RT	442.02

EAST SIDE: EB TRANSITION PAVT EOP LINE (E)			
POINT #	STATION (I-64)	OFFSET FT. (LT/RT)	ELEV.
*	139+74.79	56.00' RT	443.59
10	139+80.00	56.00' RT	443.44
11	139+90.00	56.00' RT	443.14
12	140+00.00	56.00' RT	442.85
13	140+10.00	56.00' RT	442.55
14	140+20.00	56.00' RT	442.26
15	140+30.00	56.00' RT	441.96
16	140+34.88	56.00' RT	441.82

EAST SIDE: EB TRANSITION PAVT EOS LINE (F)			
POINT #	STATION (I-64)	OFFSET FT. (LT/RT)	ELEV.
*	139+87.43	61.19' RT	443.11
11	139+90.00	61.21' RT	442.97
12	140+00.00	61.22' RT	442.71
13	140+10.00	61.49' RT	442.44
14	140+20.00	61.97' RT	442.14
15	140+30.00	62.42' RT	441.83
16	140+34.88	62.60' RT	441.20