

BENCH MARK

BM 303 RR Spike In PP No. 2360
Station 11+948.5 4.04m Rt.
Elev. = 234.372

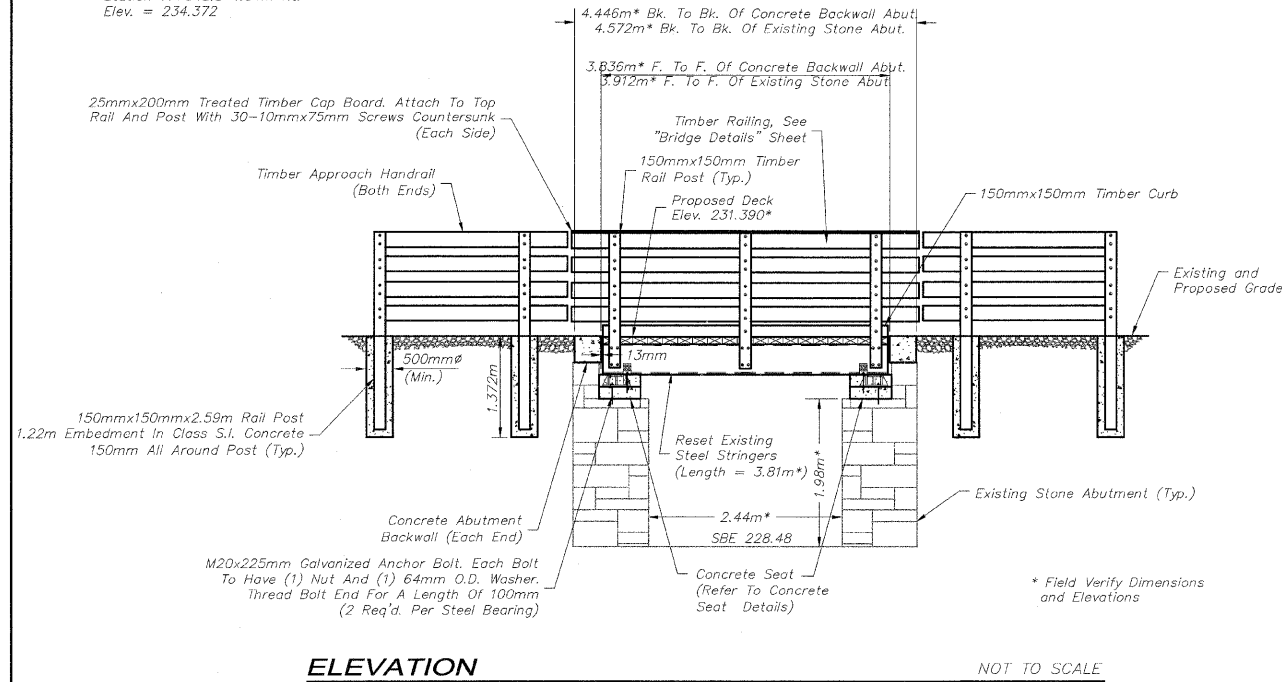

ELEVATION

NOT TO SCALE

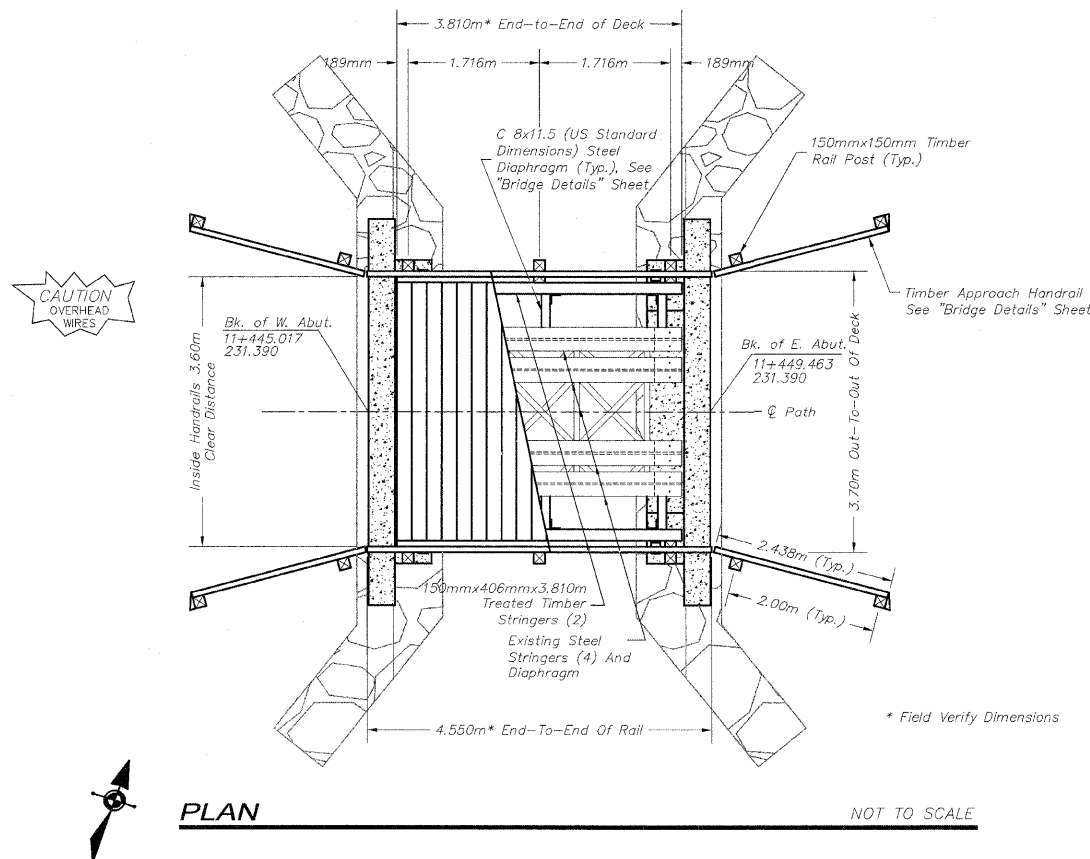

PLAN

NOT TO SCALE

BRIDGE 104 NOTES

- REFER TO "BRIDGE GENERAL NOTES" SHEET FOR ADDITIONAL TIMBER BRIDGE GENERAL NOTES.
- THE CONTRACTOR SHALL REMOVE ALL ELEMENTS OF THE EXISTING TIMBER DECKING AND PROPERLY DISPOSE OF OFF-SITE. THIS INCLUDES THE TRANSVERSE RAILROAD TIES, TIMBER WALKWAY, STEEL ANGLE RAIL POSTS AND CABLE, TIMBER BEARING SUPPORTS, AND ANY OTHER ITEMS AS APPLICABLE TO THE EXISTING TIMBER DECKING. ALL ITEMS TO BE REMOVED SHALL BE DISPOSED OF IN CONFORMANCE WITH THE REQUIREMENTS OF SECTION 202.03 OF THE 100T STANDARD SPECIFICATIONS. ALL MATERIAL AND LABOR NECESSARY TO COMPLETE THIS ITEM OF WORK SHALL BE INCLUDED IN THE CONTRACT UNIT PRICE FOR REMOVAL OF EXISTING SUPERSTRUCTURE WITH NO ADDITIONAL COMPENSATION ALLOWED.
- THE INTENT OF THE PLAN IS TO REUSE/RESET THE EXISTING S 18x54.7 (US STANDARD DIMENSIONS) STEEL STRINGERS AS AN ASSEMBLY AFTER MODIFYING THE EXISTING ABUTMENTS. THE ASSEMBLY INCLUDES THE EXISTING STEEL STRINGERS WITH THE CONNECTED DIAPHRAGMS AND STEEL BEARINGS. THE CONTRACTOR SHALL TAKE THE NECESSARY PRECAUTIONS SO AS NOT TO CAUSE DAMAGE WHEN REMOVING THE EXISTING STEEL STRINGER ASSEMBLIES. THE CONTRACTOR WILL BE RESPONSIBLE FOR THE REPAIR OR REPLACEMENT OF ANY ITEM DAMAGED WITH NO ADDITIONAL COMPENSATION ALLOWED. CONTRACTOR SHALL COORDINATE THE SCHEDULE OF THIS WORK WITH THE ENGINEER TO ALLOW FOR DETAILED INSPECTION OF THE STEEL STRINGER ASSEMBLIES IF REQUIRED. ALL MATERIAL AND LABOR NECESSARY TO COMPLETE THIS ITEM OF WORK SHALL BE INCLUDED IN THE CONTRACT UNIT PRICE FOR REMOVE AND RESET EXISTING STEEL STRINGER ASSEMBLIES AND SHALL BE MEASURED AS ONE (1) UNIT EACH PER BRIDGE AS APPLICABLE.
- CONTRACTOR SHALL REMOVE ANY LOOSE OR DETERIORATED MORTAR FROM THE EXISTING MASONRY LIMESTONE ABUTMENT JOINTS, CLEAN, AND TUCK POINT IN ACCORDANCE WITH THE CONTRACT SPECIAL PROVISIONS. THIS WORK WILL BE PAID FOR AS LUMP SUM AT THE CONTRACT UNIT PRICE FOR MASONRY CLEANING & TUCKPOINTING.
- ALL TREE REMOVAL AND SELECTIVE BRUSH CLEARING SHALL BE IN ACCORDANCE WITH THE PLANS AND SPECIAL PROVISIONS OR AS DIRECTED BY THE ENGINEER. TREE REMOVAL AND SELECTIVE CLEARING WILL BE MEASURED AND PAID FOR AT THE CONTRACT UNIT PRICE FOR THE APPROPRIATE ITEM.
- CONTRACTOR SHALL FURNISH AND INSTALL A BRASS NAME PLATE IN ACCORDANCE WITH SECTION 515 OF THE 100T STANDARD SPECIFICATIONS EXCEPT THAT IT SHALL BE INSTALLED WITH FOUR (4) TAMPER RESISTANT SCREWS TO THE TOP TIMBER BRIDGE RAIL ON THE RIGHTHAND SIDE OF APPROACH END WHILE LOOKING IN THE DIRECTION OF INCREASING STATIONING. THE PLATE SHALL BE MADE OF SOLID BRASS 3mm THICK WITH IMPRINTED STAMP LETTERING 6mm HIGH. THIS ITEM WILL BE MEASURED AND PAID FOR AT THE CONTRACT UNIT PRICE EACH FOR NAME PLATES.

DESIGN LOADING

MS9 (H-10)
4.07 KN/M² (85 psf)

DESIGN STRESSES

f'c = 24 MPa
Reinforcing fy = 420 MPa
Fasteners fy = 250 MPa
Diaphragm Steel fy = 345 MPa
Structural Timber Fb = 9.3 MPa
Structural Timber Fv = 1.14 MPa

DESIGN SPECIFICATIONS

2002 AASHTO Standard Specifications - 17th Edition

SEISMIC DATA

Seismic Performance Category (SPC) = A
Bedrock Acceleration Coefficient (4) = 3.15%
Site Coefficient(s) = 1.0

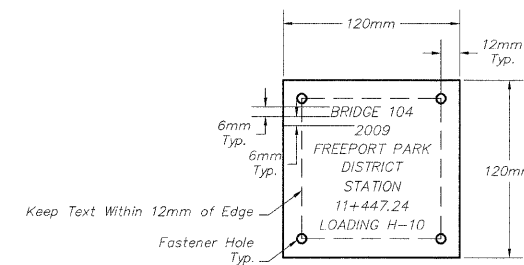

NAME PLATE

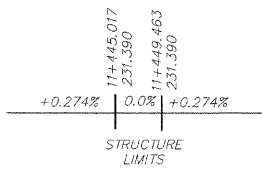

PROFILE GRADE

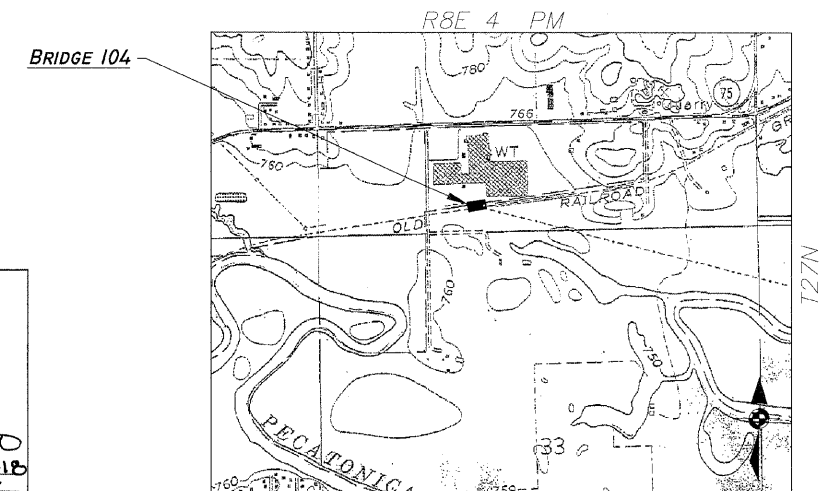

LOCATION SKETCH

BILL OF MATERIALS - BRIDGE 104

ITEM	UNIT	QUANTITY
REMOVE & RESET EXISTING STEEL STRINGER ASSEMBLIES	EA	1
REMOVAL OF EXISTING SUPERSTRUCTURE	EA	1
CONCRETE STRUCTURES	CM	2.4
REINFORCEMENT BARS	Kg	236
TREATED TIMBER	CM	3.0
HARDWARE	Kg	126
WOOD RAIL	M	10
DRILL AND GROUT BARS	EA	156
ANCHOR BOLTS, M20	EA	20
MASONRY CLEANING & TUCKPOINTING	LS	1
NAME PLATE, SPECIAL	EA	1
MONODIRECTIONAL PRISMATIC BARRIER REFLECTORS	EA	12
POROUS GRANULAR EMBANKMENT	CM	5

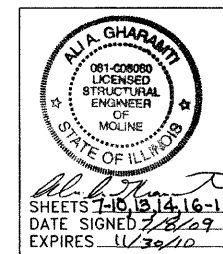

GENERAL PLAN & ELEVATION
OVER A TRIBUTARY DITCH TO
THE PECATONICA RIVER
SECTION 09-P4000-00-BT
STEPHENSON COUNTY
STATION 11+447.24

REVISIONS

NO.	ITEM	DATE

PLOTTING SCALE: 1 : 1

DRAWN BY: FLH/CDS

CHECKED BY:

DATE: JUNE, 2009



7282 Argus Drive Rockford, Illinois 61107-5837
(815) 398-2332 FAX (815) 398-2496
Design Firm License: Illinois 184-000816
Copyright 2009 By McClure Engineering Associates, Inc.

BRIDGE NO. 104 STA. 11+447.24

PECATONICA PRAIRIE PATH

STEPHENSON COUNTY

SECTION 09-P4000-00-BT

JOB NUMBER: 04-28-98-037

SHEET NO.

13
OF
26