

TAZWELL CO. LINE
T.R. #1- 1100 N.

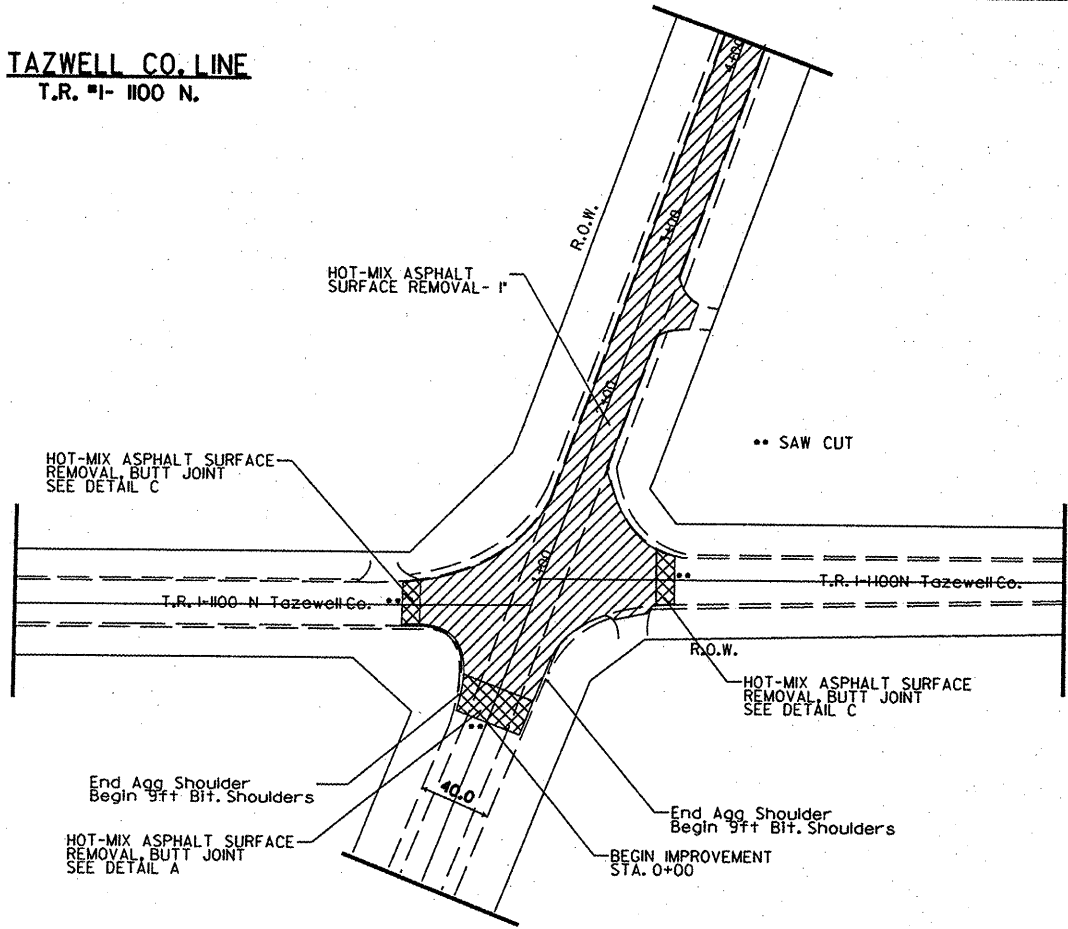

STATE RTE. 116 INTERSECTION
STA. 157+00 - 165+69

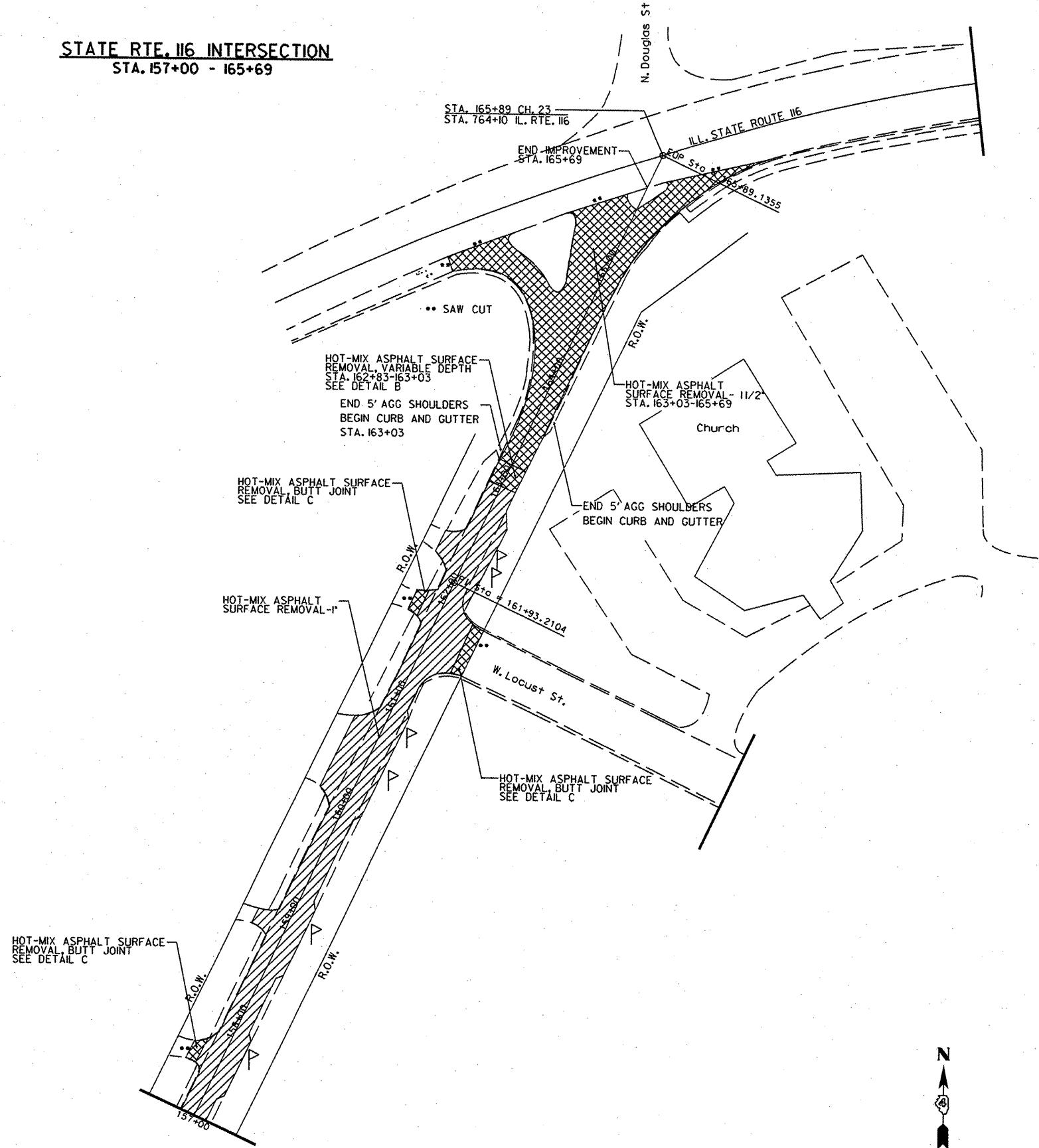

T.R. #145 - 1200 N.

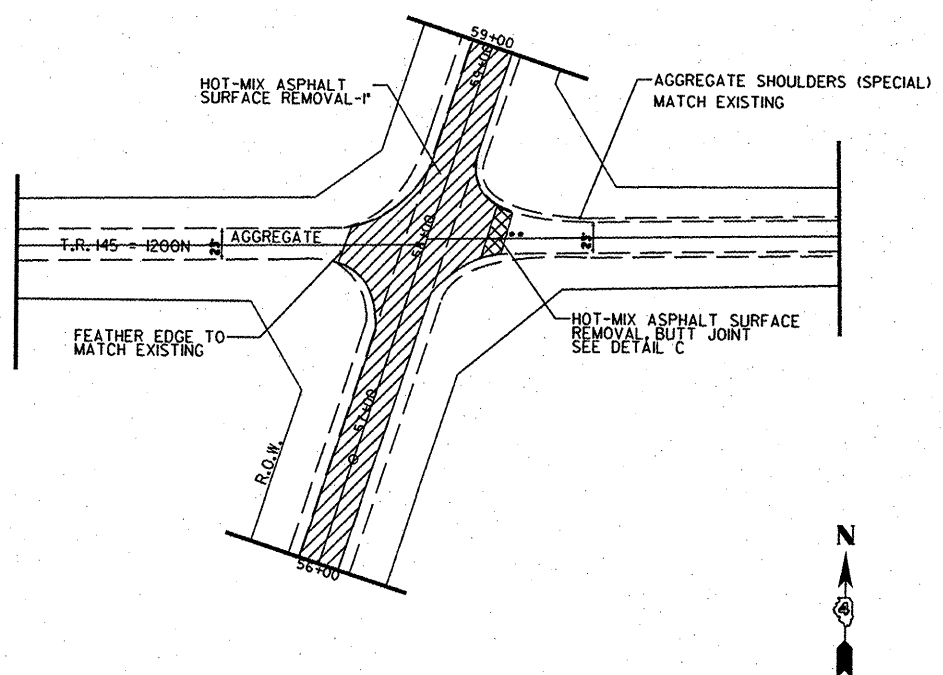

FILE NAME *	USER NAME *	DESIGNED - DDB	REVISED -
*FILE#		DRAWN - BJH	REVISED -
PLOT SCALE *		CHECKED - DDB	REVISED -
PLOT DATE *		DATE - 8/6/2009	REVISED -

WOODFORD COUNTY HIGHWAY DEPARTMENT
301 S. Main St.
Rooanoke, IL 61561
TEL: 309-923-2891
FAX: 309-923-7928

PLAN SHEET
C.H. #23 DOUGLAS ROAD RD.
SCALE: _____ SHEET NO. 5 OF 5 SHEETS STA. _____ TO STA. _____

F.A.S. RTE.	SECTION	COUNTY	TOTAL SHEETS	SHEET NO.
367	01-00100-00-RS	WOODFORD	5	5
CONTRACT NO. 89539			ILLINOIS FED. AID PROJECT	