

ROUTE NO.	SECTION	COUNTY	TOTAL SHEETS	SHEET NO.
MONTICELLO RD, CH 18 (FAS 531)	07-00419-00-RS	CHAMPAIGN	162	15
STA.	TO STA.			
F.H.W.A. REG.	ILLINOIS	PROJECT	ARA-HSIP-531(108)	

PARCEL 52
 PIN: 29-26-07-400-003
 OWNER/S: MELBA L. SMITH
 W/2 SE/4 LESS EXCEPTION &
 E/2 SE/4 LESS EXCEPTION
 SEC. 7, T18N, R8E, 3RD PM

PARCEL 54
 29-26-07-400-004
 OWNER/S: JOHN C. SMITH
 METES & BOUNDS
 PT. SW/4, SE/4
 SEC. 7, T18N, R8E, 3RD PM

PARCEL 52
 PIN: 29-26-07-400-003
 OWNER/S: JOHN A. SMITH TRUST,
 MELBA L. SMITH, SOLE TTEE
 W/2 SE/4 LESS EXCEPTION &
 E/2 SE/4 LESS EXCEPTION
 SEC. 7, T18N, R8E, 3RD PM

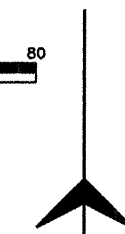

MATCHLINE STA. 447.00 SEE SHEET 14 FOR CONTINUATION

MATCHLINE STA. 459.00 SEE SHEET 16 FOR CONTINUATION

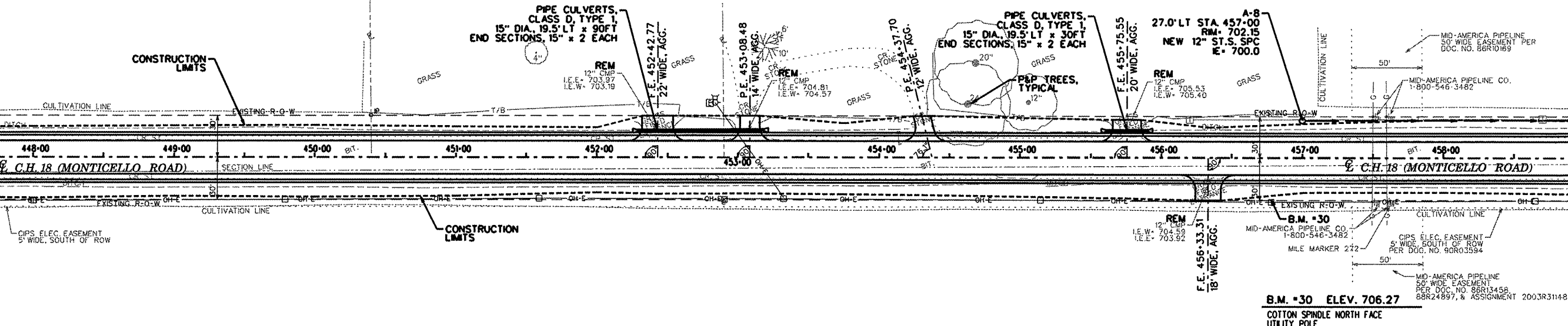

PARCEL 50
 PIN: 29-26-18-200-006
 OWNER/S: PORTIA A. SMITH TRUST,
 PORTIA A. SMITH, TTEE
 C/O HERTZ FARM MGT.
 E/2 NW/4 & W/2 NE/4, & E/2, NE/4,
 SEC. 18, T18N, R8E, 3RD PM

