

ROUTE NO.	SECTION	COUNTY	TOTAL SHEETS	SHEET NO.
MONTICELLO RD. CH 18 (FAS 531)	07-00419-00-RS	CHAMPAIGN	162	26
STA. TO STA.				
F.H.W.A. REG.	ILLINOIS PROJECT	ARA-HSP-53(10B)		

PARCEL 78
 PIN: 29-26-10-300-006
 OWNER/S: JOHN W. FISHER
 & JANICE L. FISHER
 W/2, SW/4, SEC. 10, T18N,
 R8E, 3RD PM

PARCEL 80
 PIN: 29-26-10-400-004
 OWNER/S: JOHN W. & JANICE L. FISHER
 S/2, SE/4, SEC. 10, T18N, R8E, 3RD PM

PARCEL 79
 PIN: 29-26-15-100-001
 OWNER/S: DORIS J. MILLER
 W/2, NW/4, SEC. 15, T18N,
 R8E, 3RD PM

PARCEL 81
 PIN: 29-26-15-100-004
 OWNER/S: DORIS J. MILLER
 E/2, NW/4, SEC. 15, T18N,
 R8E, 3RD PM

MATCHLINE STA. 579-00 SEE SHEET 25 FOR CONTINUATION

MATCHLINE STA. 591-00 SEE SHEET 27 FOR CONTINUATION

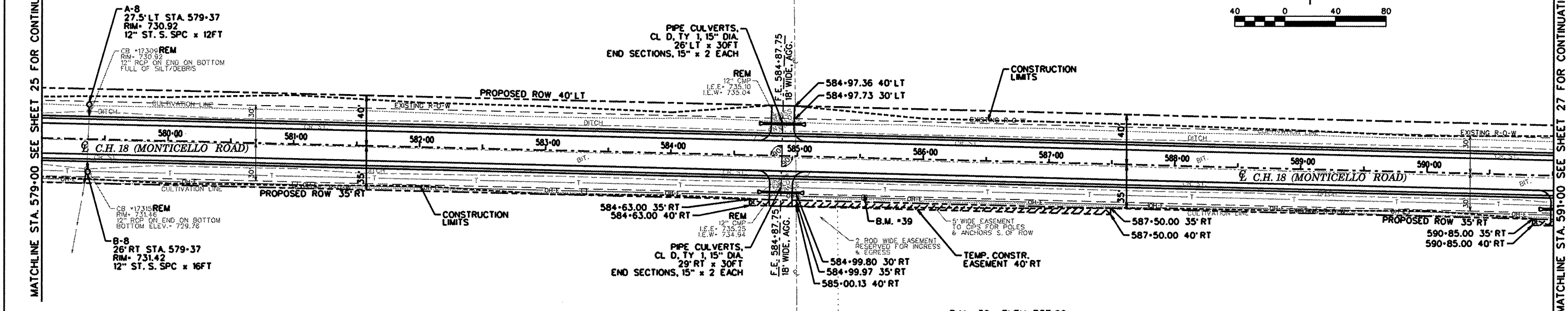
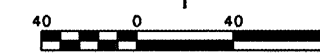

PP41.dgn 8/20/2009 4:16:06 PM