

SEC. 14, T.19N., R.8E., 3rd P.M.  
CHAMPAIGN COUNTY, ILLINOIS

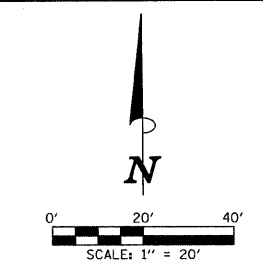
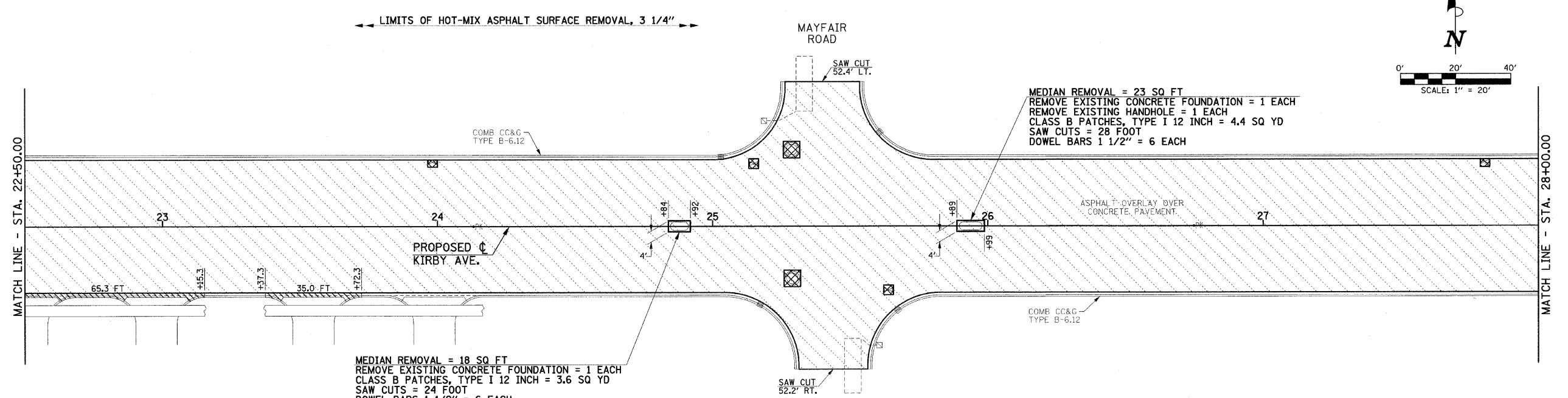

**LEGEND**

- HOT-MIX ASPHALT SURFACE REMOVAL, 3 1/4"
- COMBINATION CURB AND GUTTER REMOVAL
- CLASS B PATCHES, TYPE II, 12 INCH
- PAVEMENT PATCHING SPECIAL (SEE DETAIL)

SEC. 23, T.19N., R.8E., 3rd P.M.  
CHAMPAIGN COUNTY, ILLINOIS

SEC. 14, T.19N., R.8E., 3rd P.M.  
CHAMPAIGN COUNTY, ILLINOIS

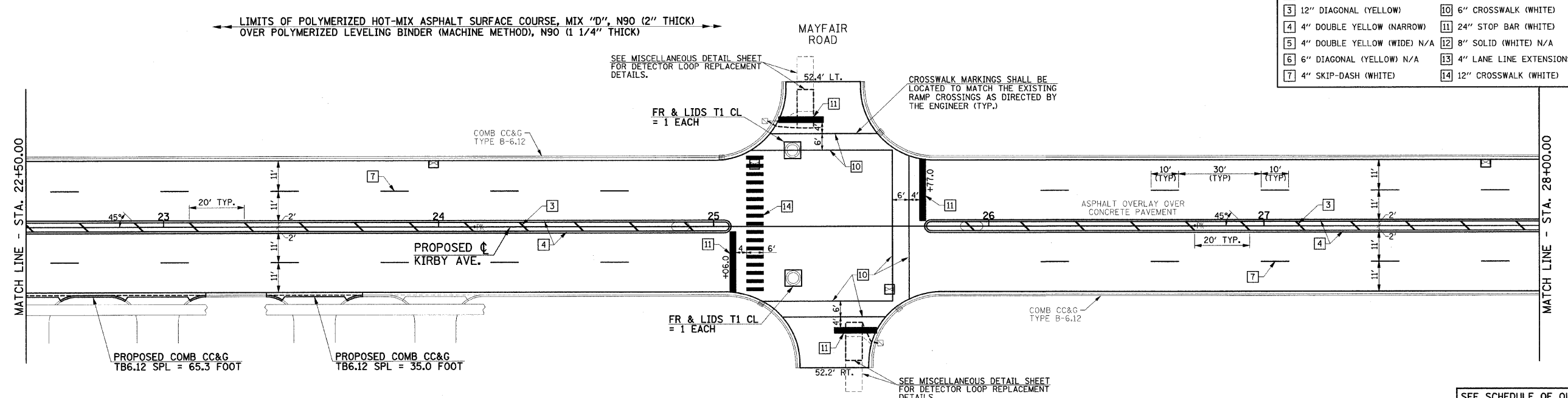

**TYPICAL PAVEMENT MARKING LEGEND**

1 4" SKIP-DASH (YELLOW)	8 4" SOLID (WHITE)
2 4" SOLID (YELLOW)	9 12" DIAGONAL (WHITE) N/A
3 12" DIAGONAL (YELLOW)	10 6" CROSSWALK (WHITE)
4 4" DOUBLE YELLOW (NARROW)	11 24" STOP BAR (WHITE)
5 4" DOUBLE YELLOW (WIDE) N/A	12 8" SOLID (WHITE) N/A
6 6" DIAGONAL (YELLOW) N/A	13 4" LANE LINE EXTENSIONS (WHITE) N/A
7 4" SKIP-DASH (WHITE)	14 12" CROSSWALK (WHITE)

SEE SCHEDULE OF QUANTITIES AND MISCELLANEOUS DETAILS SHEET FOR ADDITIONAL INFORMATION.

SEC. 23, T.19N., R.8E., 3rd P.M.  
CHAMPAIGN COUNTY, ILLINOIS

FILE NAME = p:\c0010470\plans\sheets\kirbyplan.dgn  
PLOT DATE = 7/16/2009 10:44:38 AM

DESIGNED - R.L.H.	REVISED -
DRAWN - J.L.B.	REVISED -
CHECKED - J.T.P.	REVISED -
DATE - 6-09	REVISED -

STATE OF ILLINOIS  
DEPARTMENT OF TRANSPORTATION

PLAN - KIRBY AVENUE

SCALE: 1"=20' SHEET NO. 14 OF 27 SHEETS STA. 22+50.00 TO STA. 28+00.00

F.A.U. RTE.	SECTION	COUNTY	TOTAL SHEETS	SHEET NO.
7138	09-00281-00-RS	CHAMPAIGN	27	14
FED. ROAD DIST. NO. ILLINOIS			CONTRACT NO. 91408	
FED. AID PROJECT ARA-5181 (046)				