

FRAME REMOVAL DETAIL

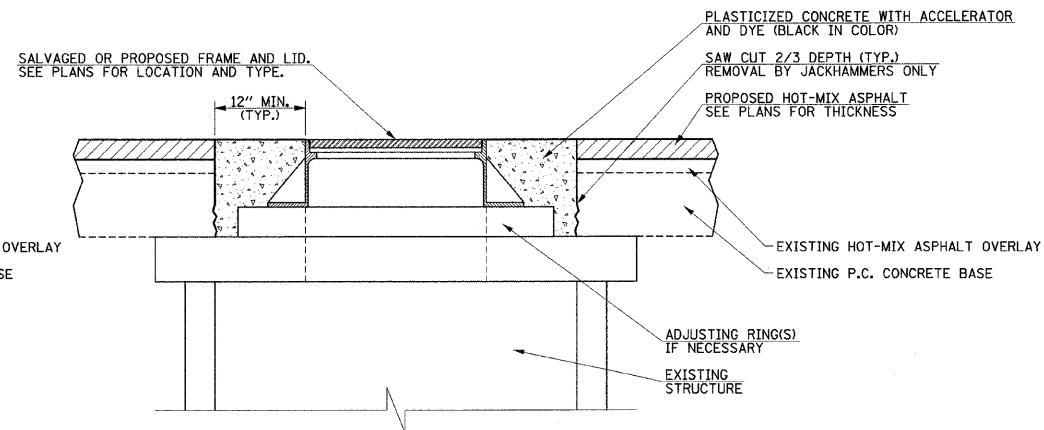

FINAL ADJUSTMENT DETAIL

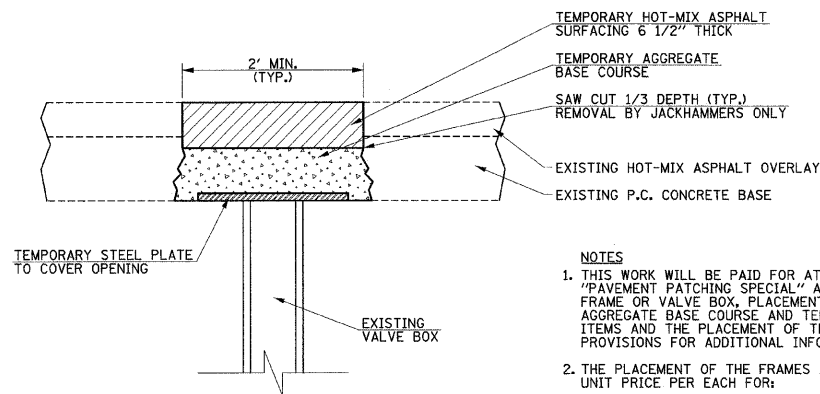

VALVE BOX REMOVAL DETAIL

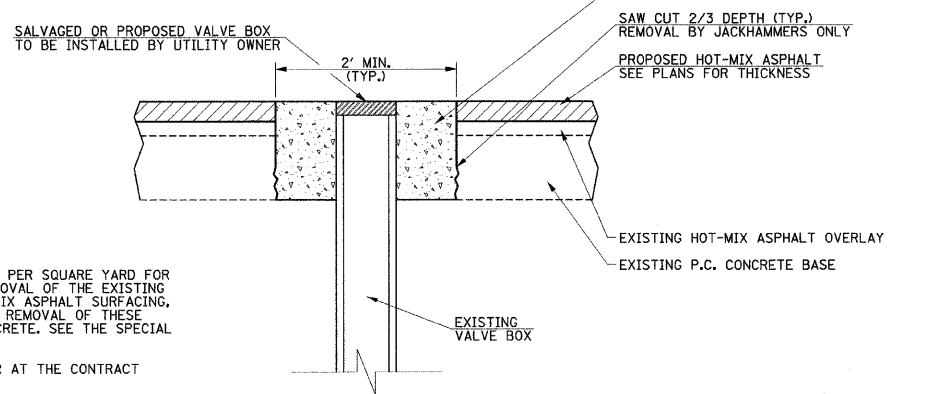

FINAL ADJUSTMENT DETAIL

- NOTES**
- THIS WORK WILL BE PAID FOR AT THE CONTRACT UNIT PRICE PER SQUARE YARD FOR "PAVEMENT PATCHING SPECIAL" AND SHALL INCLUDE THE REMOVAL OF THE EXISTING FRAME OR VALVE BOX, PLACEMENT OF THE TEMPORARY HOT-MIX ASPHALT SURFACING, AGGREGATE BASE COURSE AND TEMPORARY STEEL PLATE, THE REMOVAL OF THESE ITEMS AND THE PLACEMENT OF THE PLASTICIZED BLACK CONCRETE. SEE THE SPECIAL PROVISIONS FOR ADDITIONAL INFORMATION.
 - THE PLACEMENT OF THE FRAMES AND LIDS WILL BE PAID FOR AT THE CONTRACT UNIT PRICE PER EACH FOR:
 - FRAMES AND LIDS, TYPE 1, OPEN LID
 - FRAMES AND LIDS, TYPE 1, CLOSED LID
 - FRAMES AND LIDS, SPECIAL
 - FRAMES AND LIDS (SALVAGED)
 WHICH PRICE SHALL INCLUDE ANY ADJUSTMENT RINGS NECESSARY.
 - THE CONTRACTOR WILL BE RESPONSIBLE FOR COORDINATING WITH THE UTILITY OWNERS FOR INSTALLATION OF THE VALVE BOXES. THE COST OF COORDINATING WITH THE UTILITY OWNERS WILL NOT BE PAID FOR SEPARATELY AND SHALL BE INCLUDED IN THE COST OF THE PATCHES.

PAVEMENT PATCHING SPECIAL DETAIL

NO SCALE

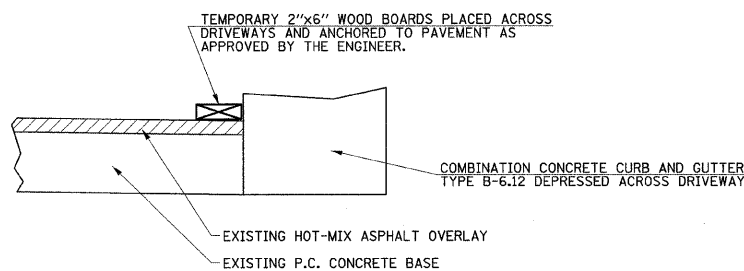

OPTION 1

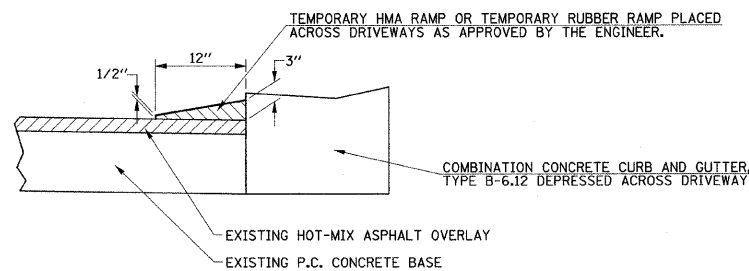

OPTION 2

- NOTES**
- THE TEMPORARY RAMPS, SPECIAL SHALL BE PLACED ADJACENT TO GUTTERS AT DRIVEWAY OPENINGS TO ALLOW FOR TEMPORARY ACCESS AFTER THE PAVEMENT HAS BEEN MILLED. THE RAMPS SHALL BE INSTALLED WHERE DROP-OFFS FROM THE TOP OF THE GUTTER TO TOP OF THE PAVEMENT EXCEED 1 1/2".
 - THE CONTRACTOR MAY USE OPTION 1 OR 2. THE CONTRACTOR MAY ALSO PROVIDE OTHER METHODS FOR PROVIDING TEMPORARY RAMPS, BUT THEY MUST BE APPROVED BY THE ENGINEER PRIOR TO BEGINNING THE WORK.
 - THE RAMPS SHALL BE REMOVED IMMEDIATELY PRIOR TO THE PLACEMENT OF THE HOT-MIX ASPHALT MATERIALS.
 - THE TEMPORARY RAMPS, SPECIAL WILL BE PAID FOR AT THE CONTRACT UNIT PRICE EACH FOR EACH DRIVEWAY LOCATION. NO ADDITIONAL PAYMENT WILL BE ALLOWED FOR THE VARYING LENGTHS OF DRIVEWAY OPENINGS. THE WORK SHALL INCLUDE INSTALLING, MAINTAINING AND REMOVING THE RAMPS.

TEMPORARY RAMP, SPECIAL DETAIL

NO SCALE

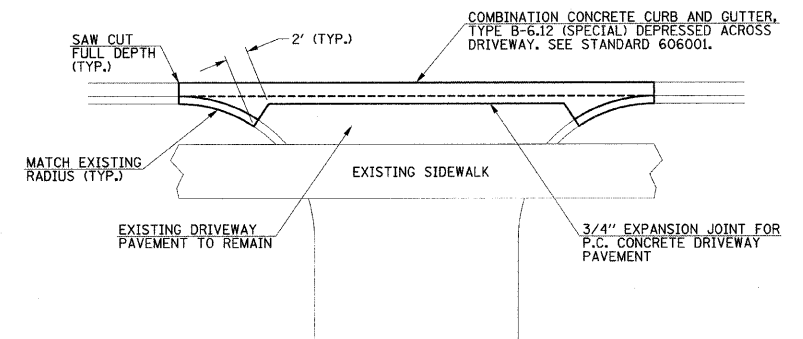

- NOTES**
- THE COMBINATION CONCRETE CURB AND GUTTER, TYPE B-6.12 (SPECIAL) SHALL BE IN ACCORDANCE WITH STANDARD 606001 EXCEPT IT SHALL BE CONSTRUCTED TO THE FULL THICKNESS OF THE EXISTING PAVEMENT AND A HIGH EARLY STRENGTH CONCRETE MIX WILL BE REQUIRED. SEE THE SPECIAL PROVISIONS FOR THE CONCRETE MIX REQUIREMENTS.
 - SEE THE PROPOSED TYPICAL SECTION NOTES FOR ADDITIONAL INFORMATION FOR THE LONGITUDINAL AND TRANSVERSE JOINTS.
 - THE COST OF THE CURB AND GUTTER INCLUDING THE ADDITIONAL THICKNESS, HIGH EARLY STRENGTH CONCRETE MIX, 2" STUBS, LONGITUDINAL JOINT, TRANSVERSE JOINTS AND 3/4" EXPANSION JOINT SHALL BE PAID FOR AT THE CONTRACT UNIT PRICE PER FOOT FOR COMBINATION CONCRETE CURB AND GUTTER, TYPE B-6.12 (SPECIAL).

CURB AND GUTTER REPLACEMENT DETAIL

NO SCALE

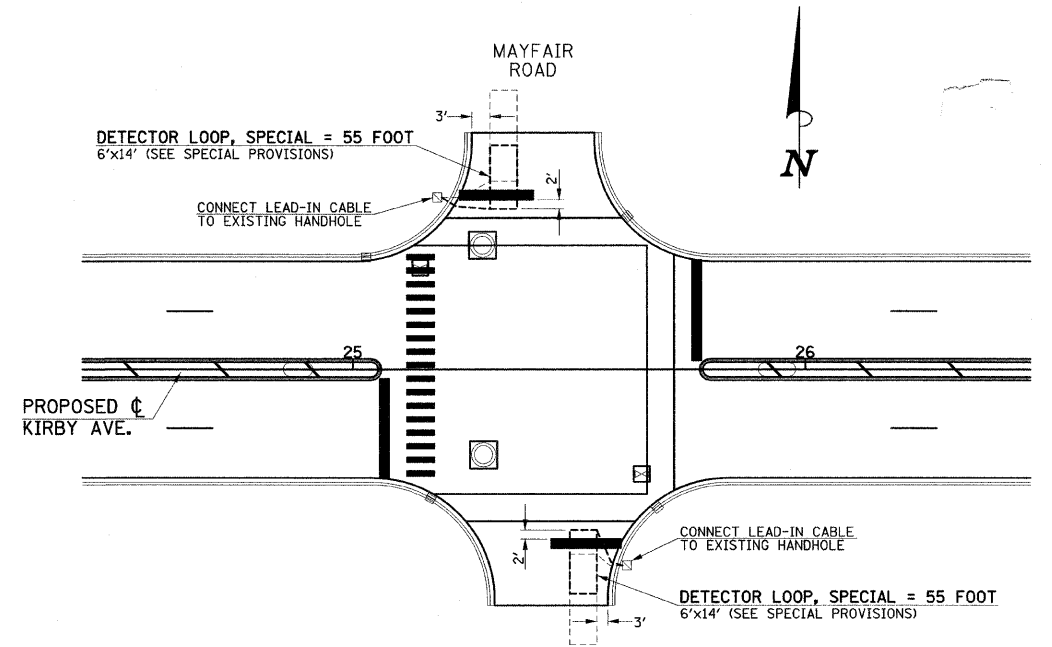

NOTES

- THE DETECTOR LOOP, SPECIAL SHALL BE A PREFORMED LOOP AND LEAD-IN ASSEMBLY AND SHALL BE IN ACCORDANCE WITH THE APPLICABLE ARTICLES OF SECTION 886 OF THE STANDARD SPECIFICATIONS. SEE THE SPECIAL PROVISIONS FOR THE MATERIAL REQUIREMENTS.
- THE DETECTOR LOOPS SHALL BE PLACED AND ANCHORED ON TOP OF THE FINISHED LEVEL BINDER COURSE PRIOR TO PLACEMENT OF THE HOT-MIX ASPHALT SURFACE COURSE.
- THE EXISTING LOOPS SHALL BE DISCONNECTED AT THE HANDHOLES AND ABANDONED. THE NEW LEAD-IN CABLES SHALL BE CONNECTED TO THE EXISTING CABLES IN THE HANDHOLES AND THE LOOPS PUT INTO SERVICE.
- THE DETECTOR LOOPS WILL BE PAID FOR AT THE CONTRACT UNIT PRICE PER FOOT FOR DETECTOR LOOP, SPECIAL. THE WORK SHALL INCLUDE ALL MATERIALS, LABOR AND EQUIPMENT NECESSARY TO INSTALL THE LOOPS AT THE LOCATIONS SHOWN ON THE DETAIL.

DETECTOR LOOP, SPECIAL DETAIL

NO SCALE

FILE NAME = p:\0010470\plans\sheets\details.dgn
PLOT DATE = 7/16/2009 10:44:46 AM

DESIGNED - R.L.H.	REVISED -
DRAWN - J.L.B.	REVISED -
CHECKED - J.T.P.	REVISED -
DATE - 6-09	REVISED -

STATE OF ILLINOIS
DEPARTMENT OF TRANSPORTATION

MISCELLANEOUS DETAILS

SCALE : NONE SHEET NO. 27 OF 27 SHEETS STA. TO STA.

F.A.U. RTE. 7138	SECTION 09-00281-00-RS	COUNTY CHAMPAIGN	TOTAL SHEETS 27	SHEET NO. 27
CONTRACT NO. 91408			FED. ROAD DIST. NO. ILLINOIS FED. AID PROJECT ARA-5181 (046)	