

UTILITIES
 Call J.U.L.I.E. 1-800-892-0123
 The contractor shall coordinate
 The relocation of any utilities
 with the utility company where they
 conflict with the proposed
 improvements.

Harold E. Miles
 R.R. 2, Box 84
 Potomac, IL 61865

D. Stan Seaman
 13160 U.S. Rte. 136
 Alvin, IL 61811

EXISTING STRUCTURE DESCRIPTION
 Two span concrete slab & beams
 on concrete pier and closed concrete
 abutments with concrete wingwalls,
 85.9' E/E deck, width 24'-2" O/O
 of deck.

Removal of existing structure = 1 each.

CHANNEL EXCAVATION
 The channel shall be excavated as
 shown with 2:1 slopes within the
 existing right-of-way. Suitable
 excavated materials to be used in
 the embankments.

NOTE:
 Signs shall be removed and salvaged
 only where they interfere with proposed
 improvements. Salvaged signs and hardware
 shall be placed with the resident engineer.

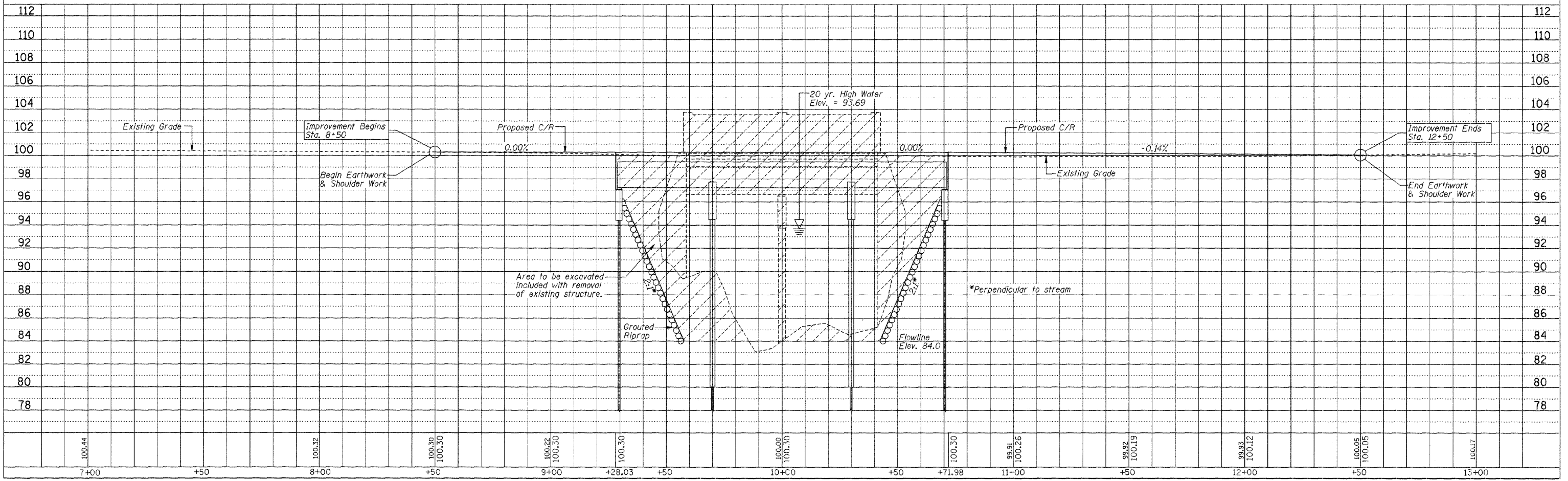

PLAN & PROFILE STA. 7+00 TO STA. 13+00