

**NORTH BACK OF SIDEWALK**

Location	Station	Offset	Theoretical Grade Elevations
E. End Culvert Deck	12+19.21	-26.08	760.59
A	12+29.21	-26.08	760.57
B	12+39.21	-26.08	760.53
End East Appr. Slab	12+49.21	-26.08	760.47

**NORTH FACE OF SIDEWALK**

Location	Station	Offset	Theoretical Grade Elevations
E. End Culvert Deck	12+24.21	-21.08	760.68
A	12+34.21	-21.08	760.65
B	12+44.21	-21.08	760.60
End East Appr. Slab	12+54.21	-21.08	760.53

**NORTH EDGE OF PAVEMENT**

Location	Station	Offset	Theoretical Grade Elevations
E. End Culvert Deck	12+25.79	-19.50	760.71
A	12+35.79	-19.50	760.68
B	12+45.79	-19.50	760.62
End East Appr. Slab	12+55.79	-19.50	760.55

**☉ ROADWAY & PROFILE GRADE LINE**

Location	Station	Offset	Theoretical Grade Elevations
E. End Culvert Deck	12+45.29	0.00	761.01
A	12+55.29	0.00	760.94
B	12+65.29	0.00	760.84
End East Appr. Slab	12+75.29	0.00	760.73

**SOUTH EDGE OF PAVEMENT**

Location	Station	Offset	Theoretical Grade Elevations
E. End Culvert Deck	12+64.79	19.50	760.46
A	12+74.79	19.50	760.34
B	12+84.79	19.50	760.21
End East Appr. Slab	12+94.79	19.50	760.05

**SOUTH FACE OF SIDEWALK**

Location	Station	Offset	Theoretical Grade Elevations
E. End Culvert Deck	12+66.37	21.08	760.41
A	12+76.37	21.08	760.29
B	12+86.37	21.08	760.15
End East Appr. Slab	12+96.37	21.08	759.99

**SOUTH BACK OF SIDEWALK**

Location	Station	Offset	Theoretical Grade Elevations
E. End Culvert Deck	12+71.37	18.92	760.25
A	12+81.37	18.92	760.12
B	12+91.37	19.58	759.97
End East Appr. Slab	13+01.37	19.58	759.80

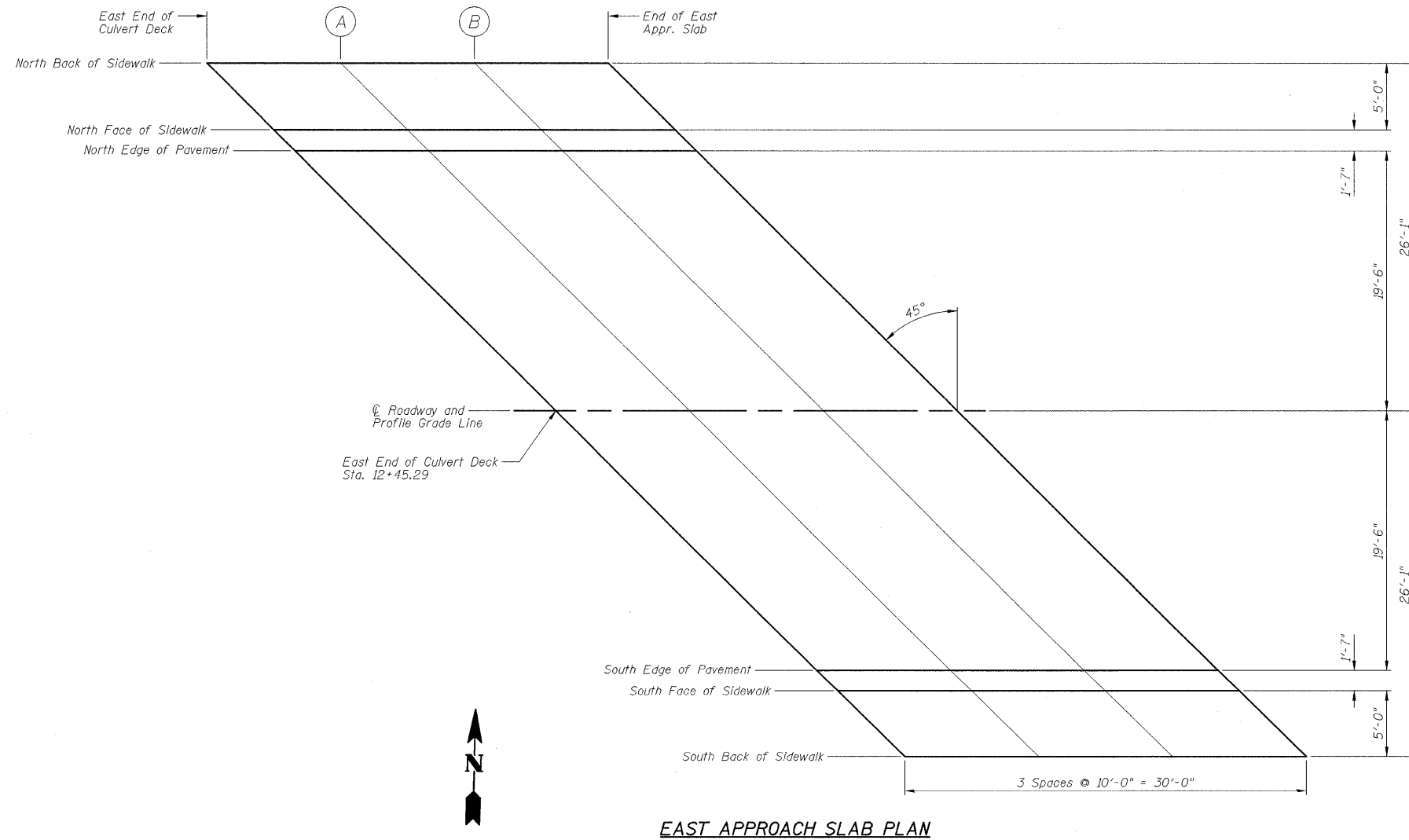

DESIGNED - SDH	REVISED -
DRAWN - JWK	REVISED -
CHECKED - MSW	REVISED -
DATE - 07/22/2009	REVISED -

**TOWN OF NORMAL**

**TOP OF EAST APPROACH SLAB ELEVATIONS**

SCALE: SHEET NO. C14 OF 23 SHEETS STA. TO STA.

**VIRGINIA AVENUE OVER SUGAR CREEK SECTION 04-00226-00-BR MCLEAN COUNTY**

F.A.U.	SECTION	COUNTY	TOTAL SHEETS	SHEET NO.
6366	04-00226-00-BR	MCLEAN	52	35
S.N. 057-7834		CONTRACT NO. 91416		
FED. ROAD DIST. NO. [ILLINOIS] FED. AID PROJECT				