

PLAN	NO.	DATE
REVISED		
NOTE BOOK		
NO.		
FILE NAME		

PROFILE	NO.	DATE
REVISED		
NOTE BOOK		
NO.		
FILE NAME		

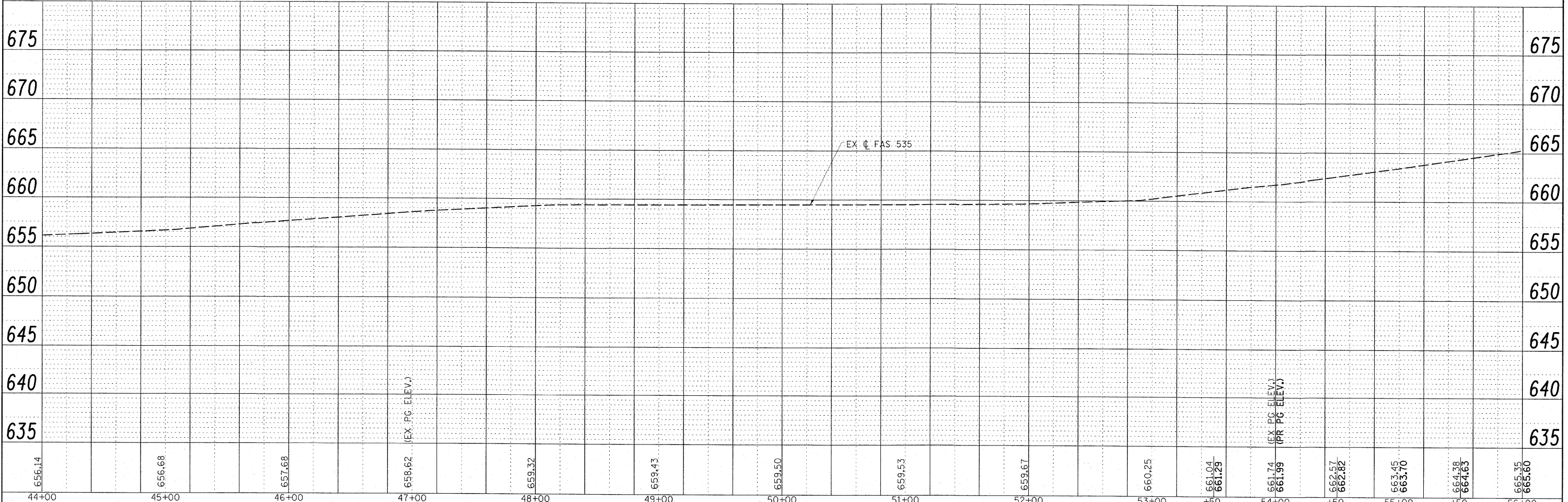
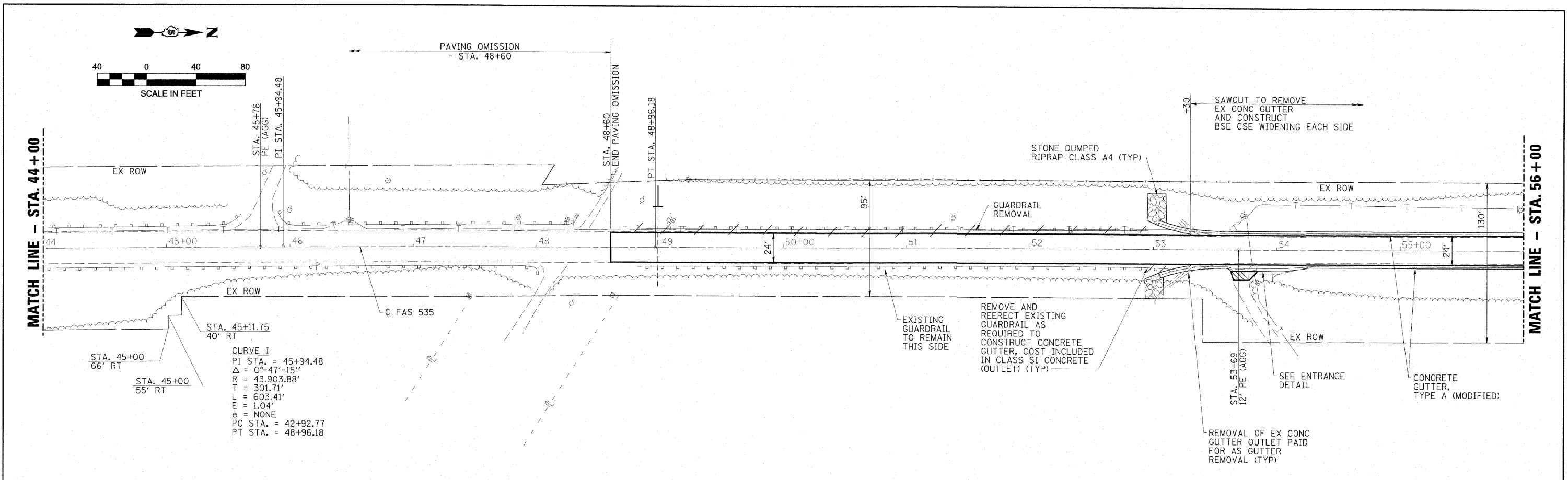

FILE NAME = 24402F01.dgn	USER NAME = HAS	DESIGNED - ELH	REVISED -	STATE OF ILLINOIS DEPARTMENT OF TRANSPORTATION	FAS 535 (SHADY REST ROAD) PLAN & PROFILE	F.A.S. RTE. 535	SECTION 08-00115-01-RS	COUNTY PIATT	TOTAL SHEETS 53	SHEET NO. 14
SCALES: (HORIZ) 1"=40' (VERT) 1"=5'	PLOT SCALE = 40,0000' / IN.	CHECKED - ELH	REVISED -			CONTRACT NO. 91421				
PLOT DATE = 7/13/2009	DATE = 07/13/09	REVISOR -	REVISED -			FED. ROAD DIST. NO. ILLINOIS FED. AID PROJECT				
						SCALE: 1"=40' SHEET NO. 5 OF 8 SHEETS STA. 44+00 TO STA. 56+00				