

- LEGEND**
- GRADING AND SHAPING DITCHES
  - ~ PROPOSED DITCH/SWALE TO BE GRADED TO ELEVATIONS SHOWN ON CROSS SECTIONS
  - PERIMETER EROSION BARRIER
  - ◇ INLET AND PIPE PROTECTION
  - ◇ TEMPORARY DITCH CHECK
  - ▨ STONE DUMPED RIPRAP CLASS A4
  - - - EXISTING PIPE CULVERT
  - PROPOSED PIPE CULVERT WITH END SECTIONS
  - PROPOSED INLET

**NOTE**  
LAYOUT OF THE EROSION CONTROL ITEMS MAY BE VARIED IN THE FIELD TO SUIT CONDITIONS AS DIRECTED BY THE ENGINEER.

**EXISTING CURVE DATA**  
 PI STA. 6+71.99  
 $\Delta = 35^{\circ}-08'-33''$   
 R = 600.00'  
 L = 368.01'  
 T = 190.00'  
 E = 29.36'  
 e = NONE  
 PC STA. 4+81.99  
 PT STA. 8+50.00

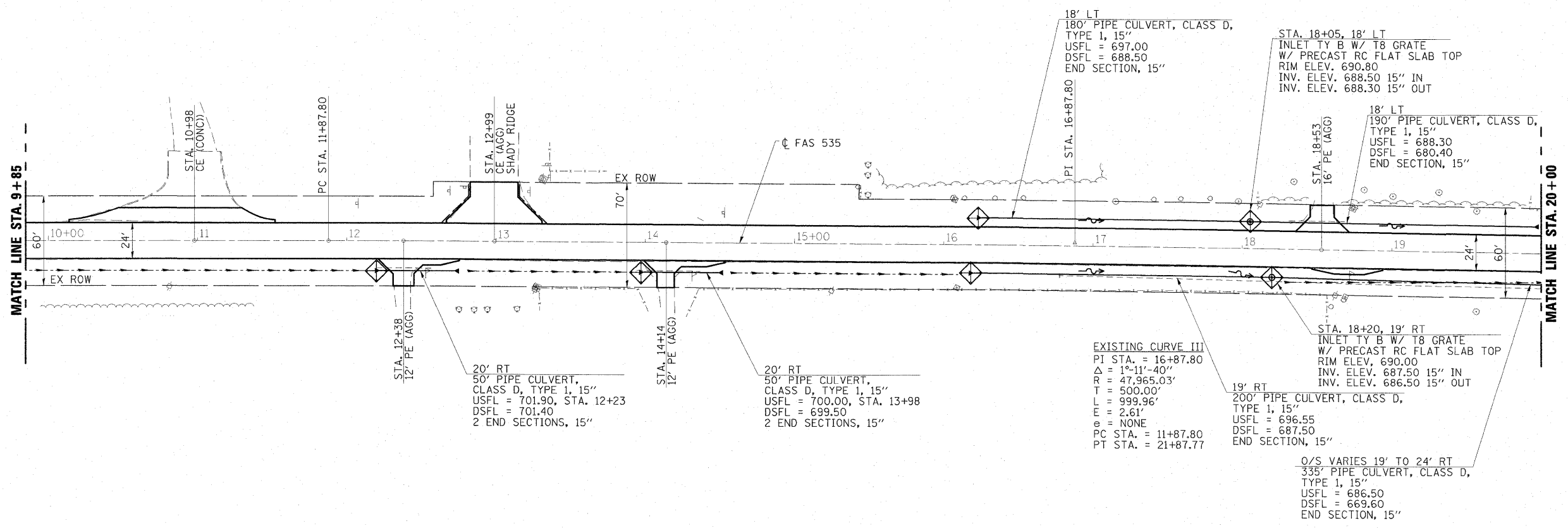

|                                  |                 |           |
|----------------------------------|-----------------|-----------|
| USER NAME = HAS                  | DESIGNED - ELH  | REVISED - |
|                                  | DRAWN - HAS     | REVISED - |
| PLOT SCALE = 0.8833' / IN.       | CHECKED - ELH   | REVISED - |
| PLOT DATE = 7/13/2009 2:23:22 PM | DATE - 04/03/09 | REVISED - |

**STATE OF ILLINOIS  
DEPARTMENT OF TRANSPORTATION**

**EROSION CONTROL AND DRAINAGE PLAN**  
 SCALE: 1"=40'-0"  
 SHEET NO. 1 OF 4 SHEETS  
 STA. 3+00 TO STA. 20+00

|   |                        |              |                 |              |
|---|------------------------|--------------|-----------------|--------------|
| F.A.P. RTE. 535                               | SECTION 08-00115-01-RS | COUNTY PIATT | TOTAL SHEETS 53 | SHEET NO. 18 |
| FED. ROAD DIST. NO. ILLINOIS FED. AID PROJECT |                        |              |                 |              |

CONTRACT NO. 914