

F.A.S.	SECTION	COUNTY	TOTAL SHEETS	SHEET NO.
1819	09-00080-00-RS	WABASH	4	1
FED. ROAD DIST. NO. 7		ILLINOIS	GOODSON ORCHARD ROAD	
H09I019WB			CONTRACT # 95596	

STATE OF ILLINOIS
DEPARTMENT OF TRANSPORTATION
DIVISION OF HIGHWAYS

PLANS FOR PROPOSED FEDERAL-AID SECONDARY PROJECT

F.A.S. 1819 SECTION 09-00080-00-RS WABASH COUNTY
PROJECT ARA-RS-1819(107) JOB NO. C-97-130-09

INDEX OF SHEETS

SHEET NO.	DESCRIPTION
1	TITLE SHEET
2	TYPICAL SECTIONS, SUMMARY OF QUANTITIES, GENERAL NOTES, MISCELLANEOUS DETAILS
3	DETAILS OF INTERSECTIONS, SIDEROADS, AND TAPERS
4	SCHEDULES & MISC. DETAILS

HIGHWAY STANDARDS

000001-05	STANDARD SYMBOLS, ABBREVIATIONS & PATTERNS
406201-01	MAILBOX TURNOUT
701006-03	OFF-RD OPERATIONS 2L, 2W, 4.5 m (15') TO PAVEMENT EDGE FOR SPEEDS \geq 45 MPH
701301-03	LANE CLOSURE 2L, 2W, SHORT TIME OPERATIONS
701306-02	LANE CLOSURE, 2L, 2W, SLOW MOVING OPERATIONS - DAY ONLY FOR SPEEDS \geq 45 MPH
701311-03	LANE CLOSURE 2L, 2W MOVING OPERATIONS - DAY ONLY
701901-01	TRAFFIC CONTROL DEVICES
780001-02	TYPICAL PAVEMENT MARKINGS
781001-03	TYPICAL APPLICATIONS RAISED REFLECTIVE PAVEMENT MARKERS

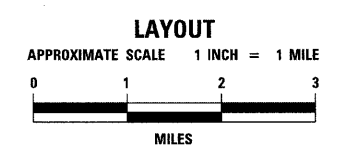
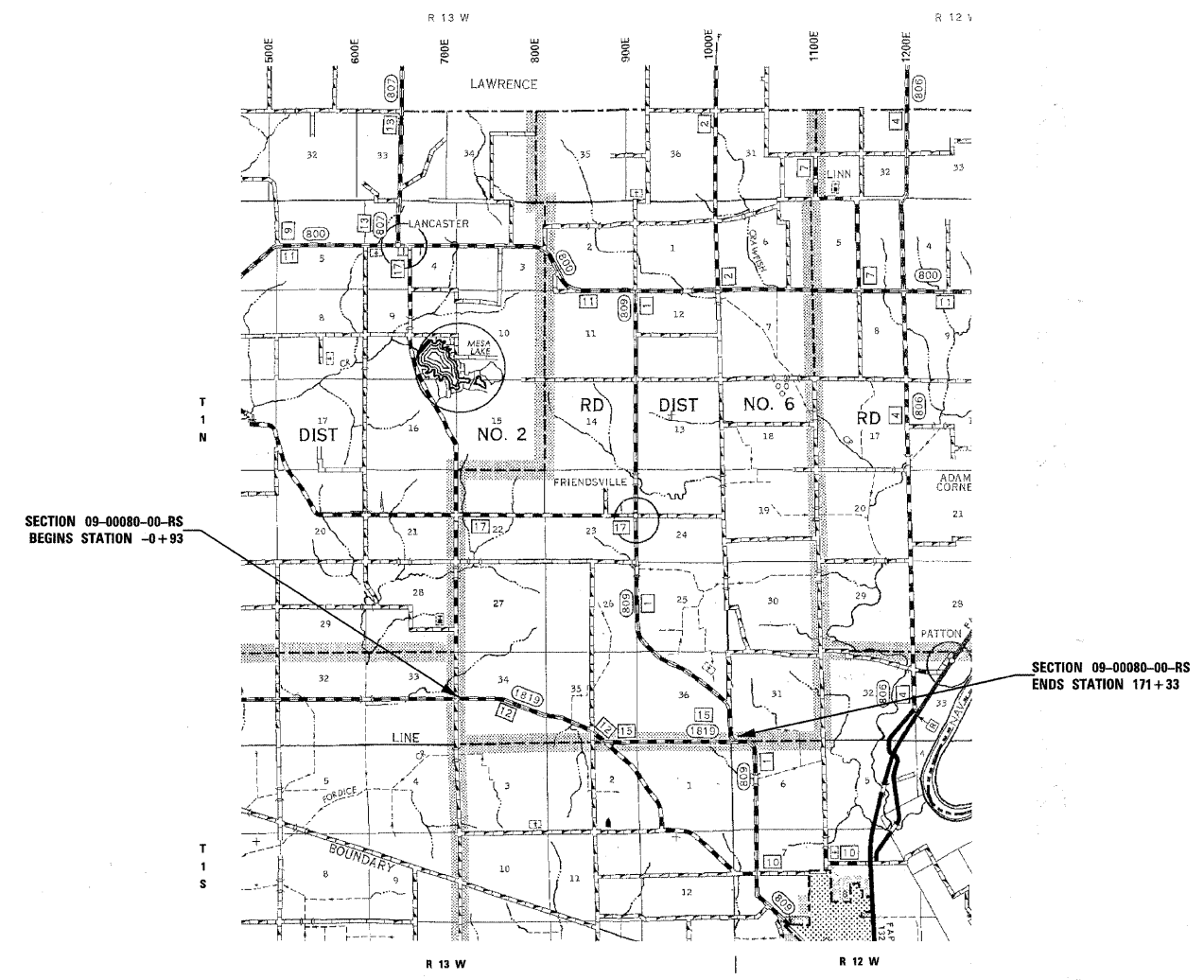
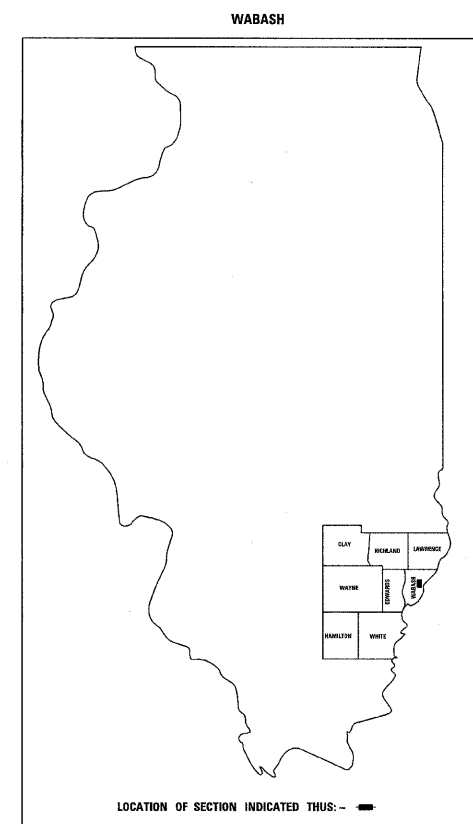

	FEET	MILES
GROSS LENGTH	17,133 FT	3.2449 MILES
OMISSION	0 FT	0 MILES
NET LENGTH	17,133 FT	3.2449 MILES

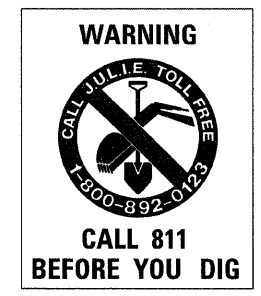

CONTRACT NO. 95596
DESIGN CLASS - MAJOR COLLECTOR
CURRENT A.D.T. = 1000
DESIGN SPEED = 50 MPH

323 W. 3RD ST.
P.O. BOX 160
MT. CARMEL, IL
62863
PHONE:
(618)-262-8651
FAX:
(618)-263-3327

405 W. STATE ST.
SUITE 1
PRINCETON, IN
47670
PHONE:
(812)-386-7611
FAX:
(812)-385-2812



PROFESSIONAL DESIGN FIRM
LAND SURVEY &
PROFESSIONAL ENGINEERING CORPORATION
184-000887
(62-032435)(35-002769)



AARON M. MEFFORD
NAME
SIGNATURE
7-31-09
DATE
11-30-09
EXPIRES

STATE OF ILLINOIS
DEPARTMENT OF TRANSPORTATION

APPROVED July 31 20 09
[Signature]
COUNTY ENGINEER

PASSED 8/14 20 09
[Signature]
DISTRICT SEVEN ENGINEER OF
LOCAL ROADS & STREETS

Releasing For
Bid Based on
Limited Review
8/14 20 09
[Signature]
DEPUTY DIRECTOR OF HIGHWAYS,
REGION FOUR ENGINEER

TYPICAL CROSS SECTION

EXISTING

(STA. 0+00 TO STA. 83+00)

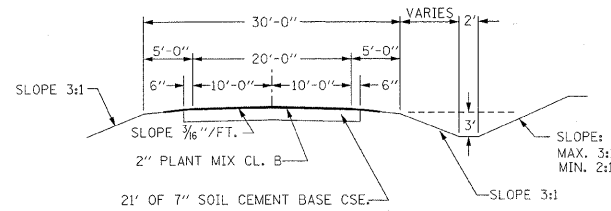

TYPICAL CROSS SECTION

PROPOSED

(STA. 0+00 TO STA. 83+00)

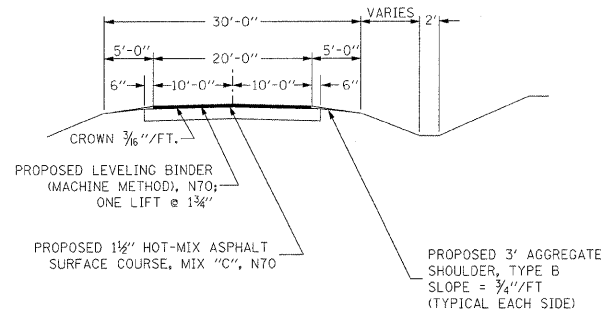

GENERAL NOTES:

THIS SECTION CONSISTS OF LEVELING BINDER (MACHINE METHOD), N70, AND HOT-MIX ASPHALT SURFACE COURSE, MIX "C", N70, AGGREGATE SHOULDERS, AND OTHER MISCELLANEOUS ITEMS NECESSARY TO COMPLETE THE PROJECT, ALL IN ACCORDANCE WITH THE PLANS, SPECIAL PROVISIONS AND "STANDARD SPECIFICATIONS FOR ROAD AND BRIDGE CONSTRUCTION" ADOPTED JANUARY 1, 2007.

THE EXISTING GRADE, ALIGNMENT, DRAINAGE STRUCTURES, BASE AND SURFACE WERE CONSTRUCTED UNDER SECTIONS 33-10 AND 33-20, 89-00054-00-RS AND SHALL REMAIN IN PLACE. ALL STATIONS REFERRED TO IN THE PLANS AND PROPOSAL ARE REFERENCED TO THE ABOVE MENTIONED SECTIONS.

MAXIMUM PERCENT OF GRADE	-5.785 %
MINIMUM STOPPING SIGHT DISTANCE	525 FT
DESIGN SPEED	50 MPH
CURRENT ADT	1000 VPD
DESIGN ADT (20 YEAR)	1250 VPD

THE HOT-MIX ASPHALT SURFACE COURSE, MIX "C", N70 SHALL BE PLACED IN ONE LIFT WITH A MINIMUM THICKNESS OF 1 1/2".

THE QUANTITY SHOWN IN THE SUMMARY OF QUANTITIES FOR HOT-MIX ASPHALT SURFACE COURSE, MIX "C", N70 ALLOWS 202.1 TONS FOR THE INTERSECTIONS, SIDEROADS, AND TAPERS; 135.8 TONS FOR THE ENTRANCES; 80.1 TONS FOR THE MAILBOX TURNOUTS, AND 3196.9 TON FOR THE 1 1/2" HOT-MIX ASPHALT SURFACE COURSE, MIX "C", N70.

THE FOLLOWING RATES HAVE BEEN USED TO CALCULATE PLAN QUANTITIES:

AGGREGATE SHOULDERS TY. B	1.8 T / CU YD
HOT-MIX ASPHALT	0.0560 T / SQ YD • INCH
BITUMINOUS MATERIAL (PRIME COAT)	0.05 GAL / SQ YD

SUMMARY OF QUANTITIES

QUANTITY	UNIT	ITEM	CODE NUMBER
2486.00	GALLON	BITUMINOUS MATERIALS (PRIME COAT)	40600100
5027.00	TON	LEVELING BINDER (MACHINE METHOD), N70	40600635
3615.00	TON	HOT-MIX ASPHALT SURFACE COURSE, MIX "C", N70	40603315
38058.00	SQ YD	AREA REFLECTIVE CRACK CONTROL TREATMENT	44300100
2601.00	TON	AGGREGATE SHOULDERS, TYPE B	48101200
10.00	FOOT	REMOVE AND RELAY PIPE CULVERTS 24"	54223459
1.00	L SUM	MOBILIZATION	67100100
1.00	L SUM	TRAFFIC CONTROL AND PROTECTION, STANDARD 701306	70100460
3445.00	FOOT	SHORT-TERM PAVEMENT MARKING	70300100
59588.00	FOOT	PAINT PAVEMENT MARKING-LINE 4"	78001110 *
217.00	EACH	RAISED REFLECTIVE PAVEMENT MARKER	78100100 *
1723.00	FOOT	SHORT-TERM PAVEMENT MARKING REMOVAL	XX003140

* SPECIALTY ITEMS

323 W. 3RD ST.
P.O. BOX 160
MT. CARMEL, IL
62863
PHONE:
(618)-262-8651
FAX:
(618)-263-3327

405 W. STATE ST.
SUITE 1
PRINCETON, IN
47670
PHONE:
(812)-386-7611
FAX:
(812)-385-2812



PROFESSIONAL
DESIGN FIRM
LAND SURVEY &
PROFESSIONAL
ENGINEERING
CORPORATION
184-000887
(62-032435)(35-002769)



AARON M. MEFFORD
NAME
Aaron Mefford
SIGNATURE
7-31-09
DATE
11-30-09
EXPIRES

TYPICAL CROSS SECTION

EXISTING

(STA. 83+00 TO STA. 171+33)

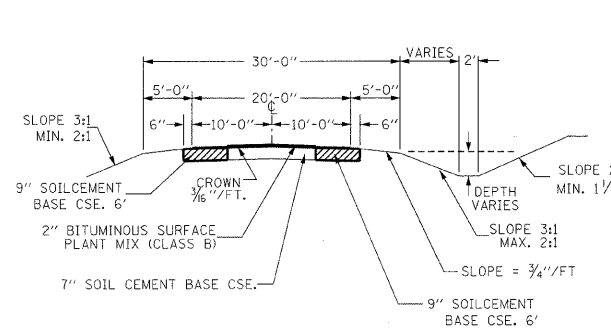

TYPICAL CROSS SECTION

PROPOSED

(STA. 83+00 TO STA. 171+33)

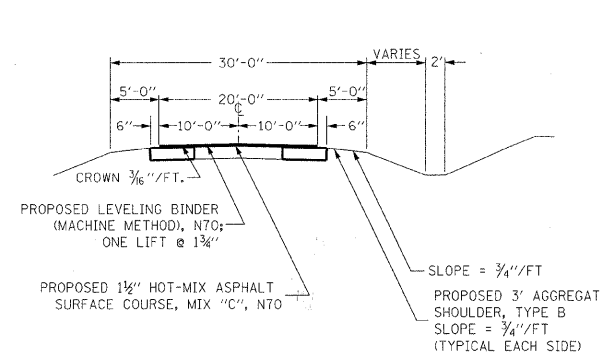

SCHEDULE FOR SUPERELEVATION RATES

CURVE #1	CURVE #3	CURVE #5	CURVE #7
TANGENT RUNOFF BEGINS STA. 25+28.26	TANGENT RUNOFF BEGINS STA. 48+62.36	TANGENT RUNOFF BEGINS STA. 80+17.51	TANGENT RUNOFF BEGINS STA. 167+16.66
S.E. RUNOFF BEGINS STA. 25+61.26	S.E. RUNOFF BEGINS STA. 48+95.36	S.E. RUNOFF BEGINS STA. 80+50.51	S.E. RUNOFF BEGINS STA. 167+38.66
FULL S.E. BEGINS STA. 27+37.26	FULL S.E. BEGINS STA. 49+50.36	FULL S.E. BEGINS STA. 81+71.51	FULL S.E. BEGINS STA. 167+60.66
FULL S.E. ENDS STA. 30+42.70	FULL S.E. ENDS STA. 55+73.70	FULL S.E. ENDS STA. 86+23.07	FULL S.E. ENDS STA. 170+42.66
S.E. RUNOFF ENDS STA. 32+51.70	S.E. RUNOFF ENDS STA. 56+28.70	S.E. RUNOFF ENDS STA. 87+44.07	S.E. RUNOFF ENDS STA. 170+45.66
TANGENT RUNOFF ENDS STA. 32+51.70	TANGENT RUNOFF ENDS STA. 56+61.70	TANGENT RUNOFF ENDS STA. 87+77.07	TANGENT RUNOFF ENDS STA. 170+86.66
S.E. RATE = 0.080 FT / FT	S.E. RATE = 0.025 FT / FT	S.E. RATE = 0.055 FT / FT	S.E. RATE = 0.020 FT / FT
CURVE #2	CURVE #4	CURVE #6	
TANGENT RUNOFF BEGINS STA. 37+66.24	TANGENT RUNOFF BEGINS STA. 65+15.24	TANGENT RUNOFF BEGINS STA. 89+70.60	
S.E. RUNOFF BEGINS STA. 37+99.24	S.E. RUNOFF BEGINS STA. 65+48.24	S.E. RUNOFF BEGINS STA. 90+03.60	
FULL S.E. BEGINS STA. 38+32.24	FULL S.E. BEGINS STA. 66+36.24	FULL S.E. BEGINS STA. 91+79.60	
FULL S.E. ENDS STA. 43+66.49	FULL S.E. ENDS STA. 70+92.58	FULL S.E. ENDS STA. 97+32.26	
S.E. RUNOFF ENDS STA. 43+99.49	S.E. RUNOFF ENDS STA. 71+80.58	S.E. RUNOFF ENDS STA. 99+08.26	
TANGENT RUNOFF ENDS STA. 44+32.49	TANGENT RUNOFF ENDS STA. 72+13.58	TANGENT RUNOFF ENDS STA. 99+41.26	
S.E. RATE = 0.016 FT / FT	S.E. RATE = 0.040 FT / FT	S.E. RATE = 0.008 FT / FT	

DETAIL OF PRIVATE AND FIELD ENTRANCES

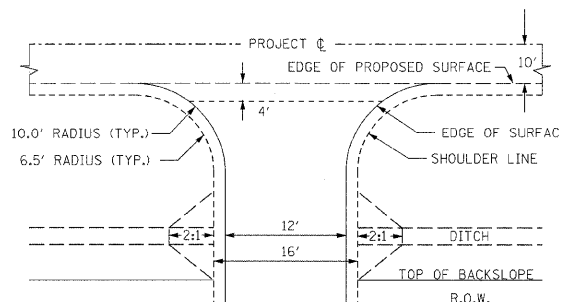

NOTE: THE 4' AREA FROM THE EDGE OF SURFACE, AS SHOWN ABOVE, SHALL BE HOT-MIX ASPHALT SURFACE COURSE, MIX "C", N70 FOR THE PRIVATE ENTRANCES AND THE FIELD ENTRANCES. THIS QUANTITY IS INCLUDED IN THE QUANTITY FOR HOT-MIX ASPHALT SURFACE COURSE, MIX "C", N70.

UTILITIES

MT. CARMEL PUBLIC UTILITY 316 MARKET STREET MT. CARMEL, IL 62863 618-262-5151	NORRIS ELECTRIC COOP. RT. 130 SOUTH NEWTON, IL 62448 618-299-6101	RURAL WABASH WATER DISTRICT P.O. BOX 55 LANCASTER, IL 62855 618-665-3311	VERIZON TELEPHONE CO. 225 EAST CHESTNUT ONLEY, IL 62450 618-395-6181	JULI.E. 800-892-0123
--	--	---	---	-------------------------

F.A.S.	SECTION	COUNTY	TOTAL SHEETS	SHEET NO.
1819	09-0080-00-RS	WABASH	4	3
FED. ROAD DIST. NO. 7		ILLINOIS	GOODSON ORCHARD ROAD	
LEC JOB # H091019WB			CONTRACT # 95996	

DETAIL OF INTERSECTION 0+03 LT AND 0+00 RT AND TAPER STA. -0+93 TO STA. 07+43

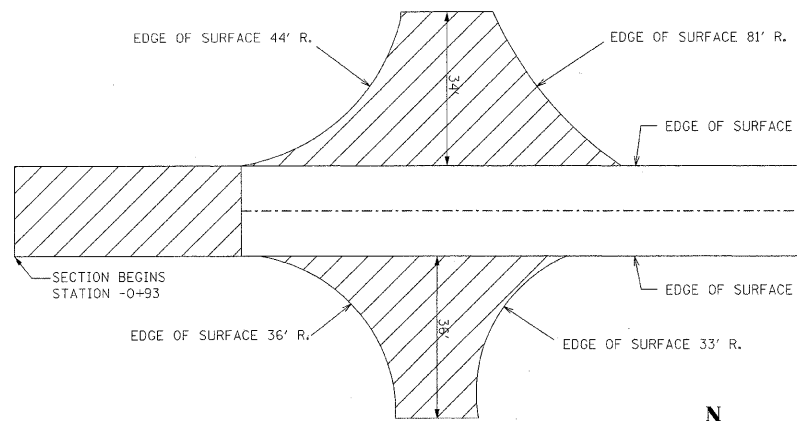

NOTE: THE QUANTITY SHOWN FOR HOT-MIX ASPHALT SURFACE COURSE, MIX "C", N70 INCLUDES 28.9 TONS OF MATERIAL FOR THE SIDEROAD LT APPROACH AND RADII; 21.8 TONS OF MATERIAL FOR THE SIDEROAD RT. APPROACH AND RADII; AND 10.1 TONS OF MATERIAL FOR THE TAPER FROM STATION -0+93 TO STATION 0+43.

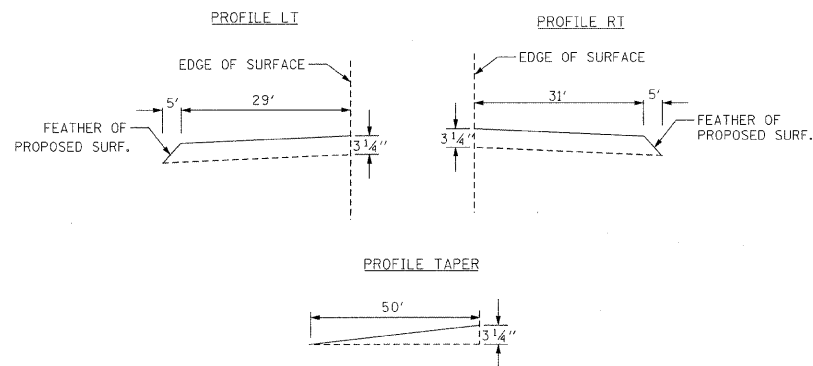

DETAILS OF SURFACING AT INTERSECTIONS AND SIDEROADS

DETAIL OF INTERSECTION 84+40 LT AND 84+87 RT

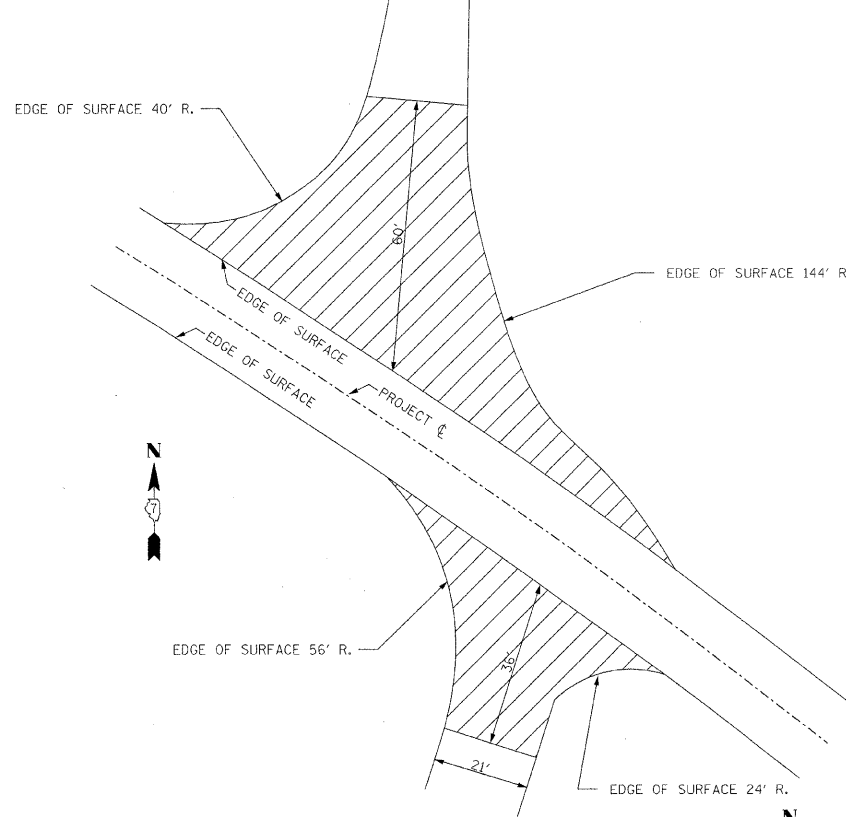

NOTE: THE QUANTITY SHOWN FOR HOT-MIX ASPHALT SURFACE COURSE, MIX "C", N70 INCLUDES 60.4 TONS OF MATERIAL FOR THE SIDEROAD LT APPROACH AND RADII AND 24.5 TONS OF MATERIAL FOR THE SIDEROAD RT. APPROACH AND RADII.

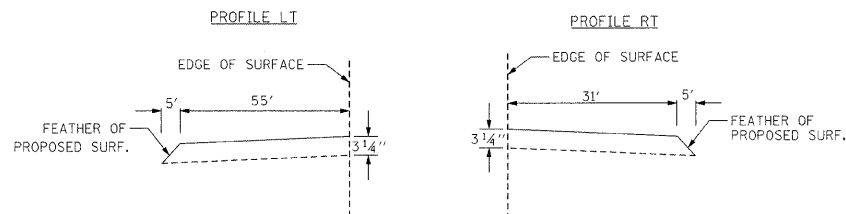

DETAIL OF INTERSECTION 95+11 RT

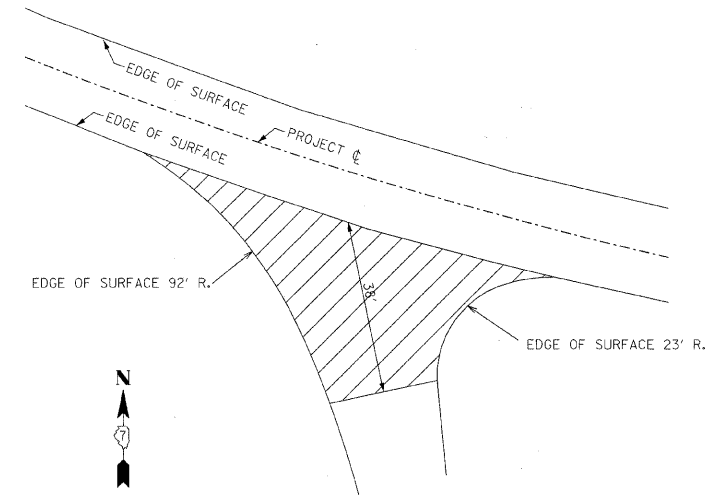

NOTE: THE QUANTITY SHOWN FOR HOT-MIX ASPHALT SURFACE COURSE, MIX "C", N70 INCLUDES 32.6 TONS OF MATERIAL FOR THE SIDEROAD RT

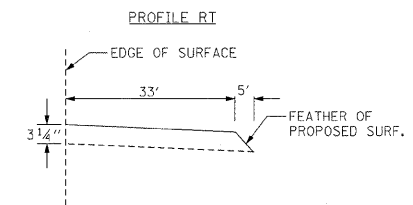

DETAIL OF TAPER STA. 0+75 TO STA. 1+25

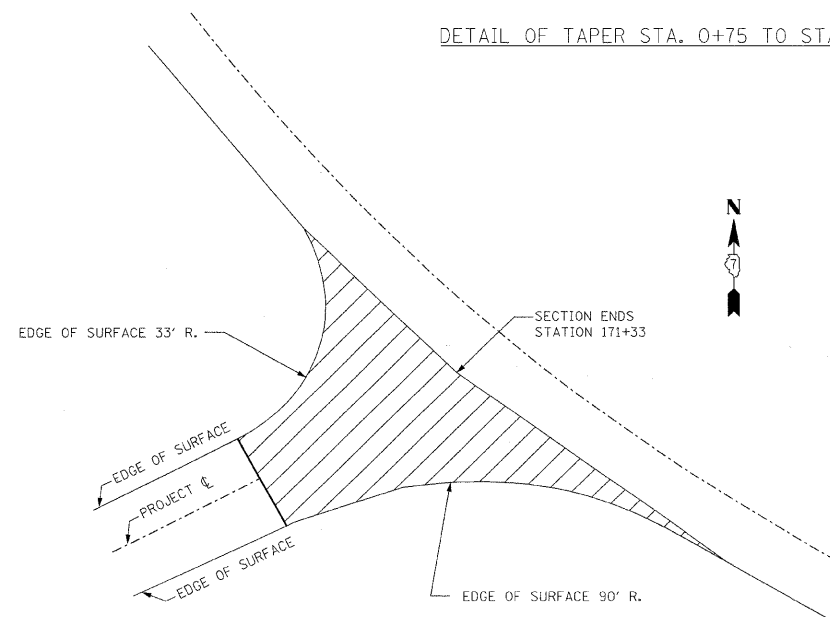

NOTE: THE QUANTITY SHOWN FOR HOT-MIX ASPHALT SURFACE COURSE, MIX "C", N70 INCLUDES 23.8 TONS OF MATERIAL FOR THE TAPER FROM STATION 170+83 TO STATION 171+33.

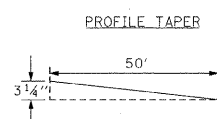

323 W. 3RD ST.
P.O. BOX 160
MT. CARMEL, IL
62863
PHONE:
(618)-262-8651
FAX:
(618)-263-3327

405 W. STATE ST.
SUITE 1
PRINCETON, IN
47670
PHONE:
(812)-386-7611
FAX:
(812)-385-2812



PROFESSIONAL
DESIGN FIRM
LAND SURVEY &
PROFESSIONAL
ENGINEERING
CORPORATION
184-000887
(62-032435)(35-002769)



AARON M. MEFFORD
NAME
Aaron M. Mefford
SIGNATURE
7-31-09
DATE
11-30-09
EXPIRES

SCHEDULE OF PAVEMENT MARKINGS

STATION	TO	STATION	LOCATION	LENGTH - FOOT
-0+93		171+33	CENTERLINE	2436
			EDGE LINE	
-0+93	-0+20		RT.	73
0+20	84+75		RT.	8455
85+15	94+90		RT.	975
95+40	171+33		RT.	7593
			EDGE LINE	
-0+93	-0+20		LT.	73
0+20	84+00		LT.	8380
84+75	171+33		LT.	8658
			NO PASSING	
-0+93	11+00		RT.	1193
9+00	76+25		LT.	6725
20+40	43+85		RT.	2345
50+70	70+35		RT.	1965
76+95	106+00		RT.	2905
83+10	115+65		LT.	3255
120+60	136+81		RT.	1621
132+80	148+50		LT.	1570
160+30	171+13		RT.	1083
168+30	171+13		LT.	283
				TOTAL 59,588

THE ABOVE QUANTITY IS SHOW IN THE PAVEMENT MARKING-LINE 4" IN THE SUMMARY OF QUANTITIES.

SCHEDULE OF AGGREGATE SHOULDER STONE IN SUPERELEVATION

STATION	TO	STATION	LOCATION	ALLOWED TONS EST. QUANTITY
25+28.26		32+51.70	LT.	49.9
37+66.24		44+32.49	LT	66.0
48+62.36		56+61.70	LT	74.4
65+15.24		72+13.58	LT	53.8
80+17.51		87+77.07	LT	49.4
89+70.60		99+41.26	LT	87.4
167+16.66		170+83.00	LT	27.1
25+28.26		32+51.70	RT.	69.5
37+66.24		44+32.49	RT.	46.7
48+62.36		56+61.70	RT.	56.0
65+15.24		72+13.58	RT.	61.5
80+17.51		87+77.07	RT.	71.4
89+70.60		99+41.26	RT.	60.2
167+16.66		170+83.00	RT.	27.5
				TOTAL 800.8

THE ABOVE QUANTITY IS FOR THE ENTIRE SECTION AND IS INCLUDED IN THE QUANTITY FOR AGGREGATE SHOULDERS, TYPE B IN THE SUMMARY OF QUANTITIES.

SCHEDULE OF AGGREGATE SHOULDER STONE IN TANGENT

STATION	TO	STATION	LOCATION	ALLOWED TONS EST. QUANTITY
-0+43		25+28.26	LT.	221.2
32+51.70		37+66.24	LT	38.6
44+32.49		48+62.36	LT	43.0
56+61.70		65+15.24	LT	76.0
72+13.58		80+17.51	LT	57.9
87+77.07		89+70.60	LT	13.7
99+41.26		167+16.66	LT	549.1
-0+43		25+28.26	RT	247.0
32+51.70		37+66.24	RT	49.9
44+32.49		48+62.36	RT	34.0
56+61.70		65+15.24	RT	69.2
72+13.58		80+17.51	RT	73.4
87+77.07		89+70.60	RT	15.2
99+41.26		167+16.66	RT	311.8
				TOTAL 1800.0

THE ABOVE QUANTITY IS FOR THE ENTIRE SECTION AND IS INCLUDED IN THE QUANTITY FOR AGGREGATE SHOULDERS, TYPE B IN THE SUMMARY OF QUANTITIES.

SCHEDULE OF MAILBOX TURNOUTS

STATION	LOCATION	EST. QUANTITY ALLOWED TONS
8+07	RT.	4.6
11+47	RT.	5.9
14+64	RT.	4.5
19+41	RT.	4.7
23+46	RT.	4.7
28+05	RT.	4.6
33+64	RT.	5.3
41+31	RT.	7.4
41+74	RT.	5.8
57+78	RT.	3.3
66+08	RT.	3.5
128+21 & 128+23	LT.	2.5
129+52	RT.	2.0
132+38	RT.	2.8
133+88	RT.	2.2
135+14 & 135+18	LT.	5.1
138+30	RT.	2.1
148+55	RT.	4.0
153+23	RT.	2.9
158+51	RT.	2.2
		80.1

THE ABOVE QUANTITY IS INCLUDED IN THE HOT-MIX ASPHALT SURFACE COURSE, MIX "C", N70 IN THE SUMMARY OF QUANTITIES.

SCHEDULE OF REMOVE & RELAY PIPE CULVERTS

STATION	SIZE	LENGTH	END OF CULVERT
137+27	24"	10'	SOUTH

SCHEDULE OF PRIVATE AND FIELD ENTRANCES

STATION	LOCATION	BC SC SUPER "C" N70 (IN TONS)
7+72	LT	2.5
9+47	RT	2.2
11+75	RT	2.1
13+20	LT	2.3
13+61	RT	5.4
14+89	RT	3.1
19+02	LT	3.0
23+03	LT	3.0
26+39	RT	2.8
27+92	LT	3.6
32+74	RT	3.3
34+03	RT	4.3
34+85	LT	2.9
35+39	RT	3.0
40+87	LT	3.4
41+18 & 41+59	RT	8.2
43+41	RT	3.4
47+22	RT	2.4
52+86	RT	2.1
55+07	RT	1.5
57+99	RT	2.8
59+80	RT	2.4
65+97	LT	2.1
66+27	RT	1.9
68+96	LT	2.1

THE ABOVE QUANTITY IS INCLUDED IN THE HOT-MIX ASPHALT SURFACE COURSE, MIX "C", N70 IN THE SUMMARY OF QUANTITIES.

SCHEDULE OF PRIVATE AND FIELD ENTRANCES

STATION	LOCATION	BC SC SUPER "C" N70 (IN TONS)
72+45	RT	1.7
76+80	LT	2.3
106+85	RT	2.5
108+32	LT	2.2
112+81	RT	2.1
112+87	LT	2.0
115+05	LT	2.0
118+12	RT	2.3
127+63	LT	1.6
128+00	LT	2.6
129+32	RT	2.2
130+95	RT	1.6
132+25	RT	1.7
133+66	RT	2.1
134+52	LT	3.0
135+52	RT	2.0
137+81	LT	2.6
138+15	RT	3.0
143+71	LT	1.8
148+72	RT	2.8
153+41	RT	3.2
157+60	LT	2.3
158+75	RT	6.6
159+98	RT	3.8
		TOTAL 135.8

AGGREGATE SHOULDER DETAIL

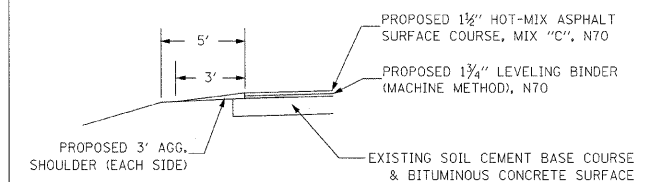

PRIVATE & FIELD ENTRANCE APPROACH DETAIL

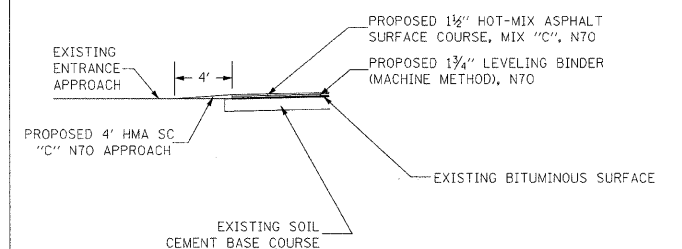

323 W. 3RD ST.
P.O. BOX 160
MT. CARMEL, IL
62863
PHONE:
(618)-262-8661
FAX:
(618)-263-3327

405 W. STATE ST.
SUITE 1
PRINCETON, IN
47670
PHONE:
(812)-386-7611
FAX:
(812)-385-2812



PROFESSIONAL DESIGN FIRM
LAND SURVEY & PROFESSIONAL ENGINEERING CORPORATION
184-00087
(62-032435)(35-002769)



AARON M. MEFFORD
NAME
Signature
7-31-09
DATE
11-30-09
EXPIRES