

ROUTE NO. SECTION CITY TOTAL SHEETS SHEET NO.
 FAU 7467 99-00021-00-RP MT. ZION 36 18
 FED. ROAD DIST. NO. ILLINOIS PROJECT

**CONTRACT NUMBER 95603
 PROJECT ARA-5169 (043)**

REVISIONS	
NO.	DATE
1	8-24-09

BRIDGEMAN & ASSOCIATES, INC.
 Consulting Engineers
 1111 SOUTH TAYLORVILLE ROAD
 DECATUR ILLINOIS
 Illinois License 184-001265

DESIGNED: MJP
 DRAWN: Les Jenks/MS
 FIELD BOOK: 122
 SCALE: 1" = 50'
 DATE: July 2008
 JOB NO.: 08-014H

VILLAGE OF MT. ZION, ILLINOIS
 FLETCHER PARK BOULEVARD / BRAVES PARKWAY
 PAVEMENT MARKING

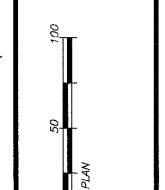

SHEET NO. **18**
 OF
 36

LOCATION	12000000		18000000		18000000		18000000		18000000		18000000		18000000	
	Short-Term Pav. Marking Feet	Letters & Symbols Sq Ft	Line 4" White Post	Line 4" Yellow Post	Line 12" White Post	Line 12" Yellow Post	Line 24" White Post	Line 24" Yellow Post	Sign Panel Type 1 Sq Ft	Sign Panel Type 2 Sq Ft	Wood Sign Support Post Foot	Metal Post Type B Each		
FAU 7467														
40 RL 0+42.0														
LI 10+94.2														
CL 10+61.0 - CL 12+82.1				442										
LI 12+82.1									3.2					
RL 11+50.0									6.5					
RL 12+76.0									6.25					
LI 13+00.0									6.25					
LI 12+52.1 - RL 12+52.1														
LI 12+54.1 - RL 12+54.1														
CL 12+54.1 - CL 17+04.1				1000										
LI 17+04.1									3.0					
CL 17+04.1 - CL 25+40.0				190					6.5					
LI 25+40.0									6.5					
LI 25+38.0									5.2					
LI 25+41.0 - RL 25+41.0														
LI 25+48.0 - RL 25+48.0														
CL 25+48.0 - CL 126+10.8				20										
CL 26+00.0									12.5	10				
LI 126+10.8									5.2					
LI 126+12.5									6.5					
CL 126+12.5 - CL 124+41.0				40					3.0					
RT 124+41.0														
CL 124+41.0 - CL 134+41.0				1000										
CL 134+41.0 - LI 136+33.0				100										
RL 137+01.0 - LI 136+33.0				80										
LI 136+33.0 - LI 134+46.0				226										
CL 136+33.0 - CL 134+46.0				46.8										
RL 134+46.0 - RL 134+46.0				118										
LI 134+46.0 - RL 134+46.0									3.2					
RL 134+46.0														
30' LI 134+80.0									10.5	35	30			
HENDERSON ST														
CL 311+12.8 - CL 33+46.62				36										
MAIN STREET														
RL 344+18.0									6.25					
CL 344+33.5 - RL 344+33.5				640										
LI 344+33.5 - RL 344+33.5														
LI 344+62.0 - RL 344+62.0				31										
RL 344+62.0 - RL 344+62.0				57										
RL 344+62.0 - RL 344+62.0				60										
LI 344+62.0									6.25					
LI 344+62.0 - RL 400+34.0				15										
RE 400+34.0 - CL 402+15.0				31.2										
CL 402+15.0 - CL 402+15.0				149										
SCHOOL PARKING LOT				65.7										
TOTALS	36	140.3	301	4880	246	224	75	86.8	31	70	60	15		

**PROJECT FUNDING SOURCE SIGN ASSEMBLY
 AMERICAN RECOVERY AND REINVESTMENT ACT
 SIGN LAYOUT DETAIL**



W11-2
 30" x 30"
 W/ A Flashing Beacon,
 Post Mounted, Solar
 Powered Installation



DO NOT PASS
 R 4 - 1
 18" x 24"

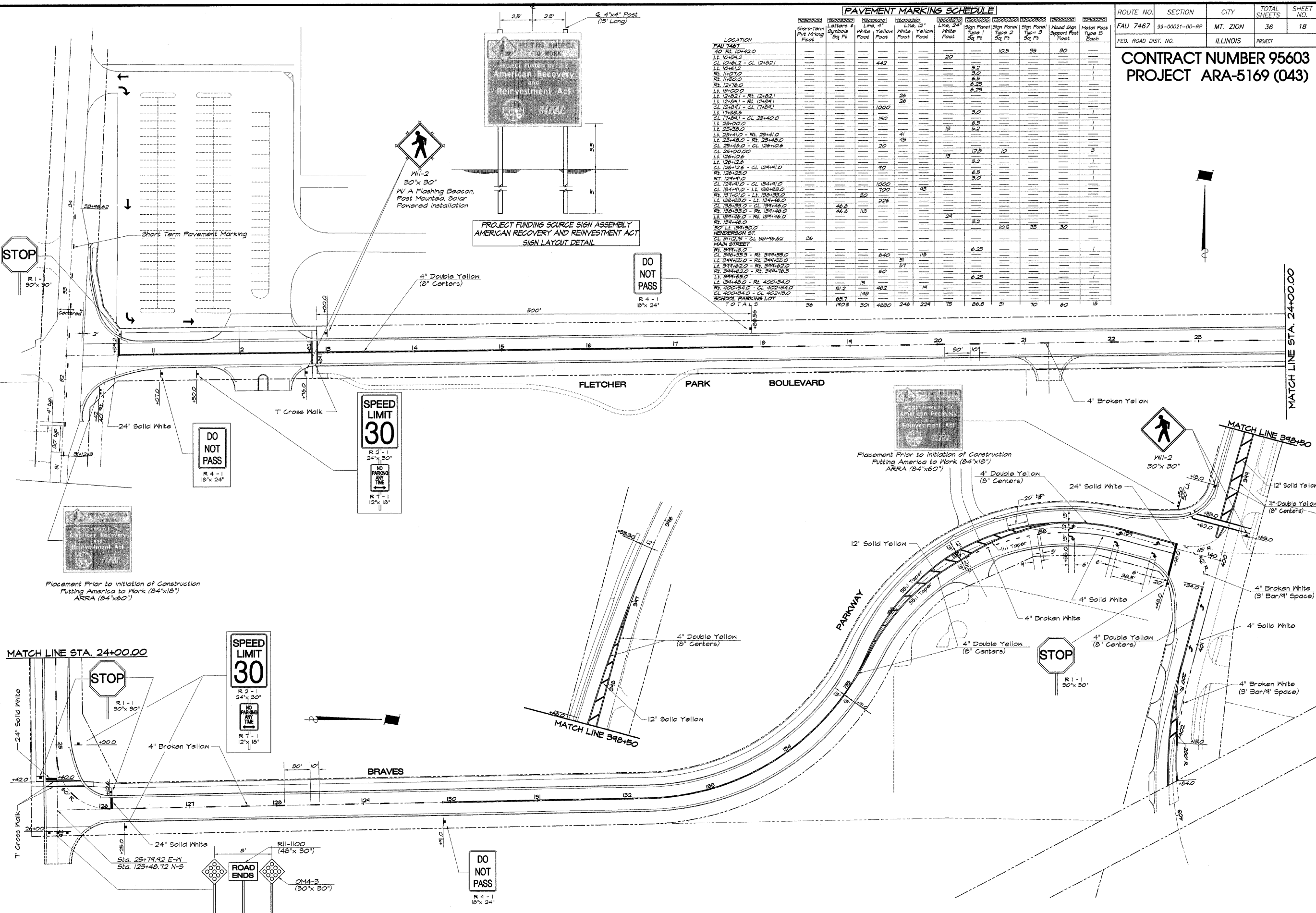

MATCH LINE STA. 24+00.00

MATCH LINE STA. 24+00.00

MATCH LINE 348+50

MATCH LINE 348+50

Placement Prior to Initiation of Construction
 Putting America to Work (84"x18")
 ARRA (84"x80")

Placement Prior to Initiation of Construction
 Putting America to Work (84"x18")
 ARRA (84"x80")

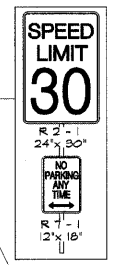

SPEED LIMIT 30
 R 2 - 1
 24" x 30"
 NO PARKING ANY TIME
 R 7 - 1
 12" x 18"



DO NOT PASS
 R 4 - 1
 18" x 24"



ROAD ENDS
 R11-1100
 (48" x 30")
 OM4-5
 (30" x 30")