

F.A.U. RTE.	SECTION	COUNTY	TOTAL SHEETS	SHEET NO.
9167	05-00207-00-PV	ST. CLAIR	89	40
STA. 90+00		TO STA. 102+00		
PAVEMENT MARKING PLAN - IL RTE 13				

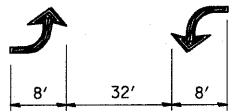

BI-DIRECTIONAL TURN ARROW DETAIL

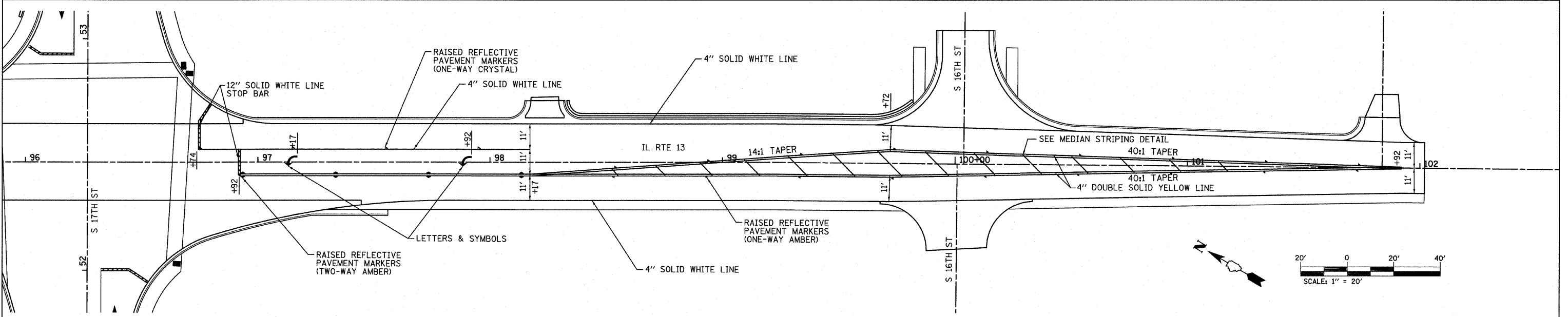
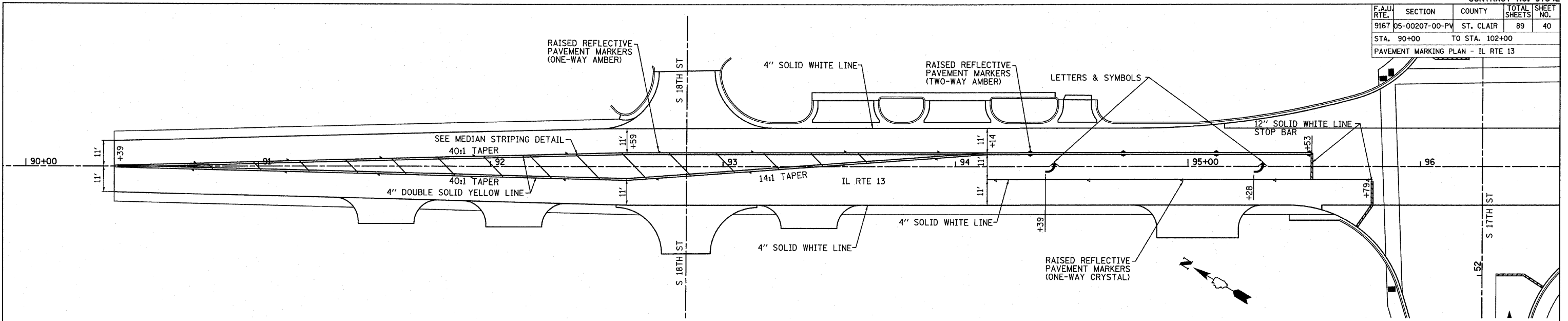
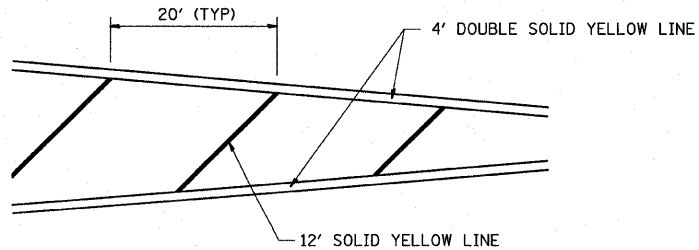

MEDIAN STRIPING DETAIL

NOTES:

- SEE HIGHWAY STANDARD 780001 FOR PAVEMENT MARKING DETAILS
- ALL PAVEMENT MARKINGS ON CONCRETE SHALL BE POLYUREA. ALL PAVEMENT MARKINGS ON HOT-MIX ASPHALT SHALL BE THERMOPLASTIC

PLOT DATE = 9/2/2009  
 FILE NAME = H:\P\24642\Microstation\8\pmp1001.dgn  
 USER NAME = 24642 / JIL  
 USER NAME = JIL