

CONTRACT NO. 97342				
F.A. RTE.	SECTION	COUNTY	TOTAL SHEETS	SHEET NO.
9167	05-00207-00-PV	ST. CLAIR	89	53
STA. 54+25.00		TO STA. 54+90.00		
FED. ROAD DIST. NO. ILLINOIS FED. AID PROJECT				

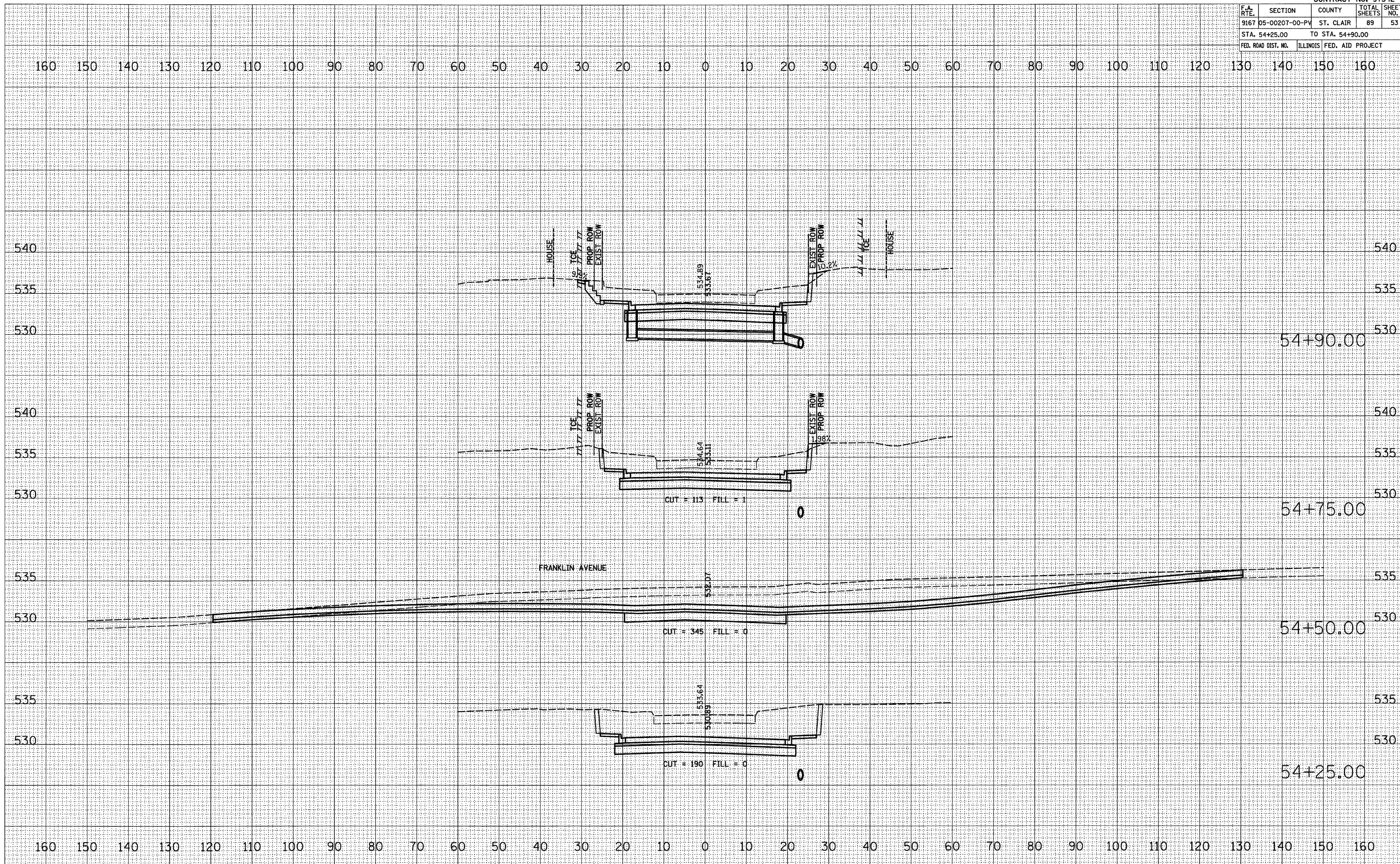

DATE
BY
SURVEYED
NOTE BOOK
AREAS CHECKED
NO.

FINAL SURVEY

DATE
BY
SURVEYED
NOTE BOOK
AREAS CHECKED
NO.

ORIGINAL SURVEY

PLOT DATE = 9/2/2009
FILE NAME = N:\A\24042\Microstation\B\sheet-1\Drawings\97342.dwg
PLOT SCALE = 1/8"=1'-0" / IN.
USER NAME = hca

S 17TH STREET CROSS SECTIONS