

STATE OF ILLINOIS
DEPARTMENT OF TRANSPORTATION

F.A.P. RTE.	SECTION	COUNTY	TOTAL SHEETS	SHEET NO.
327	14-15RS-2	CLINTON	7	1
		ILLINOIS	CONTRACT NO. 76N12	

D-98-038-20



FOR INDEX OF SHEETS, SEE SHEET NO. 2

TRAFFIC DATA	
LOCATION	US 50
2019 ADT	5250 (ACTUAL)
2044 ADT	5550 (ESTIMATED)
MU%	7.66
SU%	3.42

PROPOSED HIGHWAY PLANS

FAP ROUTE 327 (US 50)
SECTION 14-15RS-2
PROJECT NHPP-SC54(431)
MICROSURFACING - 1 PASS
CLINTON COUNTY

C-98-052-20

BRIDGE OMISSION - SN 014-0060
STA. 3315+92 TO STA. 3322+08
(616 FT)

BEGIN PROJECT
(SN 014-0058)
STA. 3215+00
LAT: 38.622763
LONG: -89.481494

END PROJECT
STA. 3519+15
LAT: 38.624903
LONG: -89.374957

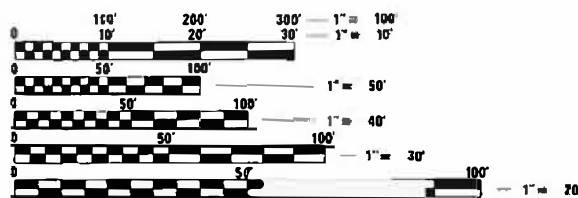

FULL SIZE PLANS HAVE BEEN PREPARED USING STANDARD ENGINEERING SCALES. REDUCED SIZED PLANS WILL NOT CONFORM TO STANDARD SCALES. IN MAKING MEASUREMENTS ON REDUCED PLANS, THE ABOVE SCALES MAY BE USED.

J.U.I.E.
JOINT UTILITY LOCATION INFORMATION FOR EXCAVATORS
1-800-892-0123
OR 811

PROJECT ENGINEER: TIFFANY BRASE (618) 346-3325
PROJECT MANAGER: RAHSHUN MILLER (618) 346-3196

CONTRACT NO. 76N12

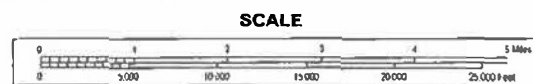
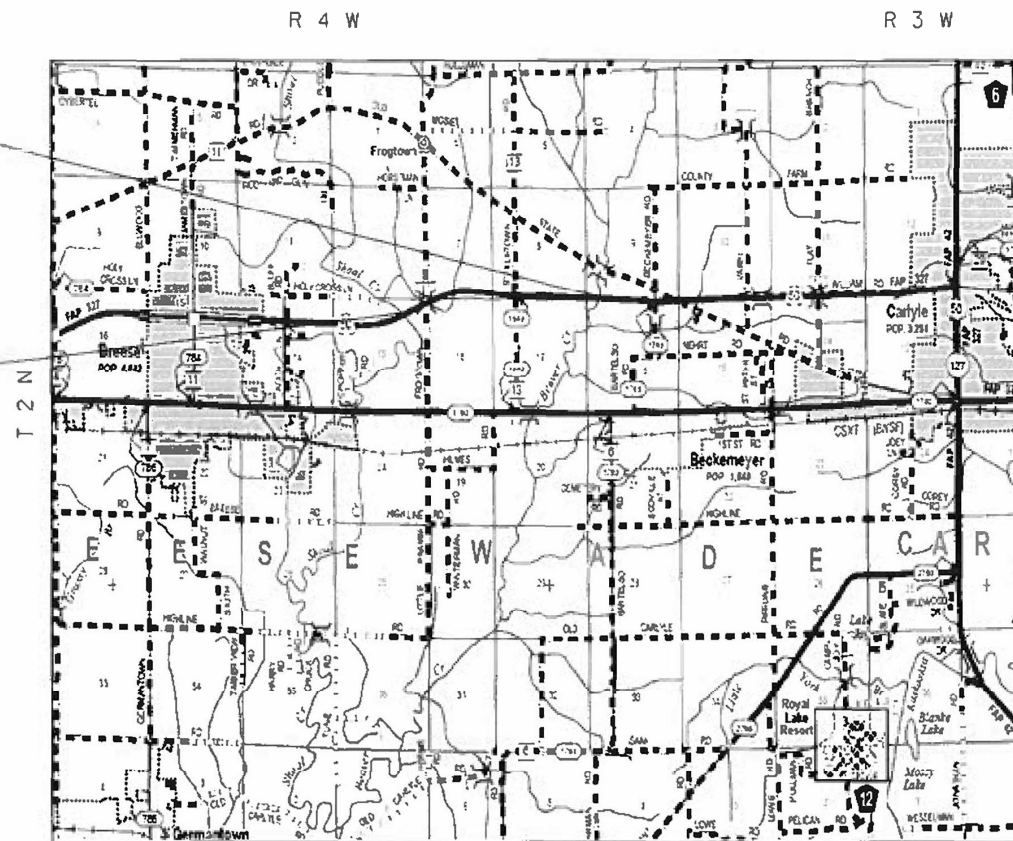

GROSS LENGTH = 30,415 FT. = 5.86 MILE
NET LENGTH = 29,799 FT. = 5.64 MILE



STATE OF ILLINOIS
DEPARTMENT OF TRANSPORTATION

SUBMITTED Aug 7 2020
Kath Roberts
REGIONAL ENGINEER

October 2, 2020
Scott A. Elk
ENGINEER OF DESIGN AND ENVIRONMENT

October 2, 2020
James J. Gu
DIRECTOR OF HIGHWAYS PROJECT IMPLEMENTATION

PRINTED BY THE AUTHORITY
OF THE STATE OF ILLINOIS

INDEX OF SHEETS

- 1 COVER SHEET
- 2 INDEX OF SHEETS, GENERAL NOTES, HIGHWAY STANDARDS, MIXTURE REQUIREMENTS & COMMITMENTS
- 3 SUMMARY OF QUANTITIES
- 4 TYPICAL SECTIONS
- 5-6 SCHEDULE OF QUANTITIES
- 7 LOCATION MAP

HIGHWAY STANDARDS

000001-07	STANDARD SYMBOLS, ABBREVIATIONS AND PATTERNS
001006	DECIMAL OF AN INCH AND OF A FOOT
701011-04	OFF-ROAD MOVING OPERATIONS, 2L, 2W DAY ONLY
701201-05	LANE CLOSURES, 2L, 2W, DAY ONLY FOR SPEEDS ≥ 45 MPH
701301-04	LANE CLOSURES, 2L, 2W, SHORT TIME OPERATIONS
701306-04	LANE CLOSURES, 2L, 2W, SLOW MOVING OPERATIONS DAY ONLY FOR SPEEDS ≥ 45 MPH
701311-03	SLOW MOVING OPERATIONS DAY ONLY
701336-07	LANE CLOSURES, 2L, 2W, WORK AREAS IN SERIES FOR SPEEDS ≥ 45 MPH
701901-08	TRAFFIC CONTROL DEVICES
780001-05	TYPICAL PAVEMENT MARKINGS
781001-04	TYPICAL APPLICATIONS RAISED REFLECTIVE PAVEMENT MARKERS

MIXTURE REQUIREMENTS

ROUTE	FAP 327 (US 50)
SECTION	14-15RS-2
COUNTIES	CLINTON
CONTRACT	76N12

DESCRIPTION	MICRO-SURFACING - 1 SINGLE PASS - US 50 FROM 0.3 MILES WEST OF FROGTOWN RD. TO 0.1 MILES WEST OF IL 127
-------------	---

ADT (CONSTRUCTION YR):	5550
MU%	7.66
SU%	3.42

	PARTIAL DEPTH PATCH
MIXTURE USE	SURFACE
AC/PG	PG 64-22
RAP % (MAX)	SEE SPECIAL PROVISION
DESIGN AIR VOIDS	4.0% @ Ndes=70
MIX COMPOSITION (GRADATION MIXTURE)	IL 9.5
FRICTION AGG	MIXTURE "D"
QUALITY MGMT PROGRAM	QC/QA

GENERAL NOTES

① UTILITIES KNOWN TO HAVE FACILITIES WITHIN THE PROJECT AREA ARE AS FOLLOWS:

	AERIAL	BURIED
*AMEREN ILLINOIS (GAS & ELECTRIC)	X	X
*AT&T ILLINOIS (COMMUNICATIONS)	X	X
*CITY OF CARLYLE (ELECTRIC)	X	X
*CITY OF CARLYLE (WATER & SANITARY SEWER)		X
*CARLYLE NORTH WATER COMPANY (WATER)		X
*CHARTER COMMUNICATIONS (CABLE TV)	X	X
*CLINTON COUNTY ELECTRIC COOPERATIVE, INC. (ELECTRIC)	X	X
*COUNTRYMARK COOPERATIVE, LLP. (PIPELINE)		X
*NATURAL GAS PIPELINE COMPANY OF AMERICA, (PIPELINE)		X

MEMBERS OF J.U.L.I.E. CALL TOLL FREE (800) 892-0123 OR 811 AND ARE INDICATED BY *. NON-J.U.L.I.E. MEMBERS MUST BE NOTIFIED INDIVIDUALLY.

- ② THE CONTRACTOR AND THE ENGINEER SHALL BE AWARE THAT NO SURVEY WAS PERFORMED FOR THIS PROJECT. THE STATIONING, TOPOGRAPHY, AND QUANTITIES SHOWN IN THE PLANS WERE CREATED USING MICROFILM AND FIELD MEASUREMENTS. ALL SHALL BE ASSUMED TO BE APPROXIMATE. THE CONTRACTOR SHALL VERIFY DIMENSIONS AND CONDITIONS IN THE FIELD PRIOR TO CONSTRUCTION AND ORDERING OF MATERIALS.
- ③ AN ESTIMATED QUANTITY OF 87,690 SQYD OF CUTTING FROM THE HOT-MIX-ASPHALT SURFACE CORRECTION OPERATION IS ANTICIPATED.
- ④ MICRO-SURFACING OVERLAY SHALL NOT FILL IN EXISTING RUMBLE STRIP IN THE SHOULDER.
- ⑤ NO OVERNIGHT LANE CLOSURES WILL BE PERMITTED.
- ⑥ THE PROPOSED PAVEMENT MARKINGS AND TEMPORARY PAVEMENT MARKINGS SHALL MATCH THE EXISTING PAVEMENT MARKINGS THROUGHOUT THE JOB AND TIE INTO THE EXISTING PAVEMENT MARKINGS AT THE END OF THE PROJECT.
- ⑦ TWO CHANGEABLE MESSAGE SIGNS SHALL BE PROVIDED ALONG US 50 TO ALERT DRIVERS OF THE ROAD CONSTRUCTION. CHANGEABLE MESSAGE SIGNS SHALL BE PLACED 14 DAYS PRIOR TO BEGINNING ANY WORK. EXACT LOCATIONS OF THE CHANGEABLE MESSAGE SIGNS SHALL BE DETERMINED BY THE ENGINEER.
- ⑧ THE RAISED REFLECTIVE PAVEMENT MARKERS SHALL NOT BE PLACED IN THE SAME LOCATION AS THEY WERE PREVIOUSLY INSTALLED.
- ⑨ PATCHING QUANTITIES HAVE BEEN PROVIDED WITH THIS CONTRACT AND SHALL BE USED AT THE DISCRETION OF THE ENGINEER. PATCHING QUANTITIES SHALL NOT EXCEED THE QUANTITY PROVIDED IN THE PLANS.

COMMITMENTS

NONE

MODEL: Default
 FILE: \\nrcs-pix\pub\room\data\illinois.gov\PIWDOT\Documents\DOT_Offices\Dir\ctc @Projects\076N12\CADD\DATA\CAD\sheet\076N12-shc-cover.dgn

USER NAME = millerraj	DESIGNED -	REVISED -	STATE OF ILLINOIS DEPARTMENT OF TRANSPORTATION	INDEX OF SHEETS, GENERAL NOTES, HIGHWAY STANDARDS, MIXTURE REQUIREMENTS & COMMITMENTS	F.A.P. RTE.	SECTION	COUNTY	TOTAL SHEETS	SHEET NO.
PLOT SCALE = 100,0000 ' / in.	DRAWN -	REVISED -			327	14-15RS-2	CLINTON	7	2
PLOT DATE = 5/19/2020	CHECKED -	REVISED -			CONTRACT NO. 76N12				
	DATE -	REVISED -			SCALE:	SHEET	OF	SHEETS	STA.
					ILLINOIS FED. AID PROJECT				

CODE NO.	ITEM	UNIT	TOTAL QUANTITY	CONSTR. CODE	
				80% FED 20% STATE	
				ROADWAY	
				0005	
				RURAL	
40400001	FIBER-MODIFIED ASPHALT CRACK SEALING	FOOT	89397		89397
40400118	MICRO-SURFACING, SINGLE PASS	SQ YD	87109		87109
40600290	BITUMINOUS MATERIALS (TACK COAT)	POUND	19600		19600
67000400	ENGINEER'S FIELD OFFICE, TYPE A	CAL MO	3		3
67100100	MOBILIZATION	L SUM	1		1
70100450	TRAFFIC CONTROL AND PROTECTION, STANDARD 701201	L SUM	1		1
70100460	TRAFFIC CONTROL AND PROTECTION, STANDARD 701306	L SUM	1		1
70100600	TRAFFIC CONTROL AND PROTECTION, STANDARD 701336	L SUM	1		1
70107025	CHANGEABLE MESSAGE SIGN	CAL DA	58		58
70300100	SHORT TERM PAVEMENT MARKING	FOOT	5960		5960
70300150	SHORT TERM PAVEMENT MARKING REMOVAL	SQ FT	1987		1987
70300210	TEMPORARY PAVEMENT MARKING LETTERS AND SYMBOLS	SQ FT	187		187
70300220	TEMPORARY PAVEMENT MARKING - LINE 4"	FOOT	84221		84221
* 78000100	THERMOPLASTIC PAVEMENT MARKING - LETTERS AND SYMBOLS	SQ FT	187		187

CODE NO.	ITEM	UNIT	TOTAL QUANTITY	CONSTR. CODE	
				80% FED 20% STATE	
				ROADWAY	
				0005	
				RURAL	
* 78000200	THERMOPLASTIC PAVEMENT MARKING - LINE 4"	FOOT	84221		84221
* 78100100	RAISED REFLECTIVE PAVEMENT MARKER	EACH	517		517
78300200	RAISED REFLECTIVE PAVEMENT MARKER REMOVAL	EACH	517		517
X0327980	PAVEMENT MARKING REMOVAL - WATER BLASTING	SQ FT	36150		36150
X4406025	PARTIAL DEPTH REMOVAL, TYPE 1, 2.5"	SQ YD	26		26
X4421000	PARTIAL DEPTH PATCHING	TON	3		3
X7030005	TEMPORARY PAVEMENT MARKING REMOVAL	SQ FT	28261		28261

* SPECIALTY ITEM

MODEL: Default
 FILE: \\nrcs-pix\pub\harron.mda\illinois.gov\PWIDOT\Documents\DOT_Offices\District_8\Projects\076N12\CADD\03a\CAD\sheet\076N12-shc-cover.dgn

USER NAME = millerraj	DESIGNED -	REVISED -
	DRAWN -	REVISED -
PLOT SCALE = 100.0000 ' / in.	CHECKED -	REVISED -
PLOT DATE = 5/19/2020	DATE -	REVISED -

**STATE OF ILLINOIS
DEPARTMENT OF TRANSPORTATION**

SUMMARY OF QUANTITIES

SCALE: NTS SHEET 1 OF SHEETS STA. TO STA.

F.A.P. RTE.	SECTION	COUNTY	TOTAL SHEETS	SHEET NO.
327	14-15R5-2	CLINTON	7	3
CONTRACT NO. 76N12				
		ILLINOIS	FED. AID PROJECT	

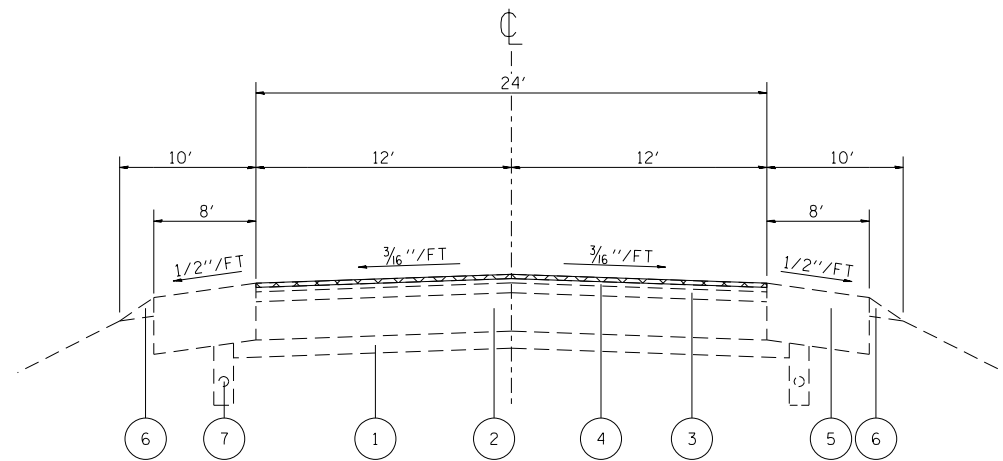

EXISTING TYPICAL SECTION

STA. 3215+00 TO STA. 3230+56.57
 STA. 3249+22.72 TO STA. 3262+00.17
 STA. 3283+00.15 TO STA. 3315+92
 *BRIDGE OMISSION STA. 3315+92 TO STA. 3322+08
 STA. 3322+08 TO STA. 3343+25.20
 STA. 3363+31.60 TO STA. 3519+15

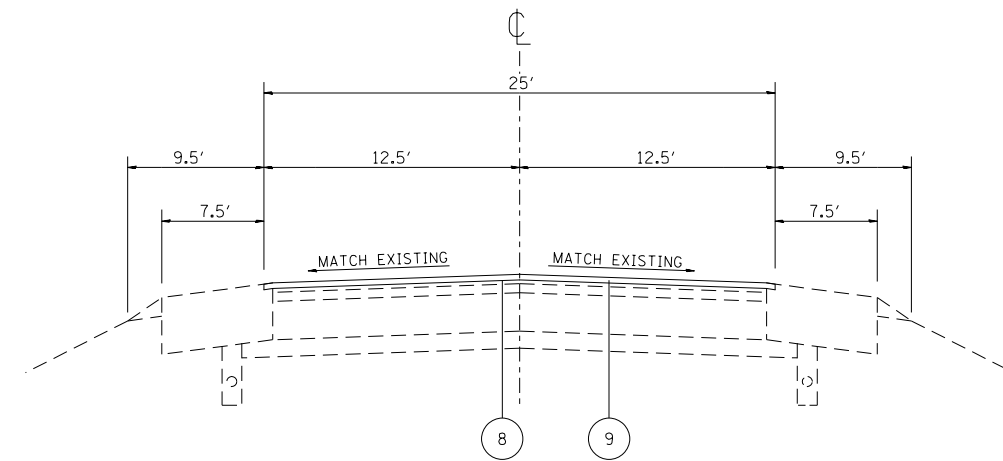

PROPOSED TYPICAL SECTION

STA. 3215+00 TO STA. 3230+56.57
 STA. 3249+22.72 TO STA. 3262+00.17
 STA. 3283+00.15 TO STA. 3315+92
 *BRIDGE OMISSION STA. 3315+92 TO STA. 3322+08
 STA. 3322+08 TO STA. 3343+25.20
 STA. 3363+31.60 TO STA. 3519+15

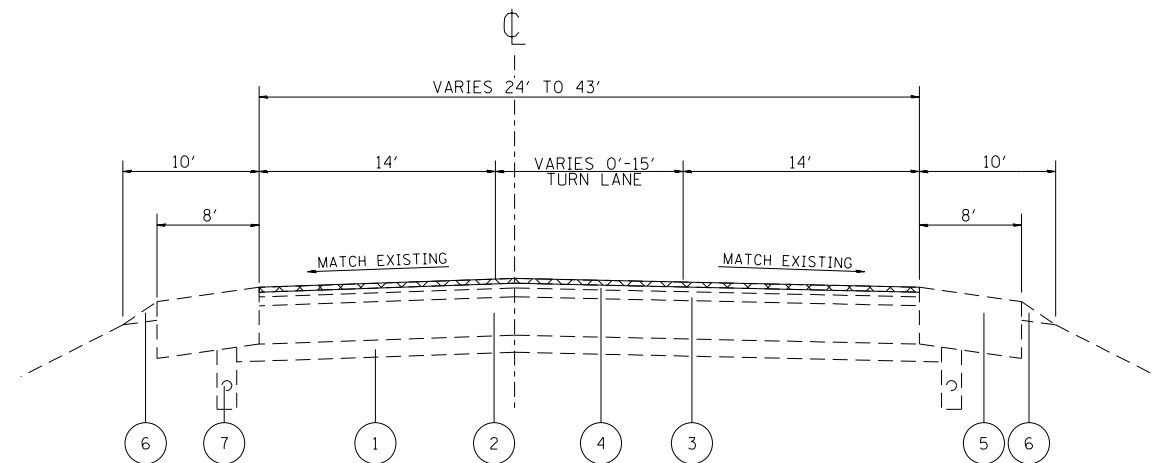

EXISTING TYPICAL SECTION

STA. 3262+00.17 TO STA. 3283+00.15
 STA. 3343+25.20 TO STA. 3363+31.60



HOT-MIX ASPHALT SURFACE CORRECTION 1/4"

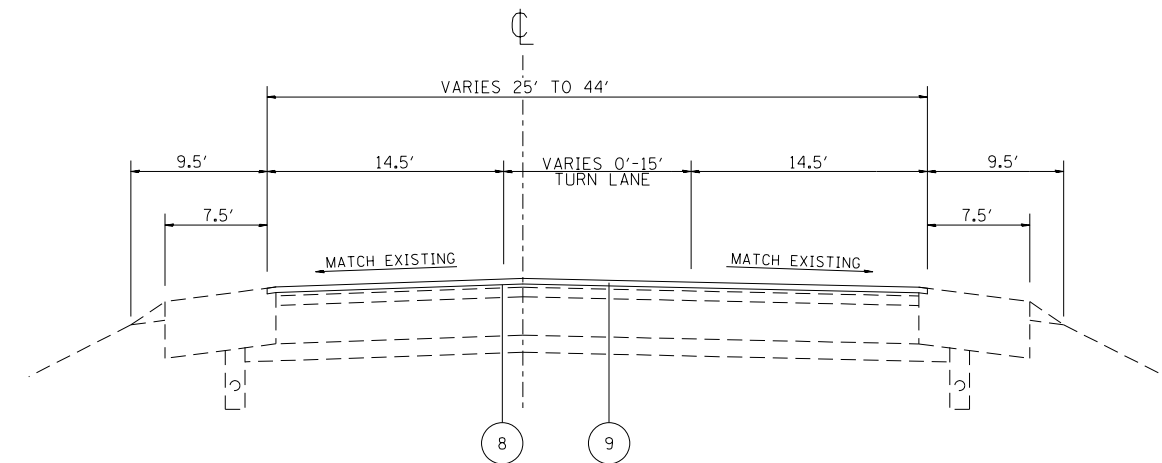

PROPOSED TYPICAL SECTION

STA. 3262+00.17 TO STA. 3283+00.15
 STA. 3343+25.20 TO STA. 3363+31.60

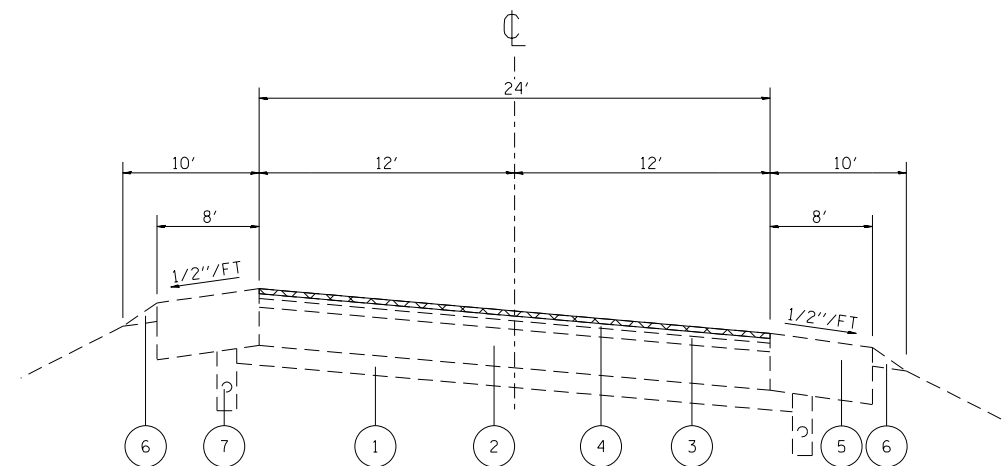

EXISTING SUPERELEVATED SECTION

STA. 3230+56.57 TO STA. 3249+22.72

LEGEND

- ① EXISTING STABILIZED SUB-BASE 4"
- ② EXISTING PCC PAVEMENT 8"
- ③ EXISTING HMA BINDER COURSE, IL 19.0, N90, 2 1/4"
- ④ EXISTING HMA SURFACE COURSE, MIX "D", N90, 1 1/2 "
- ⑤ EXISTING HMA SHOULDERS
- ⑥ EXISTING AGGREGATE SHOULDER
- ⑦ EXISTING PIPE DRAINS 4"
- ⑧ PROPOSED BITUMINOUS MATERIAL (TACK COAT)
- ⑨ PROPOSED MICRO-SURFACING SINGLE PASS

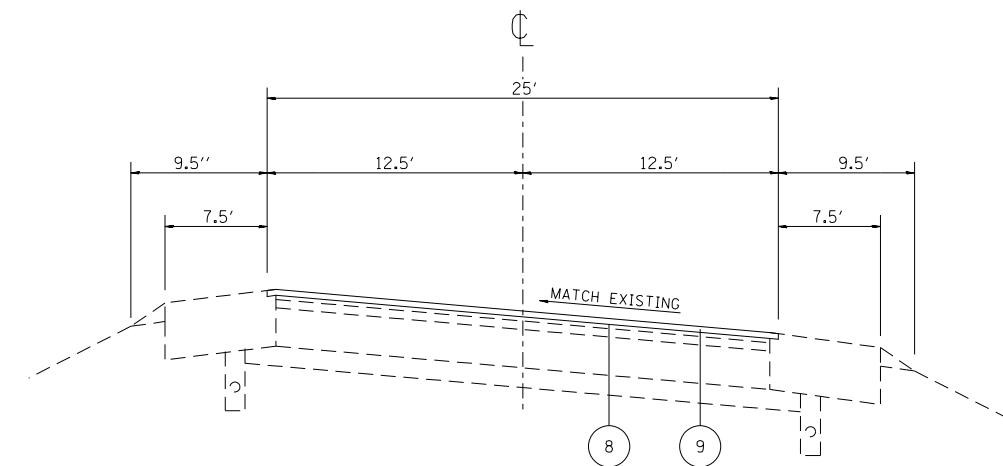

PROPOSED SUPERELEVATED SECTION

STA. 3230+56.57 TO STA. 3249+22.72

**STATE OF ILLINOIS
 DEPARTMENT OF TRANSPORTATION**

TYPICAL SECTIONS

USER NAME = millerraj	DESIGNED -	REVISED -
	DRAWN -	REVISED -
PLOT SCALE = 100.0000' / in.	CHECKED -	REVISED -
PLOT DATE = 5/12/2020	DATE -	REVISED -

SCALE: NTS	SHEET 1	OF	SHEETS	STA.	TO	STA.
------------	---------	----	--------	------	----	------

F.A.P. RTE.	SECTION	COUNTY	TOTAL SHEETS	SHEET NO.
327	14-15RS-2	CLINTON	7	4
CONTRACT NO. 76N12				
ILLINOIS FED. AID PROJECT				

MODEL: Default
 FILE: \\nrc-pixipharoom.dta\illinois.gov\PIWDOT\Documents\DOT_Offices\District 8\Projects\14-15RS-2\CADD\Drawings\14-15RS-2-shc-cover.dgn

THERMOPLASTIC PAVEMENT MARKING SCHEDULE														
STATION			LENGTH FEET	THERMOPLASTIC PAVEMENT MARKINGS 4"						PAVEMENT MARKING REMOVAL WATER BLASTING SQ FT	SHORT TERM PAVEMENT MARKING FEET	SHORT TERM PAVEMENT MARKING REMOVAL SQFT	TEMPORARY PAVEMENT MARKING REMOVAL SQFT	
				WHITE			YELLOW							
				LETTER & SYMBOLS SQFT	SOLID FEET	TURN LANE FEET	SKIP-DASH FEET	DOUBLE YELLOW FEET	NO PASSING FEET					
STA.	TO	STA.	FEET	SQFT	FEET	FEET	FEET	FEET	FEET	SQ FT	FEET	SQFT	SQFT	
3215+00	TO	3224+42	942		1884		235.5			699.4	188.4	62.8	706.5	
3224+42	TO	3234+42	1000		2000		250			742.5	200.0	66.7	750.0	
3234+42	TO	3244+42	1000		2000		250			742.5	200.0	66.7	750.0	
3244+42	TO	3254+42	1000		2000		250			742.5	200.0	66.7	750.0	
3254+42	TO	3264+42	1000		2000		207	1169	477	1271.5	200.0	66.7	1284.3	
3264+42	TO	3274+42	1000	93.6	2000	310		2709		1750	200.0	66.7	1766.6	
3274+42	TO	3284+42	1000		2000		72.8	2876	602	1831.7	200.0	66.7	1850.3	
3284+42	TO	3294+42	1000		2000		250			742.5	200.0	66.7	750.0	
3294+42	TO	3304+42	1000		2000		250			742.5	200.0	66.7	750.0	
3304+42	TO	3314+42	1000		2000		250			742.5	200.0	66.7	750.0	
3314+42	TO	3315+92	150		300		37.5			111.4	30.0	10.0	112.5	
3315+92	TO	3322+08	616	BRIDGE OMISSION										
3322+08	TO	3332+08	1000		2000		250			742.5	200.0	66.7	750	
3332+08	TO	3342+08	1000		2000		225	3924	720	2266.8	200.0	66.7	2289.7	
3342+08	TO	3352+08	1000	46.8	2000	236				784.7	200.0	66.7	792.1	
3352+08	TO	3362+08	1000	46.8	2000	235		3620	350	2094.5	200.0	66.7	2115.1	
3362+08	TO	3372+08	1000		2000		227	328		843.2	200.0	66.7	851.7	
3372+08	TO	3382+08	1000		2000		250			742.5	200.0	66.7	750	
3382+08	TO	3392+08	1000		2000		250			742.5	200.0	66.7	750	
3392+08	TO	3402+08	1000		2000		250			742.5	200.0	66.7	750	
3402+08	TO	3412+08	1000		2000		250			742.5	200.0	66.7	750	
3412+08	TO	3422+08	1000		2000		250			742.5	200.0	66.7	750	
3422+08	TO	3432+08	1000		2000		250			742.5	200.0	66.7	750	
3432+08	TO	3442+08	1000		2000		250			742.5	200.0	66.7	750	
3442+08	TO	3452+08	1000		2000		250			742.5	200.0	66.7	750	
3452+08	TO	3462+08	1000		2000		250			742.5	200.0	66.7	750	
3462+08	TO	3472+08	1000		2000		250			742.5	200.0	66.7	750	
3472+08	TO	3482+08	1000		2000		250			742.5	200.0	66.7	750	
3482+08	TO	3492+08	1000		2000		250			742.5	200.0	66.7	750	
3492+08	TO	3502+08	1000		2000		250			742.5	200.0	66.7	750	
3502+08	TO	3512+08	1000		2000		250			742.5	200.0	66.7	750	
3512+08	TO	3519+15	707		1414		84.25	728		8905	141.4	47.1	742.1	
TOTAL:				187	59598	781	6339.0	15354	2149	36150	5960	1987	28261	
					84221									

MODEL: Default
 FILE: \\nrcs\p\pub\lansroom\dat\illinois.gov\PWIDOT\Documents\DOT_Offices\Illintct\B\Projects\076N12\CADD\ataCAD\sheres\076N12-shc-cover.dgn

USER NAME = millerraj	DESIGNED -	REVISED -
	DRAWN -	REVISED -
PLOT SCALE = 100,0000 ' / in.	CHECKED -	REVISED -
PLOT DATE = 7/15/2020	DATE -	REVISED -

**STATE OF ILLINOIS
DEPARTMENT OF TRANSPORTATION**

SCHEDULE OF QUANTITIES			
SCALE: NTS	SHEET 1	OF SHEETS	STA. TO STA.

F.A.P. RTE.	SECTION	COUNTY	TOTAL SHEETS	SHEET NO.
327	14-15R5-2	CLINTON	7	5
CONTRACT NO. 76N12				
ILLINOIS FED. AID PROJECT				

RAISED REFLECTIVE PAVEMENT MARKERS									
STATION				LENGTH	AMBER		CRYSTAL	REMOVAL	
					1WAY	2WAY	1WAY		
					EACH	EACH	EACH		
3215+00	TO	3262+69	=	4769		60			60
3262+69	TO	3269+68	=	699	35				35
3269+68	TO	3271+71	=	203		5	4		9
3272+58	TO	3274+21	=	163		4	4		8
3274+21	TO	3281+51	=	730	37				37
3281+51	TO	3315+92	=	3441		43			43
3315+92	TO	3322+08	=	616	BRIDGE OMISSION				
3322+08	TO	3343+25	=	2117		26			26
3343+25	TO	3352+18	=	893	45		6		51
3352+86	TO	3361+78	=	892	45		6		51
3361+78	TO	3519+15	=	15737		197			197
TOTAL:					162	335	20	517	

PATCHING SCHEDULE					
SIDE	STATION	LENGTH	WIDTH	PARTIAL DEPTH REMOVAL, TYPE I, 2"	PARTIAL DEPTH PATCHING, 2"
		(FT)	(FT)	(SQ YD)	(TON)
EB	3215+00	3	12	4	0.4
WB	3215+00	3	12	4	0.4
EB	3315+92	3	12	4	0.4
WB	3315+92	3	12	4	0.4
EB	3322+08	3	12	4	0.4
WB	3322+08	3	12	4	0.4
SUB-TOTAL:				24	2.7
10% ANTICIPATED FAILURES:				2	0.3
TOTAL:				26	3

RESURFACING SCHEDULE						
STATION		LENGTH	WIDTH	BITUMINOUS MATERIAL (TACK COAT)	FIBER-MODIFIED ASPHALT CRACK SEALING	MICRO-SURFACING, SINGLE PASS
		FEET	FEET	POUNDS	FOOT	SQ YD
3215+00	to	3262+00	4700	25	2937.5	14100.0
3262+00	to	3283+00	2100	34.5	1811.3	6300.0
3283+00	to	3315+92	3292	25	2057.5	9876.0
3315+92	to	3322+08	616	BRIDGE OMISSION		
3322+08	to	3343+25	2117	25	1323.1	6351.0
3343+25	to	3363+31	2006	34.5	1730.2	6018.0
3363+31	to	3519+15	15584	25	9740.0	46752.0
TOTAL:				19600	89397	87109

MODEL: Default
 FILE: \\miller\c:\p1\planning\room\dat\illinois.gov\PWIDOT\Documents\IDOT_Offices\Dir\dtc_8\Projects\076N12\CADDData\CAD\sheet\076N12-shc-cover.dgn

USER NAME = millerraj	DESIGNED -	REVISED -
	DRAWN -	REVISED -
PLOT SCALE = 100.0000' / in.	CHECKED -	REVISED -
PLOT DATE = 5/12/2020	DATE -	REVISED -

**STATE OF ILLINOIS
DEPARTMENT OF TRANSPORTATION**

SCHEDULE OF QUANTITIES

SCALE: NTS SHEET 1 OF SHEETS STA. TO STA.

F.A.P. RTE.	SECTION	COUNTY	TOTAL SHEETS	SHEET NO.
327	14-15R5-2	CLINTON	7	6
CONTRACT NO. 76N12				
ILLINOIS FED. AID PROJECT				

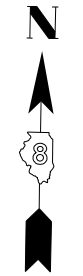
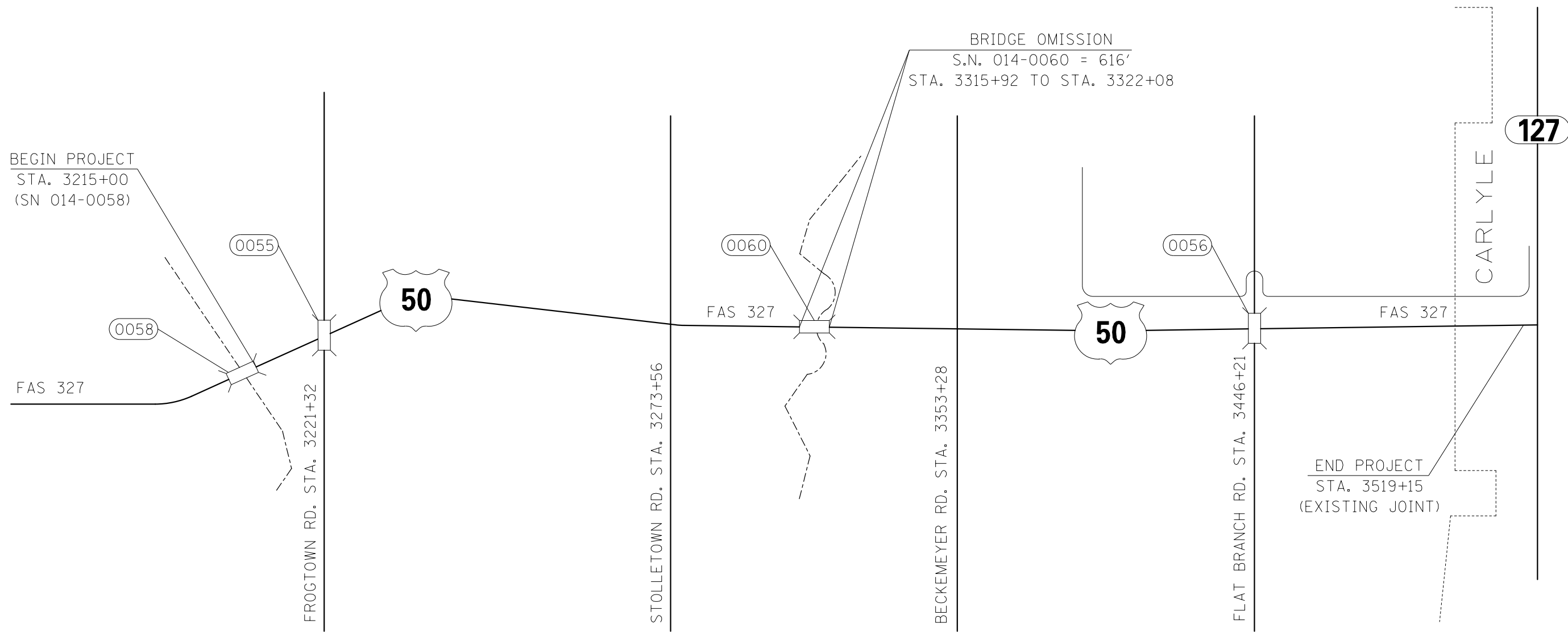

MODEL: Default
 FILE: \\nrcs-pix\uplanroom\data\illinois.gov\PIWIDOT\Documents\IDOT_Offices\District 8\Projects\076N12\CADD\data\CAD\sheet\076N12-shc-cover.dgn

USER NAME = millerraj	DESIGNED -	REVISED -
	DRAWN -	REVISED -
PLOT SCALE = 100,0000 ' / in.	CHECKED -	REVISED -
PLOT DATE = 5/12/2020	DATE -	REVISED -

**STATE OF ILLINOIS
DEPARTMENT OF TRANSPORTATION**

LOCATION MAP			
SCALE: NTS	SHEET 1	OF SHEETS	STA. TO STA.

F.A.P. RTE.	SECTION	COUNTY	TOTAL SHEETS	SHEET NO.
327	14-15R5-2	CLINTON	7	7
CONTRACT NO. 76N12				
ILLINOIS FED. AID PROJECT				