

NO.	CODE NO.	ITEM DESCRIPTION	UNIT	TOTAL QUANTITY	STP FUNDS	
					70% FED 30% DUPAGE ROADWAY URBAN 0004	70% FED 30% DUPAGE ROADWAY URBAN 0005
* 15	25200100	SODDING	SQ YD	117		117
* 16	25200110	SODDING, SALT TOLERANT	SQ YD	3,847	3,268	579
* 17	25200200	SUPPLEMENTAL WATERING	UNIT	83	56	27
** 18	28000250	TEMPORARY EROSION CONTROL SEEDING	POUND	125	112	13
** 19	28000400	PERIMETER EROSION BARRIER	FOOT	3,623	2,896	727
** 20	28000500	INLET AND PIPE PROTECTION	EACH	6	4	2
** 21	28000510	INLET FILTERS	EACH	143	34	109
** 22	28100125	STONE RIPRAP, CLASS B3	SQ YD	19	19	
** 23	30300001	AGGREGATE SUBGRADE IMPROVEMENT	CU YD	256	239	17
** 24	30300112	AGGREGATE SUBGRADE IMPROVEMENT 12"	SQ YD	1,042	1,042	
** 25	30300116	AGGREGATE SUBGRADE IMPROVEMENT 16"	SQ YD	7,676	7,177	499
** 26	30300124	AGGREGATE SUBGRADE IMPROVEMENT 24"	SQ YD	322		322
** 27	31101100	SUBBASE GRANULAR MATERIAL, TYPE B	CU YD	128	128	
** 28	31101180	SUBBASE GRANULAR MATERIAL, TYPE B 2"	SQ YD	932	234	698

* SPECIALTY ITEM
 ** SPECIAL PROVISION



KNIGHT
 Engineers & Architects

DESIGNED - D.M.S.	REVISED - ADDENDUM 1 - 10-23-2020
DRAWN - D.M.S.	REVISED -
CHECKED - D.J.C.	REVISED -
DATE - 09-01-2020	REVISED -

STATE OF ILLINOIS
 DEPARTMENT OF TRANSPORTATION

SUMMARY OF QUANTITIES

SCALE: NONE SHEET 2 OF 19 SHEETS STA. TO STA.



F.A.U. RTE.	SECTION	COUNTY	TOTAL SHEETS	SHEET NO.
1467	14-00259-05-CH	DUPAGE	294	4
CONTRACT NO. 61G12				
ILLINOIS FED. AID PROJECT				

NO.	CODE NO.	ITEM DESCRIPTION	UNIT	TOTAL QUANTITY	STP FUNDS		
					70% FED 30% DUPAGE ROADWAY URBAN 0004	70% FED 30% DUPAGE ROADWAY URBAN 0005	
*	197	88500100	INDUCTIVE LOOP DETECTOR	EACH	13	13	
** *	198	88600100	DETECTOR LOOP, TYPE I	FOOT	1,734	1,734	
** *	199	88700090	CONFIRMATION BEACON	EACH	7	7	
** *	200	88700200	LIGHT DETECTOR	EACH	10	10	
** *	201	88700300	LIGHT DETECTOR AMPLIFIER	EACH	3	3	
** *	202	89000100	TEMPORARY TRAFFIC SIGNAL INSTALLATION	EACH	3	3	
** *	203	89502210	MODIFY EXISTING CONTROLLER CABINET	EACH	4	4	
*	204	89502300	REMOVE ELECTRIC CABLE FROM CONDUIT	FOOT	5,280	5,280	
** *	205	89502375	REMOVE EXISTING TRAFFIC SIGNAL EQUIPMENT	EACH	8	8	
*	206	89502380	REMOVE EXISTING HANDHOLE	EACH	32	32	
** *	207	89502382	REMOVE EXISTING DOUBLE HANDHOLE	EACH	1	1	
*	208	89502385	REMOVE EXISTING CONCRETE FOUNDATION	EACH	23	23	
** *	209	Z0004562	COMBINATION CONCRETE CURB AND GUTTER REMOVAL AND REPLACEMENT	FOOT	4,069	119	3,950
** *	210	Z0005216	HOT-MIX ASPHALT STABILIZATION 6" AT STEEL PLATE BEAM GUARD RAIL	SQ YD	35	35	



* SPECIALTY ITEM
 ** SPECIAL PROVISION

LEGEND:

-  PAVEMENT WIDENING AREA
-  SHOULDER WIDENING AREA

* PATH SHUTDOWN AT RAMP C:

THE CONTRACTOR SHALL NOTIFY DUPAGE COUNTY 72 HOURS PRIOR TO CLOSING THE PEDESTRIAN ACCESS ACROSS RAMP C.

THE CONTRACTOR SHALL PROVIDE TEMPORARY ACCESS ACROSS RAMP C DURING THE CONSTRUCTION.

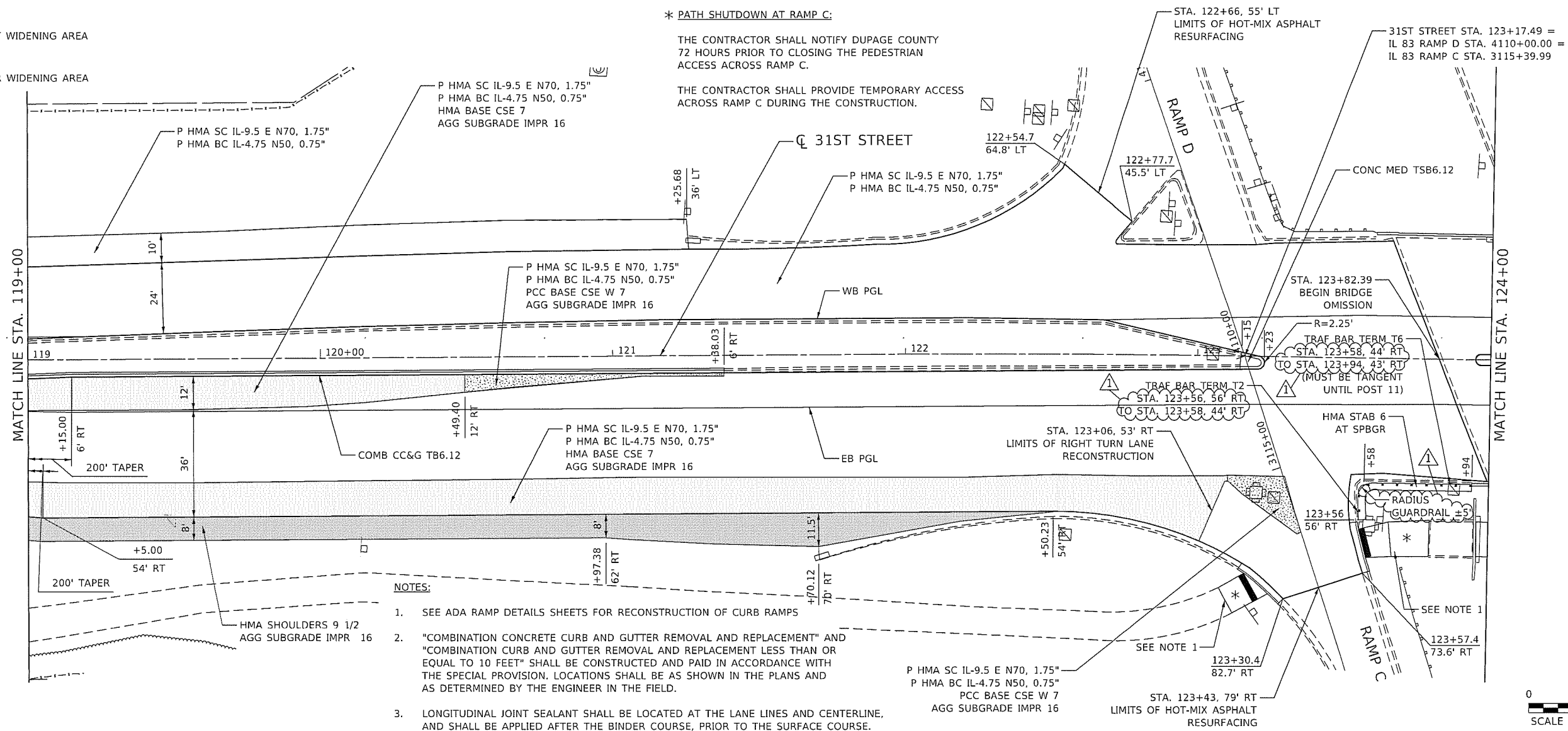

NOTES:

1. SEE ADA RAMP DETAILS SHEETS FOR RECONSTRUCTION OF CURB RAMPS
2. "COMBINATION CONCRETE CURB AND GUTTER REMOVAL AND REPLACEMENT" AND "COMBINATION CURB AND GUTTER REMOVAL AND REPLACEMENT LESS THAN OR EQUAL TO 10 FEET" SHALL BE CONSTRUCTED AND PAID IN ACCORDANCE WITH THE SPECIAL PROVISION. LOCATIONS SHALL BE AS SHOWN IN THE PLANS AND AS DETERMINED BY THE ENGINEER IN THE FIELD.
3. LONGITUDINAL JOINT SEALANT SHALL BE LOCATED AT THE LANE LINES AND CENTERLINE, AND SHALL BE APPLIED AFTER THE BINDER COURSE, PRIOR TO THE SURFACE COURSE.

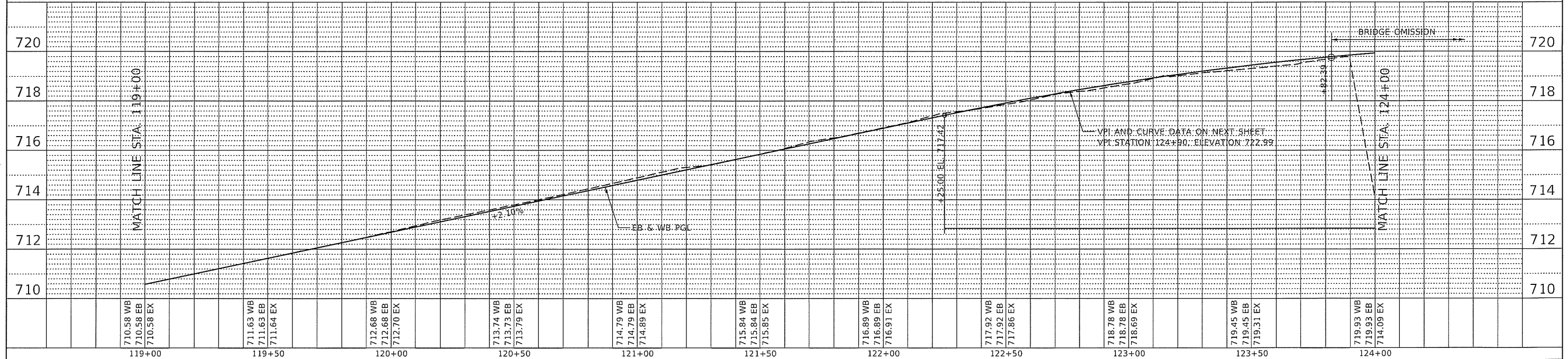
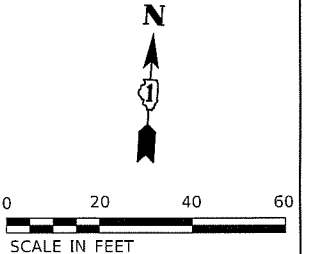

KNIGHT <small>Engineers & Architects</small>	DESIGNED - D.M.S. DRAWN - D.M.S. CHECKED - D.J.C. DATE - 09-01-2020	REVISED  ADDENDUM 1 - 10-23-2020 REVISED - REVISED - REVISED -	STATE OF ILLINOIS DEPARTMENT OF TRANSPORTATION	PROPOSED PLAN AND PROFILE 31ST STREET	F.A.U. RTE. 1467 SECTION 14-00259-05-CH COUNTY DUPAGE TOTAL SHEETS 294 SHEET NO. 75 CONTRACT NO. 61G12 ILLINOIS FED. AID PROJECT
--	--	--	---	--	--

SCALE: AS SHOWN SHEET 7 OF 16 SHEETS STA. 119+00 TO STA. 124+00

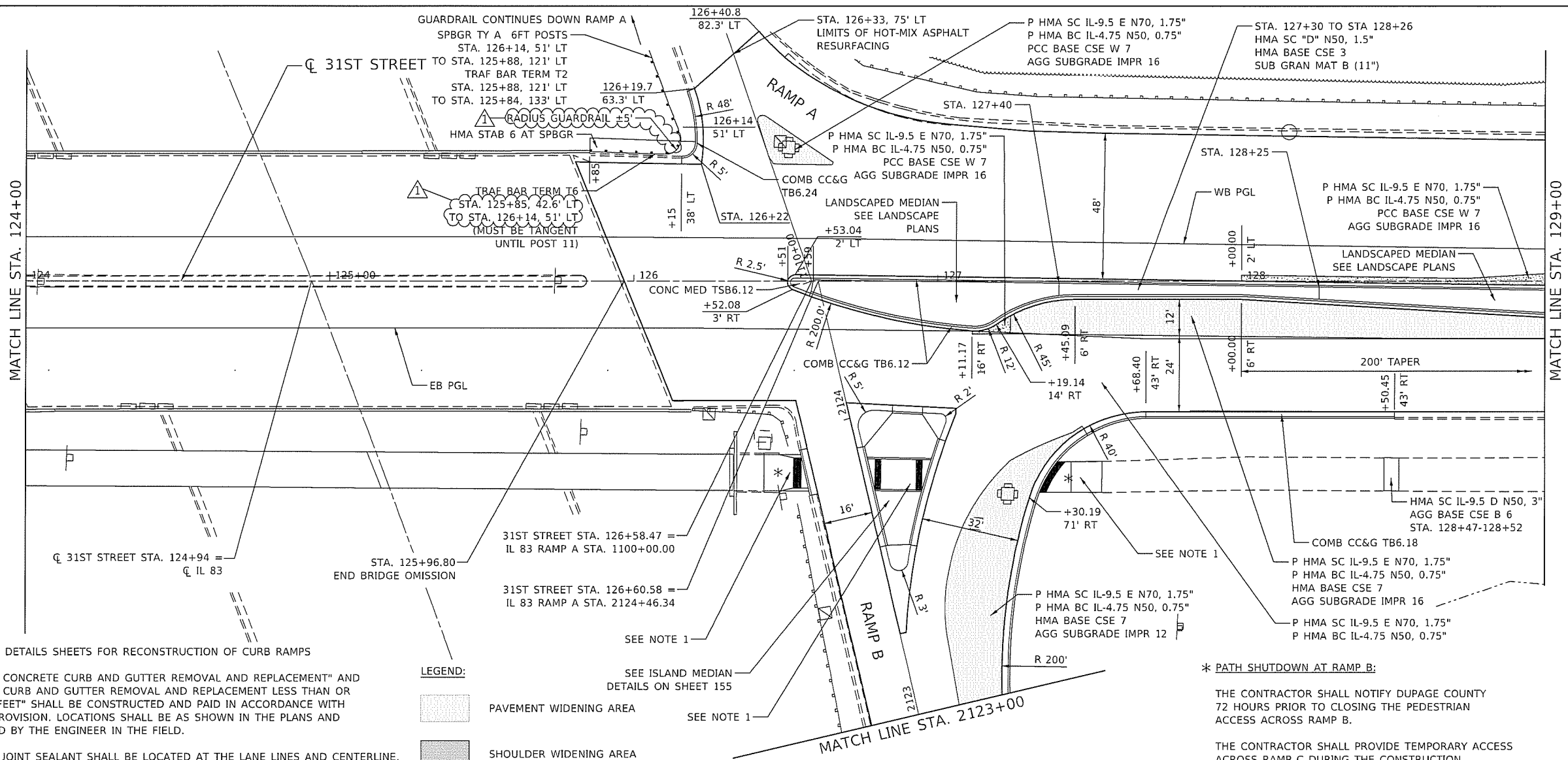

NOTES:

- SEE ADA RAMP DETAILS SHEETS FOR RECONSTRUCTION OF CURB RAMPS
- "COMBINATION CONCRETE CURB AND GUTTER REMOVAL AND REPLACEMENT" AND "COMBINATION CURB AND GUTTER REMOVAL AND REPLACEMENT LESS THAN OR EQUAL TO 10 FEET" SHALL BE CONSTRUCTED AND PAID IN ACCORDANCE WITH THE SPECIAL PROVISION. LOCATIONS SHALL BE AS SHOWN IN THE PLANS AND AS DETERMINED BY THE ENGINEER IN THE FIELD.
- LONGITUDINAL JOINT SEALANT SHALL BE LOCATED AT THE LANE LINES AND CENTERLINE, AND SHALL BE APPLIED AFTER THE BINDER COURSE, PRIOR TO THE SURFACE COURSE.

LEGEND:

- PAVEMENT WIDENING AREA
- SHOULDER WIDENING AREA

*** PATH SHUTDOWN AT RAMP B:**

THE CONTRACTOR SHALL NOTIFY DUPAGE COUNTY 72 HOURS PRIOR TO CLOSING THE PEDESTRIAN ACCESS ACROSS RAMP B.
THE CONTRACTOR SHALL PROVIDE TEMPORARY ACCESS ACROSS RAMP C DURING THE CONSTRUCTION.

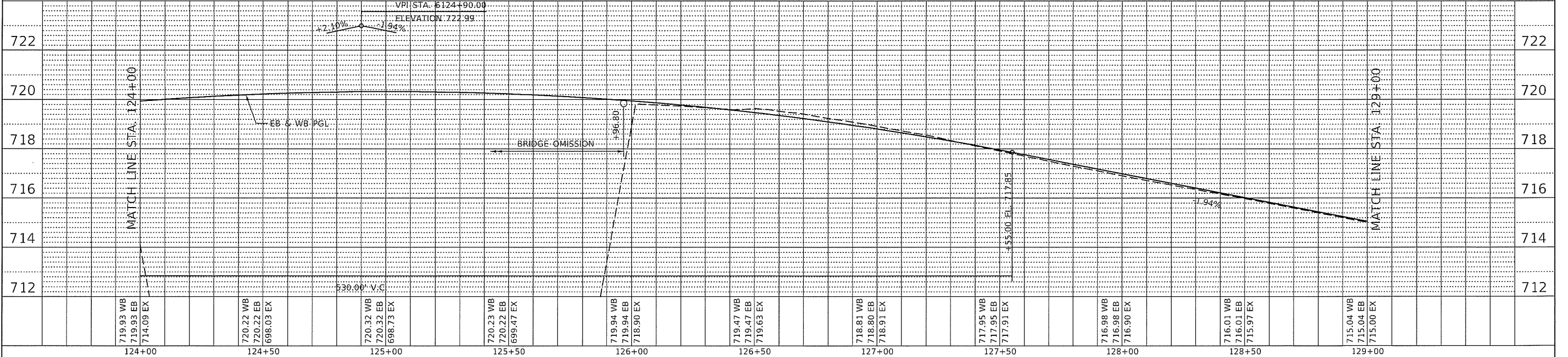
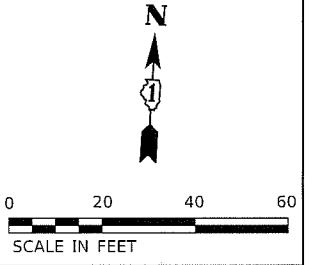

719.93 WB 719.93 EB 714.09 EX	720.22 WB 720.22 EB 698.03 EX	720.32 WB 720.32 EB 698.73 EX	720.23 WB 720.22 EB 699.47 EX	719.94 WB 719.94 EB 718.90 EX	719.47 WB 719.47 EB 719.63 EX	718.81 WB 718.80 EB 718.91 EX	717.95 WB 717.95 EB 717.91 EX	716.98 WB 716.98 EB 716.90 EX	716.01 WB 716.01 EB 715.97 EX	715.04 WB 715.04 EB 715.00 EX
124+00	124+50	125+00	125+50	126+00	126+50	127+00	127+50	128+00	128+50	129+00



DESIGNED - D.M.S.	REVISED - ADDENDUM 1 - 10-23-2020
DRAWN - D.M.S.	REVISED -
CHECKED - D.J.C.	REVISED -
DATE - 09-01-2020	REVISED -

**STATE OF ILLINOIS
DEPARTMENT OF TRANSPORTATION**

**PROPOSED PLAN AND PROFILE
31ST STREET**

SCALE: AS SHOWN SHEET 8 OF 16 SHEETS STA. 124+00 TO STA. 129+00

F.A.U. RTE. 1467	SECTION 14-00259-05-CH	COUNTY DUPAGE	TOTAL SHEETS 294	SHEET NO. 76
CONTRACT NO. 61G12			ILLINOIS FED. AID PROJECT	