

CALENDAR OF CONSTRUCTION WORK

PHASE	YEAR	WORK DATES		CONSTRUCTION WORK
		FROM	TO	
PHASE I	2009	MARCH 1	JUNE 1	INSTALLATION OF UTILITY SERVICE DROP DOWNS FOR THE SE QUADRANT AT THE CORNER GARDEN. EXCAVATION AND PLACEMENT OF POROUS GRANULAR MATERIAL, PLANTING MIX, GEOTECHNICAL FABRIC, AND MULCH (ALL CORNER GARDENS). INSTALLATION OF WATER SERVICE, IRRIGATION SYSTEMS AND ALL ASSOCIATED HARDSCAPE ITEMS FOR THE GATEWAYS AND CORNER GARDENS.
		MARCH 1	JUNE 1	INSTALLATION OF ALL WOODY PLANTS. WOODY PLANTS MUST BE CONTAINER OR DUG WHILE DORMANT AND MAINTAINED PROPERLY UNTIL PLANTED. ALL WOODY PLANTS MUST BE INSTALLED PRIOR TO PERENNIALS.
		MARCH 1	JUNE 1	INSTALL PERENNIAL PLANTS AND MULCH AFTER ALL WOODY PLANTS HAVE BEEN INSTALLED.
		JUNE 1		INTERIM COMPLETION DATE
PHASE I	2009	JUNE 1		CERTIFICATION TO THE BUREAU OF MAINTENANCE THAT ALL PLANTS HAVE BEEN INSTALLED AND ARE IN A LIVE HEALTHLY CONDITION AND ELIGIBLE FOR A SEPTEMBER PERIOD OF ESTABLISHMENT INSPECTION.
PHASE	YEAR	WORK DATES		CONSTRUCTION WORK
		FROM	TO	
PHASE II	2009	JUNE 1, 2009	MAY 1, 2010	PROVIDE PLANT CARE REQUIRED FOR ALL PLANTS (WEEDING, WATERING, OR OTHER WORK WHICH IS NECESSARY TO MAINTAIN HEALTH AND SATISFACTORY APPEARANCE OF THE GATEWAY AND CORNER GARDENS) DURING THE PERIOD OF ESTABLISHMENT AND ACCORDING TO THE LANDSCAPE MAINTENANCE SPECIAL PROVISION.
		SEPT. 1	SEPT. 30	PERIOD OF ESTABLISHMENT INSPECTION.
		OCT. 1	OCT. 31	INSTALL BULBS.
		OCT. 1	OCT. 31	FALL SHUT DOWN.
		APRIL 1	MAY 1	SPRING START UP.
PHASE II	2010	MAY 1		COMPLETION DATE
	2010	MAY 17		FINAL INSPECTION DATE

CONTRACTOR ACCESS ASSUMPTIONS

FOR THE SW QUADRANT ACCESS IS ASSUMED TO BE FROM THE FRONTAGE ROAD. THE EXISTING FENCE IS SHOWN TO BE REMOVED. THE CONTRACTOR SHALL MAINTAIN ACCESS CONTROL BY INSTALLING TEMPORARY CHAIN LINK FENCE (PORTABLE) WHILE EXISTING FENCE IS REMOVED. TEMPORARY FENCE (PORTABLE) IS INCLUDED IN THE COST OF TRAFFIC CONTROL AND PROTECTION (SPECIAL).

FOR THE SE AND NW QUADRANTS ACCESS IS ASSUMED TO BE FROM THE THE EXPRESSWAY RAMP. ACCESS FROM THE FRONTAGE ROAD IS BLOCKED BY EXISTING RETAINING WALLS. TEMPORARY EXPRESSWAY RAMP CLOSURES SHALL BE PERMITTED.

TYLINT INTERNATIONAL

QUADRANT NOMENCLATURE

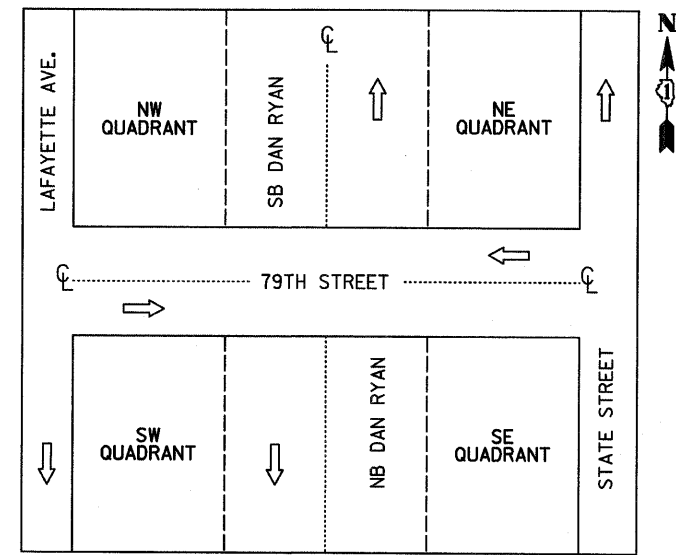

IDOT HOT-MIX ASPHALT MIXTURE REQUIREMENTS

ITEM	AC TYPE	AIR VOIDS
PAVEMENT REMOVAL AND REPLACEMENT		
HOT-MIX ASPHALT SURFACE COURSE, MIX "D", N TO 1 1/2"	PG 64-22	4% @ 70 Gyr
LEVELING BINDER (MACHINE METHOD), N TO, 1 1/2"	PG 64-22/58-22	4% @ 70 Gyr

THE UNIT WEIGHT USED TO CALCULATE ALL HMA SURFACE MIXTURE QUANTITIES IS 112/SQ YD/IN. USE 135 LB/SQ YD/IN. IF USING A SMA MIX.

WHEN RAP EXCEEDS 20%, THE NEW ASPHALT BINDER IN THE MIX SHALL BE PG 58-22.

REVISIONS	
NAME	DATE
REVISED	09/19/08

ILLINOIS DEPARTMENT OF TRANSPORTATION
F.A.I. 94 (DAN RYAN EXPRESSWAY)
CALENDAR OF CONSTRUCTION, QUADRANT NOMENCLATURE, AND HOT-MIX ASPHALT MIXTURE REQUIREMENTS

SCALE: NONE
 DATE: MAY 1, 2008

DRAWN BY: AMB
 CHECKED BY: TGB

9/19/2008 2:51:47 PM