

NOTE:
 ANY WORK NECESSARY IN ENLARGING THE OPENING TO STR. #9 TO ACCOMMODATE THE NEW 36" STORM SEWER SHALL NOT BE PAID FOR SEPARATELY, BUT WILL BE CONSIDERED AS INCLUDED IN THE CONTRACT UNIT PRICE PER LINEAR FOOT OF THE "STORM SEWER, CLASS A, TYPE 2, 36" ON THE LOCATION SPECIFIED.

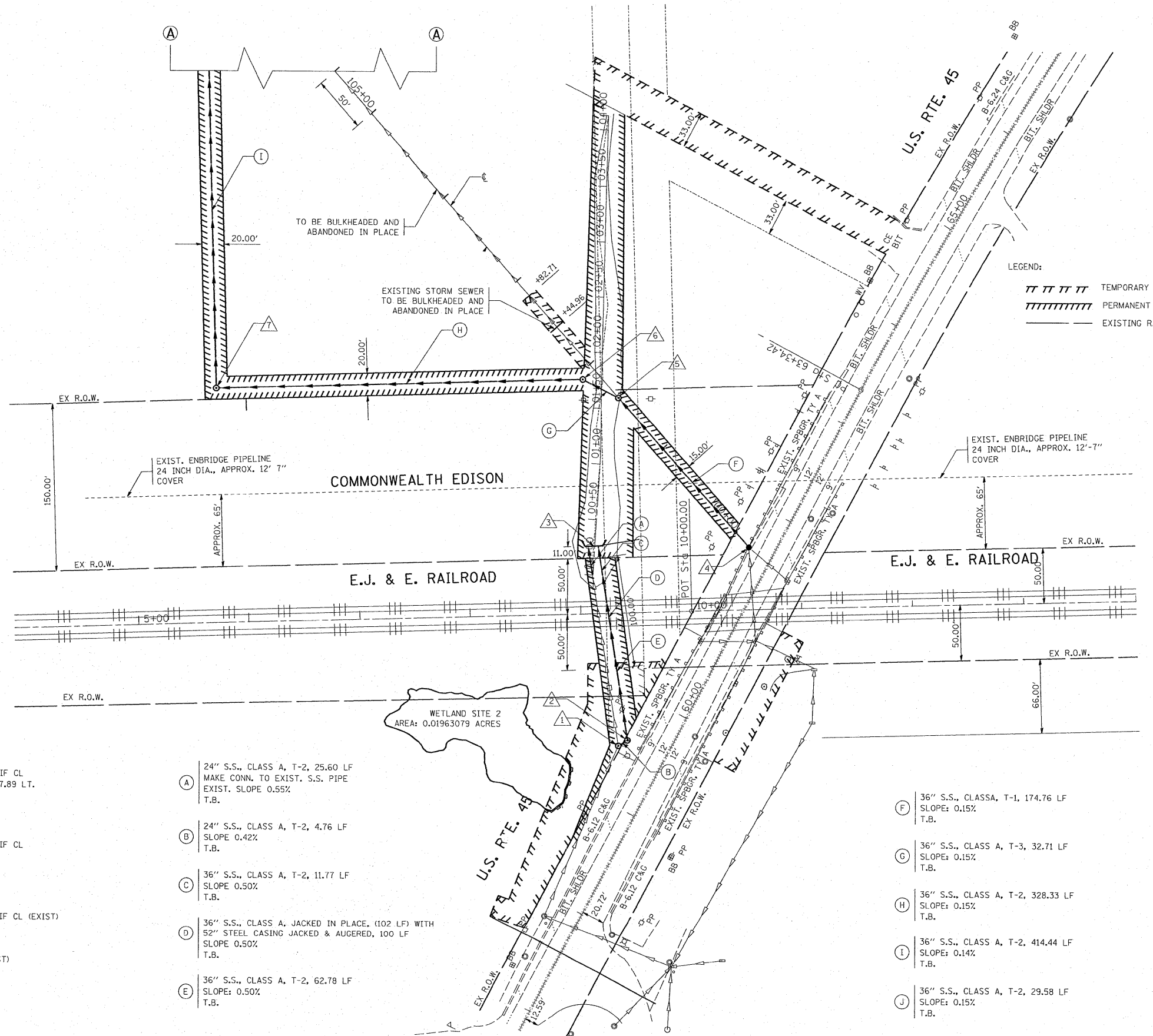

LEGEND:
 T T T T T TEMPORARY EASEMENT
 Hatched area PERMANENT EASEMENT
 Dashed line EXISTING R.O.W.



- ① MH T-A 6' DIA W/T8 G STA. 59+49.17, 42.49 LT. T.G. 763.63 (EXIST) INV. 756.83 SW (EXIST) INV. 756.73 NW (EXIST) INV. 756.73 NE
- ② MH T-A 5' DIA W/TIF CL STA. 59+57.44, 37.63 LT. T.F. 762.16 INV. 756.71 SW INV. 756.61 NW
- ③ HEADWALL STA. 60+89.46, 147.62 LT INV. 755.77 SE STA. 60+94.24, 140.08 LT INV. 755.77 SE
- ④ CB T-A 5' DIA W/T24 F&G STA. 61+61.66, 22.78 LT. T.F. 749.50 INV. 742.60 S (EXIST) INV. 742.50 NW INV. 742.60 SE (EXIST)
- ⑤ MH T-A 5' DIA W/T8 G STA. 101+60.39, C T.G. 760.42 INV. 742.24 SE INV. 742.24 NW
- ⑥ MH T-A 5' DIA W/T8 G STA. 101+93.93, 13.41 LT T.G. 758.06 INV. 742.19 SE INV. 742.09 NW
- ⑦ MH T-A 5' DIA W/TIF CL STA. 104+06.74, 267.89 LT. T.F. 754.04 INV. 741.60 E INV. 741.60 N
- ⑧ MH T-A 5' DIA W/TIF CL STA. 107+27.50, C T.F. 749.36 INV. 741.02 S INV. 740.92 NW
- ⑨ MH T-A 5' DIA W/TIF CL (EXIST) STA. 107+60.48, C T.F. 748.45 (EXIST) INV. 740.88 SE INV. 740.65 N (EXIST)
- ⑩ 24" S.S., CLASS A, T-2, 25.60 LF MAKE CONN. TO EXIST. S.S. PIPE EXIST. SLOPE 0.55% T.B.
- ⑪ 24" S.S., CLASS A, T-2, 4.76 LF SLOPE 0.42% T.B.
- ⑫ 36" S.S., CLASS A, T-2, 11.77 LF SLOPE 0.50% T.B.
- ⑬ 36" S.S., CLASS A, JACKED IN PLACE. (102 LF) WITH 52" STEEL CASING JACKED & AUGERED, 100 LF SLOPE 0.50% T.B.
- ⑭ 36" S.S., CLASS A, T-2, 62.78 LF SLOPE: 0.50% T.B.
- ⑮ 36" S.S., CLASS A, T-1, 174.76 LF SLOPE: 0.15% T.B.
- ⑯ 36" S.S., CLASS A, T-3, 32.71 LF SLOPE: 0.15% T.B.
- ⑰ 36" S.S., CLASS A, T-2, 328.33 LF SLOPE: 0.15% T.B.
- ⑱ 36" S.S., CLASS A, T-2, 414.44 LF SLOPE: 0.14% T.B.
- ⑲ 36" S.S., CLASS A, T-2, 29.58 LF SLOPE: 0.15% T.B.