

F.A.P. RTE.	SECTION	COUNTY	TOTAL SHEETS	SHEET NO.
876	9Y-RS-7	WILL	100	69
STA. 1+700		TO STA. 2+400		
FED. ROAD DIST. NO. 1 ILLINOIS FED. AID PROJECT				
CONTRACT NO. 60E52				

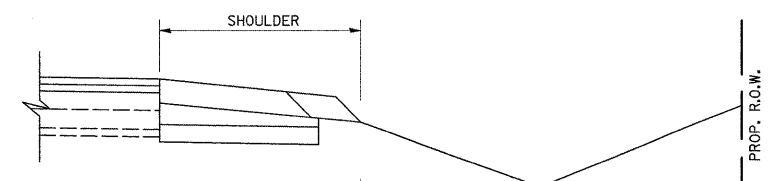
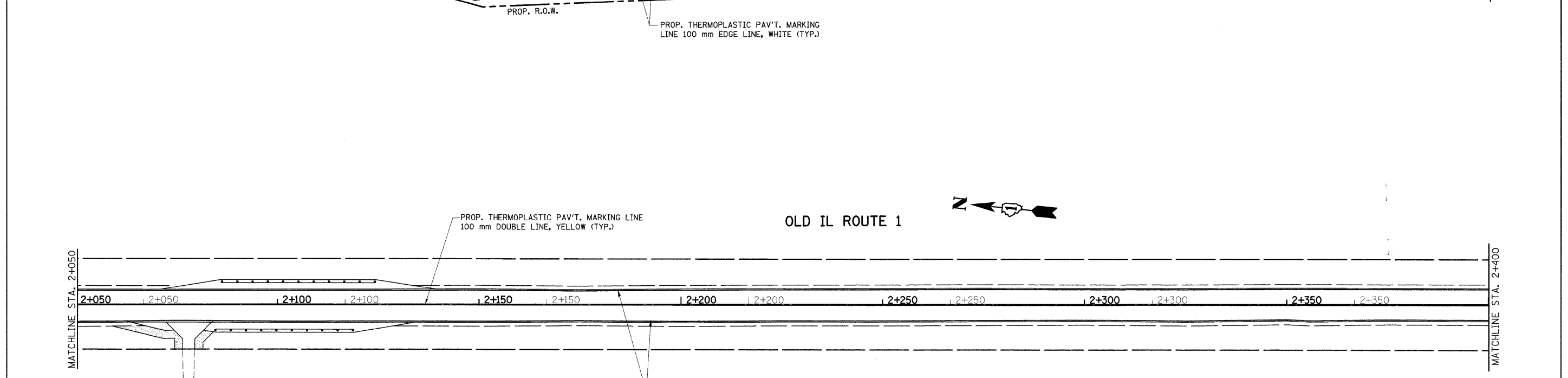
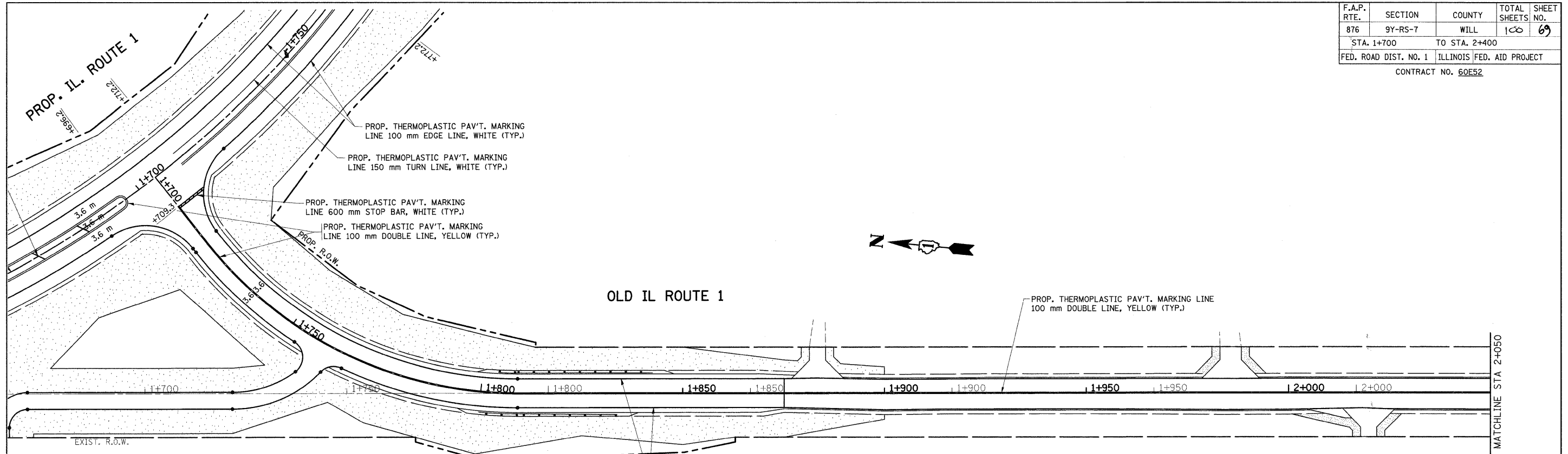

- |                                 |                                 |
|---------------------------------|---------------------------------|
| * TOPSOIL FURNISH AND PLACE, 4" | * COMPOST FURNISH AND PLACE, 4" |
| * SEEDING CL. 2A                | * SEEDING CL. 4                 |
| * EROSION CONTROL BLANKET       | * EROSION CONTROL BLANKET       |
| * NUTRIENTS                     |                                 |

**SEEDING DETAIL**  
(TYPICAL)

**LEGEND**

- SODDING SALT TOLERANT
- SEEDING CLASS 2A
- SEEDING CLASS 4
- EROSION CONTROL BLANKET (SEE SEEDING DETAIL THIS PAGE)

REVISIONS	
NAME	DATE

ILLINOIS DEPARTMENT OF TRANSPORTATION  
**IL. ROUTE 1  
PROPOSED  
LANDSCAPING AND  
PAVEMENT MARKING PLAN**

SCALE 1:500  
DATE 9/3/2008

DRAWN BY  
CHECKED BY