

EXISTING PIER 1 PLAN

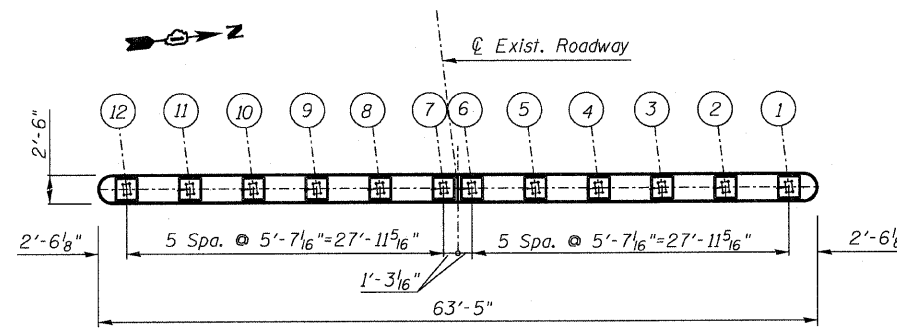

EXISTING PIER 2 PLAN

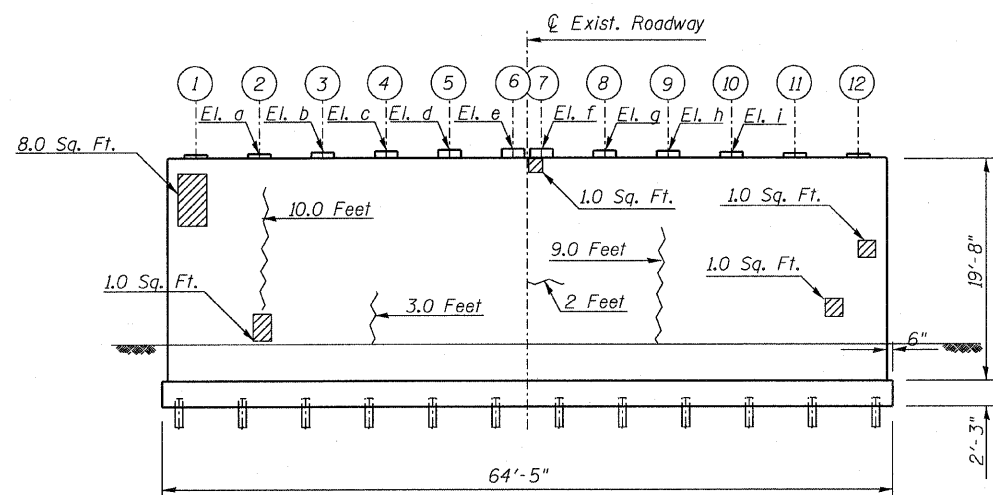

EXISTING PIER 1 ELEVATION
(Looking East)

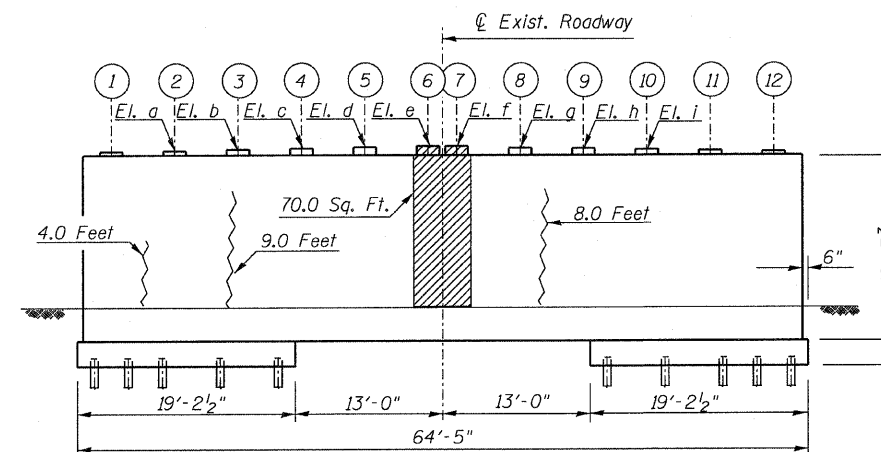

EXISTING PIER 2 ELEVATION
(Looking East)

Note:
 Quantities & locations are for information purposes only. It shall be the Contractor's responsibility to verify such dimensions & details in the field and make necessary approved adjustments prior to construction or ordering of materials. Such variations shall not be cause for additional compensation for a change in scope of the work, however, the Contractor will be paid for the quantity actually furnished at the unit price bid for the work.

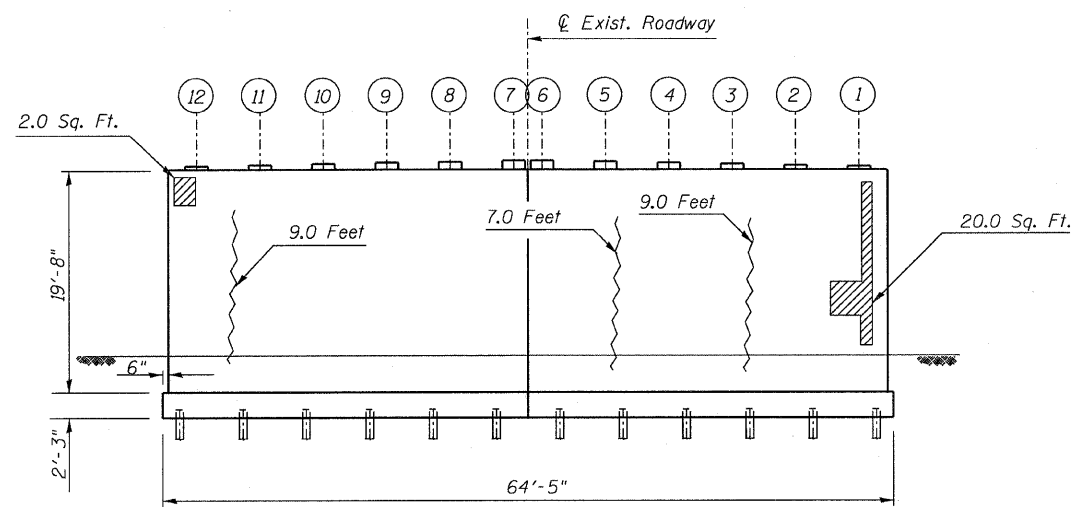

EXISTING PIER 1 ELEVATION
(Looking West)

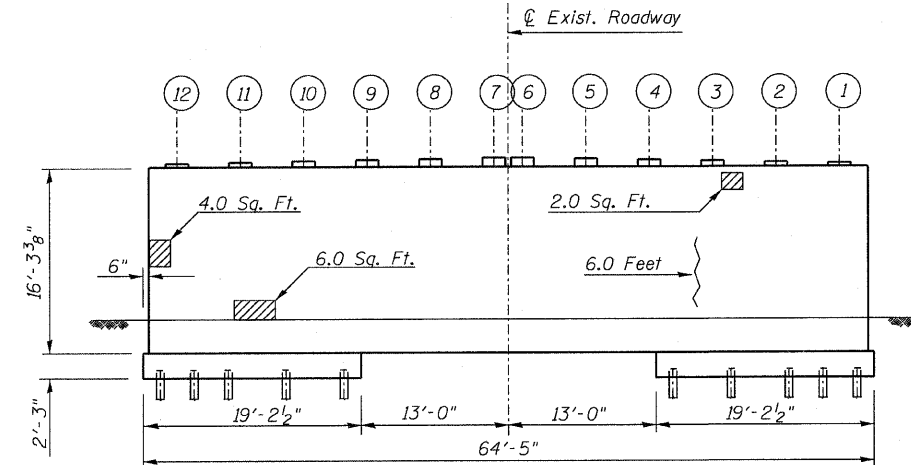

EXISTING PIER 2 ELEVATION
(Looking West)

LEGEND

- Epoxy Crack Injection
- Structural Repair of Concrete (Depth equal to or less than 5")
- Concrete Removal

BILL OF MATERIAL

Item	Unit	Total
Epoxy Crack Injection	Foot	76.0
Structural Repair of Concrete (Depth equal to or less than 5")	Sq. Ft.	116.0
Concrete Removal	Cu. Yd.	—

Location	El. a (Beam 2)	El. b (Beam 3)	El. c (Beam 4)	El. d (Beam 5)	El. e (Beam 6)	El. f (Beam 7)	El. g (Beam 8)	El. h (Beam 9)	El. i (Beam 10)
Pier 1	612.35	612.49	612.63	612.74	612.81	612.82	612.80	612.73	612.64
Pier 2	608.97	609.11	609.25	609.36	620.42	609.43	609.42	609.35	609.26

EXIST. BRG. SEAT ELEVATIONS

REVISIONS	
NAME	DATE

ILLINOIS DEPARTMENT OF TRANSPORTATION
PIER REPAIRS
 31 ST. STREET OVER KILBOURN AVE.
 F.A.U. ROUTE 1463 SECTION 159-1010.1B
 COOK COUNTY
 STATION 223+67.45
 STR. NO. 016-0872

SCALE: VERT. DATE JANUARY 2008
 HORIZ. DRAWN BY JHR
 CHECKED BY CLS