

F.A.U. RTE.	SECTION	COUNTY	TOTAL SHEETS	SHEET NO.
1346 & 2626	05-00050-00-CH	COOK/DUPAGE	94	34
STA. 10+29.61		TO STA. 14+85		
FED. ROAD DIST. NO. 7		ILLINOIS	FED. AID PROJECT M-8003(569)	

BEGIN IMPROVEMENT
STA. 10+29.61

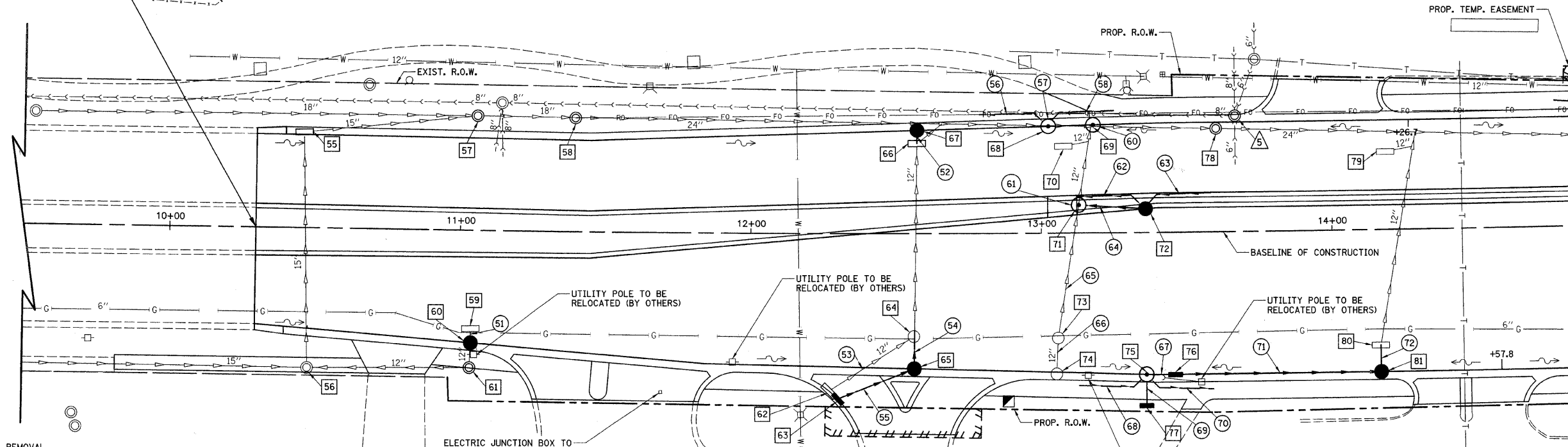

DEVON AVENUE
MATCH LINE STA. 14+85
(SEE SHEET NO. 32)

5 STA. 13+66.89, 39.7' LT. SAN. MH TO BE ADJUSTED
EX RIM = 687.05
PR RIM = 687.10

- 51 5' - 12" S.S. REMOVAL
- 52 5' - 12" S.S., CL. A, T-2 @ 0.5% T.B.F. = 1.0 CU. YD.
- 53 33' - 12" S.S. REMOVAL
- 54 13' - 12" S.S., CL. A, T-1 @ 0.5% T.B.F. = 1.8 CU. YD.
- 55 24' - 12" S.S., CL. A, T-1 @ 0.5% T.B.F. = 3.2 CU. YD.
- 56 25' - PIPE UNDERDRAIN, FABRIC LINED TRENCH 4"
- 57 5' - 24" S.S. REMOVAL
- 58 25' - PIPE UNDERDRAIN, FABRIC LINED TRENCH 4"
- 59 NOT USED
- 60 5' - 24" S.S. REMOVAL
- 61 5' - 12" S.S. REMOVAL
- 62 25' - PIPE UNDERDRAIN, FABRIC LINED TRENCH 4"
- 63 25' - PIPE UNDERDRAIN, FABRIC LINED TRENCH 4"
- 64 20' - 12" S.S., CL. A, T-2 @ 0.5% T.B.F. = 3.7 CU. YD.
- 65 FILL EXISTING STORM SEWER - 1.2 CU YD
- 66 9' - 12" S.S. REMOVAL
- 67 6' - 12" S.S., CL. A, T-1 @ 0.5% T.B.F. = 1.0 CU. YD.
- 68 25' - PIPE UNDERDRAIN, FABRIC LINED TRENCH 4"
- 69 6' - 12" S.S., CL. A, T-1 @ 0.5% T.B.F. = 1.0 CU. YD.
- 70 25' - PIPE UNDERDRAIN, FABRIC LINED TRENCH 4"
- 71 67' - 12" S.S., CL. A, T-2 @ 0.5% T.B.F. = 13.0 CU. YD.
- 72 9' - 12" S.S., CL. A, T-2 @ 0.5% T.B.F. = 2.5 CU. YD.
- 73 STA. 13+05.68, 36' RT. CB TO BE REMOVED
- 74 STA. 13+05.09, 48.0' RT. CB TO BE REMOVED
- 75 STA. 13+35.89, 48.4' RT. MH T-A, 4'-DIA. T-24 F & G RIM = 686.24 INV = 682.49 (12" N) INV = 683.38 (12" E) INV = 683.38 (4" NE & SE)
- 76 STA. 13+46.00, 48.5' RT. INLET T-B, T-24 F & G RIM = 686.25 INV = 682.46 (12" N & S)
- 77 STA. 13+35.89, 59.0' RT. INLET T-A, T-8 GRATE RIM = 686.59 INV = 683.41 (12" W)
- 78 STA. 13+60.35, 35.3' LT. MH TO BE RECONSTRUCTED EX RIM = 686.87 PR RIM = 686.71
- 79 STA. 14+18.70, 27' LT. INLET TO BE REMOVED
- 80 STA. 14+16.32, 39.5' RT. REMOVING INLET TO MAINTAIN FLOW INV = 681.83 (EX 12" W)
- 81 STA. 14+16.25, 48.5' RT. CB T-A, 4' DIA., T-24 F & G RIM = 686.64 INV = 681.87 (12" W) INV = 682.13 (12" S)
- 57 STA. 11+05.45, 39.3' LT. MH TO BE ADJUSTED EX RIM = 688.25 PR RIM = 688.97
- 58 STA. 11+39.23, 39.0' LT. MH TO BE ADJUSTED EX RIM = 688.30 PR RIM = 688.72
- 59 STA. 11+03.97, 33.6' RT. INLET TO BE REMOVED
- 60 STA. 11+03.97, 38.4' RT. CB T-A, 4' DIA., T-24 F & G RIM = 687.71 INV = 682.70 (EX 12" E)
- 61 STA. 11+03.64, 46.9' RT. MH TO BE RECONSTRUCTED EX RIM = 688.60 PR RIM = 688.21
- 62 STA. 12+27.05, 53.8' RT. INLET TO BE REMOVED
- 63 STA. 12+30, 56.4' RT. CB T-C, T-23 F&G RIM = 686.75 INV = 683.75 (12" NW)
- 64 STA. 12+56.10, 35.2' RT. REMOVING CATCH BASIN TO MAINTAIN FLOW INV = 683.15 (EX 12" W)
- 65 STA. 12+56.21, 46.1' RT. CB T-A, 4'-DIA., T-24 F & G RIM = 686.64 INV = 683.21 (12" W) INV = 683.63 (12" SE)
- 66 STA. 12+57.12, 30.8' LT. INLET TO BE ADJUSTED W/ NEW T-1 FR., C.L. EX RIM = 686.18 PR RIM = 686.68 INV = 682.56 (12" W) INV = 681.88 (EX 12" E) INV = 679.82 (EX 12" NW)
- 67 STA. 12+57.12, 35.3' LT. CB T-C, T-24 F & G RIM = 686.59 INV = 682.59 (12" E)
- 68 STA. 13+02.49, 36.6' LT. MH T-A, 5' DIA. T-24 F & G RIM = 686.42 INV = 678.76 (EX 24" N & S) INV = 682.92 (4" NW & SW)
- 69 STA. 13+18, 37' LT. MH T-A, 5' DIA. T-24 F & G RIM = 686.44 INV = 678.65 (24" N&S) INV = 679.65 (12" E)
- 70 STA. 13+07.71, 30' LT. INLET TO BE REMOVED
- 71 STA. 13+12.88, 9.6' LT. MH T-A, 4' DIA. T-1 FR., C.L. RIM = 687.10 INV = 680.12 (EX 12" E & W) INV = 682.90 (12" N)
- 72 STA. 13+35.89, 8.2' LT. CB T-C, T-23 F & G RIM = 687.00 INV = 683.00 (12" S) INV = 683.50 (4" NW & SW)

ARLINGTON HEIGHTS ROAD

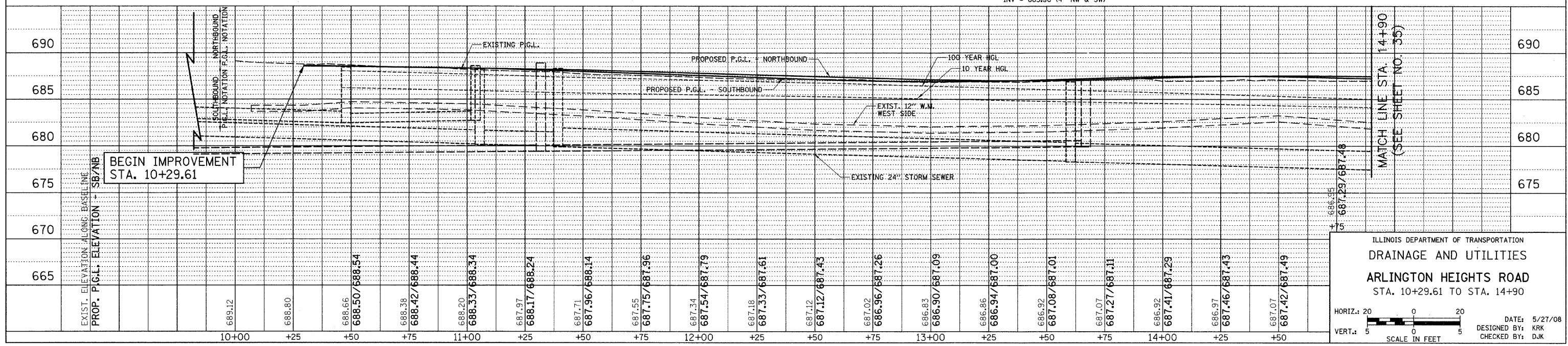

ILLINOIS DEPARTMENT OF TRANSPORTATION
DRAINAGE AND UTILITIES
ARLINGTON HEIGHTS ROAD
STA. 10+29.61 TO STA. 14+90

HORIZ.: 20
VERT.: 5

SCALE IN FEET

DATE: 5/27/08
DESIGNED BY: KRK
CHECKED BY: DJK