

F.A.U. RTE.	SECTION	COUNTY	TOTAL SHEETS	SHEET NO.
1346 & 2626	05-00050-00-CH	COOK/DUPAGE	94	55
LIGHTING PLAN				
FED. ROAD DIST. NO. 7 ILLINOIS FED. AID PROJECT N-80031569				

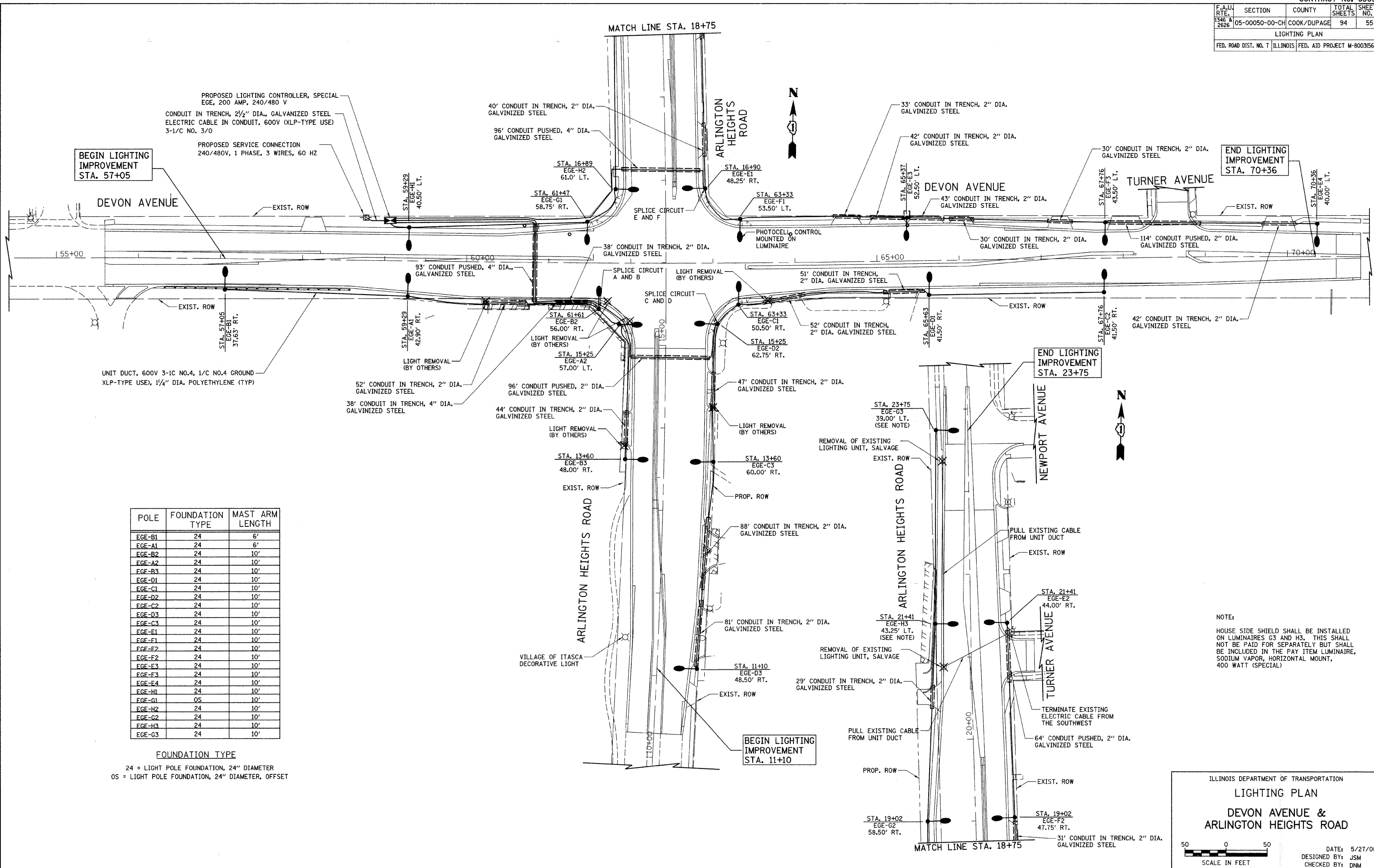

POLE	FOUNDATION TYPE	MAST ARM LENGTH
EGE-B1	24	6'
EGE-A1	24	6'
EGE-B2	24	10'
EGE-A2	24	10'
EGE-B3	24	10'
EGE-D1	24	10'
EGE-C1	24	10'
EGE-D2	24	10'
EGE-C2	24	10'
EGE-D3	24	10'
EGE-C3	24	10'
EGE-E1	24	10'
EGE-F1	24	10'
EGE-F2	24	10'
EGE-F3	24	10'
EGE-F4	24	10'
EGE-H1	24	10'
EGE-G1	05	10'
EGE-H2	24	10'
EGE-G2	24	10'
EGE-H3	24	10'
EGE-G3	24	10'

FOUNDATION TYPE
 24 = LIGHT POLE FOUNDATION, 24" DIAMETER
 05 = LIGHT POLE FOUNDATION, 24" DIAMETER, OFFSET

NOTE:
 HOUSE SIDE SHIELD SHALL BE INSTALLED ON LUMINAIRES G3 AND H3. THIS SHALL NOT BE PAID FOR SEPARATELY BUT SHALL BE INCLUDED IN THE PAY ITEM LUMINAIRE, SODIUM VAPOR, HORIZONTAL MOUNT, 400 WATT (SPECIAL)

ILLINOIS DEPARTMENT OF TRANSPORTATION
LIGHTING PLAN
DEVON AVENUE & ARLINGTON HEIGHTS ROAD

DATE: 5/27/08
 DESIGNED BY: JSM
 CHECKED BY: DNM

