

F.A.U. RTE.	SECTION	COUNTY	TOTAL SHEETS	SHEET NO.
1346 & 2626	05-00050-00-CH	COOK/DUPAGE	94	56
LIGHTING WIRING PLAN				
FED. ROAD DIST. NO. 7 ILLINOIS FED. AID PROJECT M-8003(569)				

CONTROLLER EGE CIRCUIT LOAD TABLE					
CIRCUIT	BLACK PHASE		CIRCUIT	RED PHASE	
	AMPS	WATTS		AMPS	WATTS
A	3.90	936	B	5.85	1404
C	5.85	1404	D	5.85	1404
E	7.80	1872	F	5.85	1404
G	5.85	1404	H	5.85	1404
TOTAL	23.40	5616	TOTAL	23.40	5616

400W LUMINAIRE = 1.95A

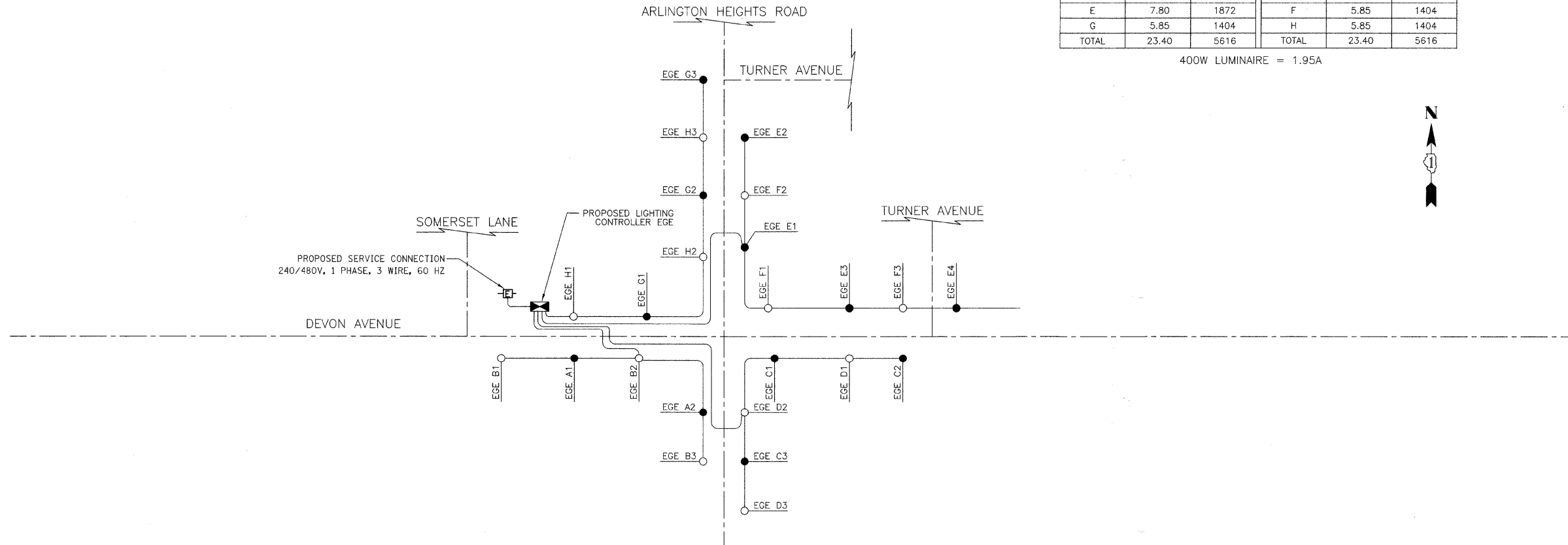

LEGEND

- LITHONIA LUMINAIRE, SODIUM VAPOR
400W, 240V ON BLACK WIRE
- LITHONIA LUMINAIRE, SODIUM VAPOR
400W, 240V ON RED WIRE
- ⊠ PROPOSED LIGHTING CONTROLLER
200 AMP, 240/480V, 1φ, 3-WIRE
- UNIT DUCT, 600V 3-1C NO.4, 1/2" NO.4
GROUND (XLP-TYPE USE), 1 1/4" DIA. POLY.

**CIRCUIT DESIGNATION SCHEME
(TYPICAL)**



ILLINOIS DEPARTMENT OF TRANSPORTATION
**LIGHTING WIRING
DIAGRAM**

DATE: 5/27/08
DESIGNED BY: JSM
CHECKED BY: DNM

NOT TO SCALE