

F. A. U. NO.	SECTION	COUNTY	TOTAL SHEETS	SHEET NO.
2906	02-00077-00-WR	COOK	073	010
STA. 51+75.85		TO STA. 60+13.77		
FED. ROAD DIST. NO. 1	ILLINOIS	FED. AID PROJECT	M-8003(596)	

CONTRACT #63061

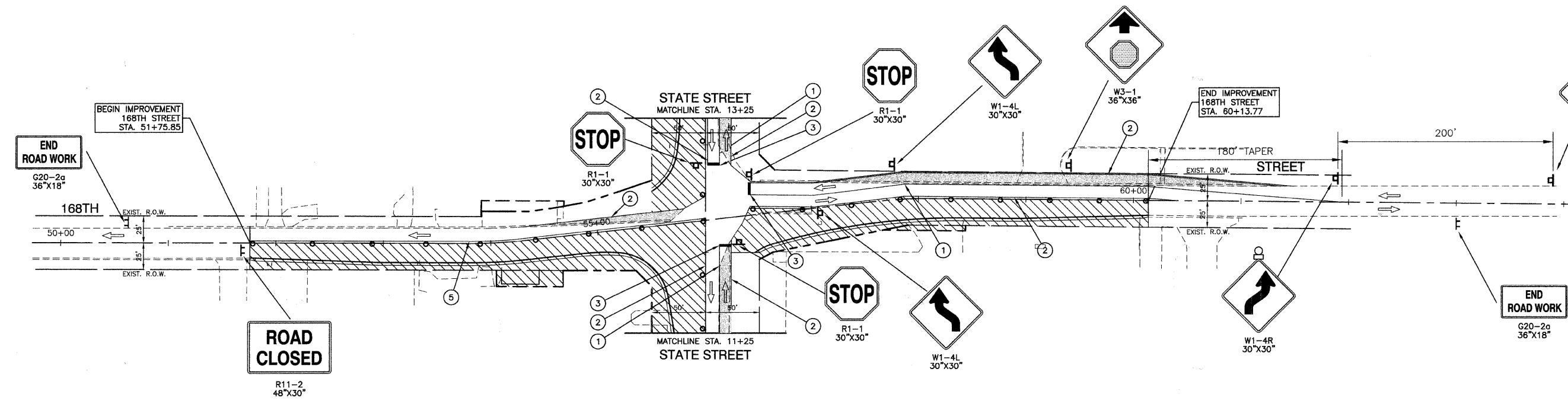
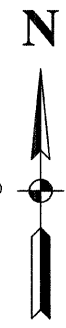

- ① DOUBLE YELLOW CENTERLINE (11" C-C) - TEMPORARY PAVEMENT MARKINGS
- ② 4" WHITE EDGE LINE - TEMPORARY PAVEMENT MARKINGS
- ③ 24" WHITE STOP BAR - TEMPORARY PAVEMENT MARKINGS
- ④ LETTERS & SYMBOLS - TEMPORARY PAVEMENT MARKINGS
- ⑤ 4" YELLOW EDGE LINE - TEMPORARY PAVEMENT MARKINGS
- ⑥ 12" WHITE DIAGONAL (30' C/C) - TEMPORARY PAVEMENT MARKINGS
- ▨ WORK AREA
- ▨ TEMPORARY PAVEMENT TO BE CONSTRUCTED
- TYPE I OR II BARRICADE OR DRUM WITH STEADY BURNING LIGHT (50' C-C)
- ⊥ TYPE III BARRICADE WITH STEADY BURNING LIGHT
- ⊠ SIGN

**NOTE:**  
 THERE ARE EXISTING 12KV OVERHEAD FACILITIES AND APPROXIMATELY 3 POLES IN CONFLICT WITH THE SUBJECT IMPROVEMENT. THE CONTRACTORS SHOULD USE CAUTION IN OPERATING CRANES OR OTHER EQUIPMENT NEAR COMED OVERHEAD FACILITIES.

REVISIONS	
NAME	DATE

**ILLINOIS DEPARTMENT OF TRANSPORTATION**

**STATE STREET AND 168TH STREET  
 INTERSECTION IMPROVEMENT  
 TRAFFIC CONTROL AND PROTECTION  
 168TH STREET STAGE 1**

SCALE: VERT. NA  
 HORIZ. 1"=50'  
 DATE 7/22/08

DRAWN BY RG  
 CHECKED BY EA/PKB