

ROUTE NO.	SECTION	COUNTY	TOTAL SHEETS	SHEET NO.
2714	07-0075-00-RP	COOK	16	8
ILLINOIS PROJECT		M-9003 (035)		
CONTRACT NO.		63070		

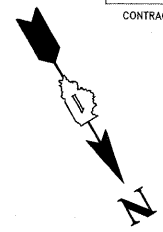

LEGEND:
 (A) DETECTABLE WARNING

NOTE:
 LOCATION & ROUTE OF PROPOSED SIDEWALK TO BE DETERMINED IN FIELD BY THE ENGINEER.

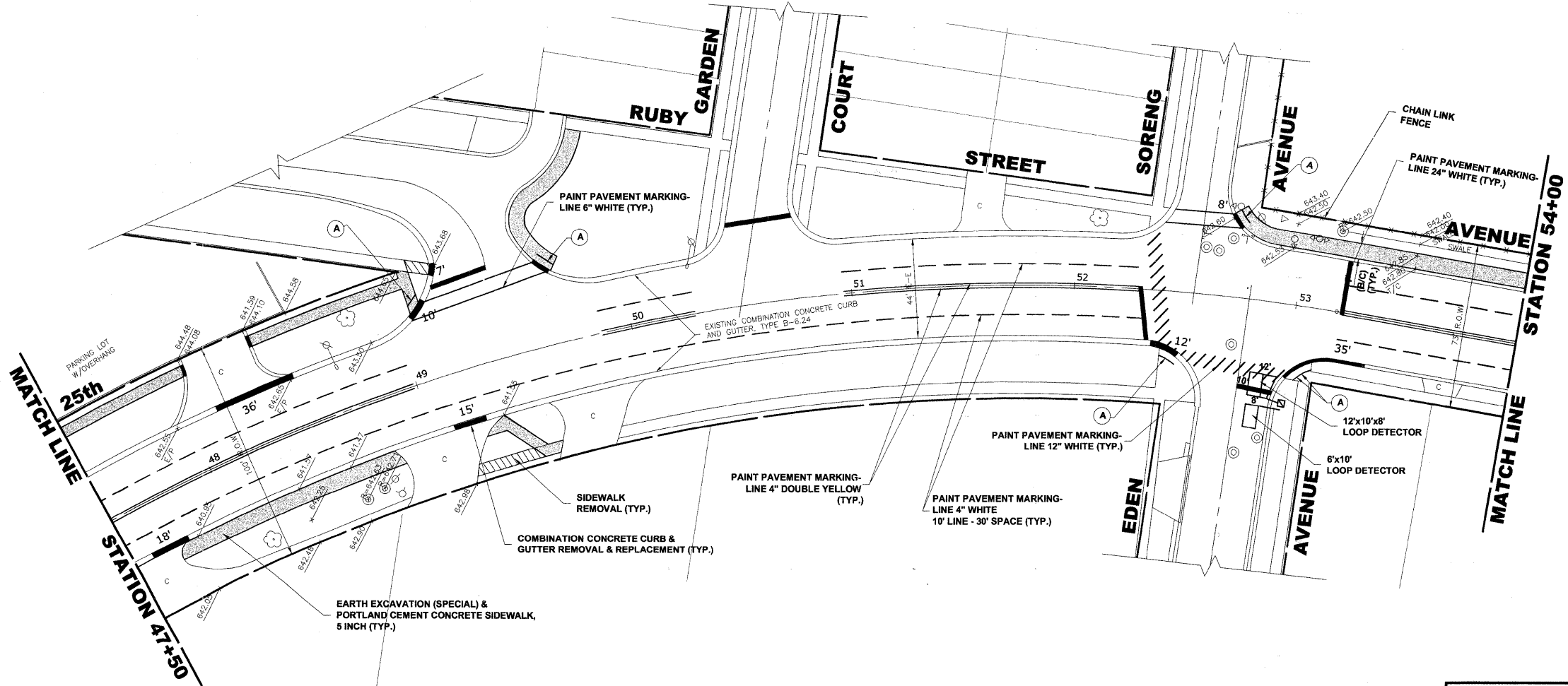
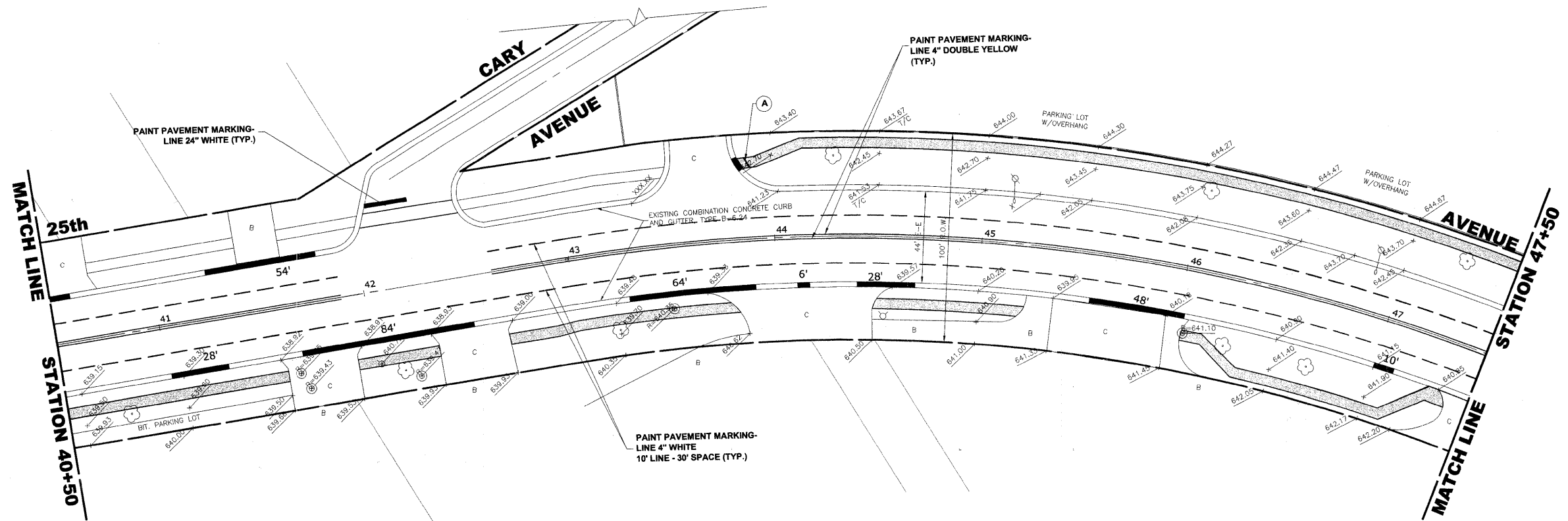

REVISION	DATE

**SCHILLER PARK
 25th AVENUE IMPROVEMENT
 (WAVELAND AVENUE TO
 LAWRENCE AVENUE)**

DRAWN BY: LEV, DMM, MK
 CHECKED BY: BP
 DATE: 7/23/2008

SCALE: 1"=30'



Civil Engineers
Municipal Consultants
Established 1911

9933 Roosevelt Road
 Westchester, Illinois 60154-2780
 Phone: 708/865-0300
 Fax: 708/865-1212