

STATE OF ILLINOIS
DEPARTMENT OF TRANSPORTATION
DIVISION OF HIGHWAYS

PLANS FOR PROPOSED
FEDERAL AID HIGHWAY

FAU 2774 / OAK PARK AVENUE
159TH STREET (FAU 0351) TO 183RD STREET (FAU 1622)
LOCAL AGENCY PAVEMENT PRESERVATION
STREET RESURFACING
PROJECT: M-9003(093)
SECTION NO.: 08-00106-00-RS
JOB NO.: C-91-035-09
VILLAGE OF TINLEY PARK
COOK COUNTY

F. A. U. RITE	SECTION	COUNTY	TOTAL SHEETS	SHEET NO.
2774	08-00106-00-RS	COOK	019	001
STA.	TO STA.			
FED. ROAD DIST. NO.	ILLINOIS	FED. AID PROJECT		

CONTRACT #63079

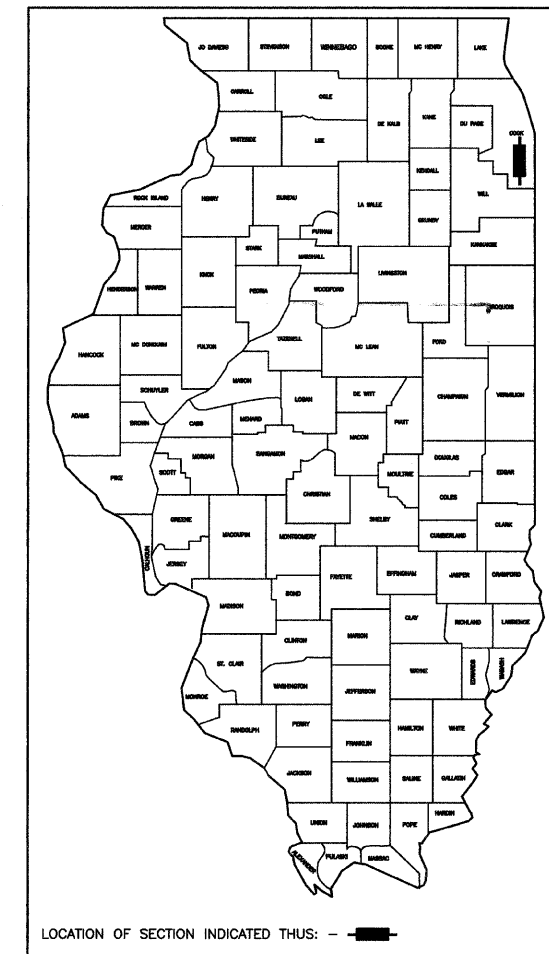

- INDEX OF SHEETS**
- 1 COVER SHEET, INDEX OF SHEETS, LOCATION MAP
 - INDEX OF STATE STANDARDS
 - 2 SUMMARY OF QUANTITIES & GENERAL NOTES
 - 3 TYPICAL CROSS SECTION
 - 4-9 PAVEMENT PLAN
 - 10-15 STRIPING PLAN
 - 16-19 DISTRICT 1 STANDARD DETAILS

- STATE STANDARDS**
- 000001-05 STANDARD STANDARDS, ABBREVIATIONS AND PATTERNS
 - 424001-05 CURB RAMPS FOR SIDEWALK
 - 442201-03 CLASS C AND D PATCHES
 - 602011 CATCH BASIN TYPE C
 - 604001-02 FRAME AND LIDS TYPE 1
 - 606001-03 CONCRETE CURB TYPE B AND COMBINATION CONCRETE CURB & GUTTER
 - 701501-04 URBAN LANE CLOSURE, 2L, 2W, UNDIVIDED
 - 701502-02 URBAN LANE CLOSURE, 2L, 2W, WITH BI-DIRECTIONAL LEFT TURN LANE
 - 701601-05 URBAN LANE CLOSURE, MULTILANE, 1W OR 2W WITH NONTRAVERSABLE MEDIAN
 - 701701-05 URBAN LANE CLOSURE, MULTILANE INTERSECTION
 - 701801-03 LANE CLOSURE, MULTILANE, 1W OR 2W, CROSSWALK OR SIDEWALK CLOSURE,
 - 701901 TRAFFIC CONTROL DEVICES
 - 780001-01 TYPICAL PAVEMENT MARKINGS
 - 886001 DETECTOR LOOP INSTALLATIONS
 - 886006 TYPICAL LAYOUT FOR DETECTION LOOPS
 - 442101-07 CLASS B PATCHES *Added 10-6-08

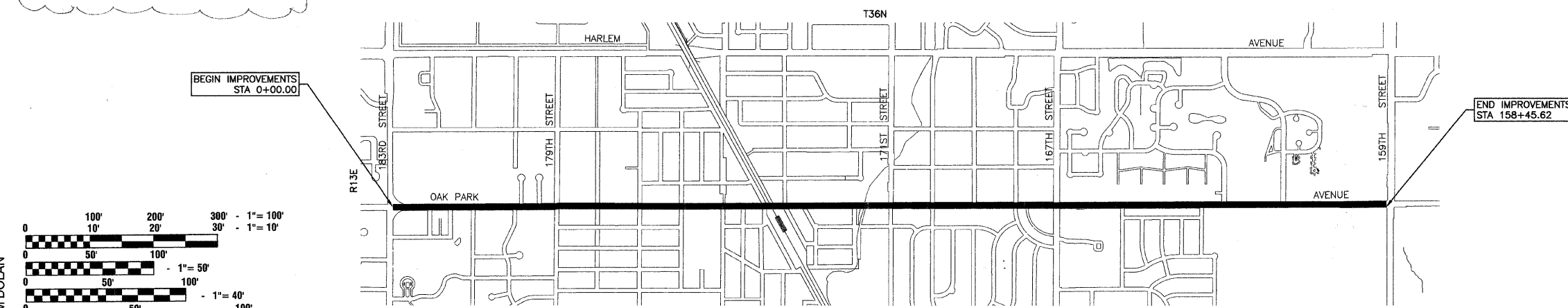
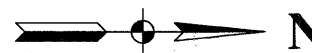

LOCATION MAP

— INDICATES PROPOSED IMPROVEMENT
GROSS LENGTH = 15,846 FEET = 3.001 MILES
NET LENGTH = 15,402 FEET = 2.917 MILES

OAK PARK AVENUE
ADT=15,000 (2008)
POSTED SPEED LIMIT - 159TH ST TO 167TH ST = 40 mph
- 167TH ST TO 179TH ST = 30 mph
- 179TH ST TO 183RD ST = 35 mph

DESIGN DESIGNATION
MINOR ARTERIAL

FULL SIZE PLANS HAVE BEEN PREPARED USING STANDARD ENGINEERING SCALES, REDUCED SIZED PLANS WILL NOT CONFORM TO STANDARD SCALES, IN MAKING MEASUREMENTS ON REDUCED PLANS, THE ABOVE SCALES MAY BE USED.

J. U. L. I. E.
JOINT UTILITY LOCATION INFORMATION FOR EXCAVATION
1-800-892-0123 or 811

CONTRACT NO. 63079

STATE OF ILLINOIS DEPARTMENT OF TRANSPORTATION
DIVISION OF HIGHWAYS

Approved: 7-30-08
Daljit Singh
Director of Public Works, Village of Tinley Park

Passed: SEPTEMBER 4, 2008
Christopher Holt
District 1 Engineer of Local Roads & Streets

Released for Bid Based on Limited Review: SEPTEMBER 5, 2008
Diana M. O'Keefe
Deputy Director of Highways, Region 1 Engineer

PRINTED BY THE AUTHORITY OF
THE STATE OF ILLINOIS

PREPARED BY OR UNDER THE
DIRECT SUPERVISION OF:

William P. Dolan
7/30/08

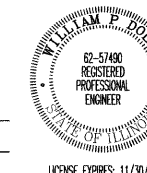

*Revised 10-6-08

I.D.O.T. FIELD ENGINEER: MELCHOR MANGOBA 847-705-4408
CONSULTANTS: ROBINSON ENGINEERING, LTD. 708-331-6700
CONTACT ENGINEER: WILLIAM DOLAN